

Location:

Key points:

- First floor flat
- Three bedrooms
- Period property
- Close to Ealing Common station
- Close to West Acton station
- Unfurnished
- Excellent amenities nearby
- Located on one of Acton's premium roads

Do Better:

Acton
lettings@astonrowe.co.uk

57-59 Churchfield Road,
Acton, London, W3 6AY

020 8992 3600

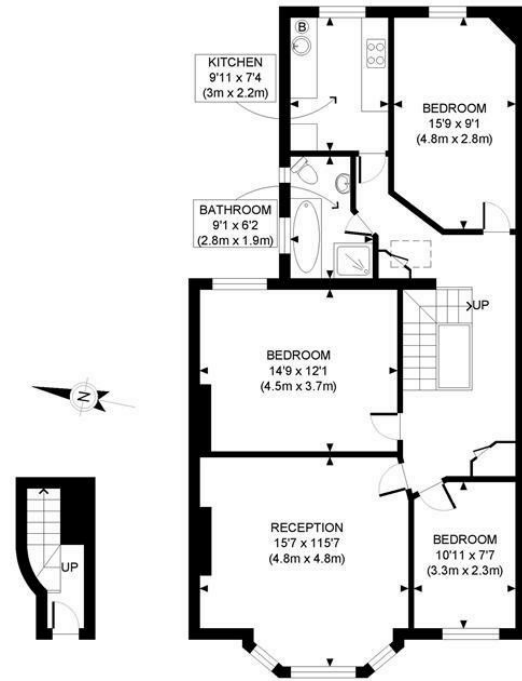

GROUND FLOOR GROSS INTERNAL FLOOR AREA 38 SQ FT
 FIRST FLOOR GROSS INTERNAL FLOOR AREA 962 SQ FT
 APPROX. GROSS INTERNAL FLOOR AREA: 1000 SQ FT/ 93 SQM

PROPERTY PHOTO PLANS.CO.UK
 ONE STOP SHOP FOR PROPERTY MARKETING

This plan is for illustrative purposes only and should be used as such by any prospective client. Whilst every attempt has been made to ensure the accuracy of the Floor Plan contained here, measurements of the doors, windows, rooms and any other items are approximate and no responsibility is taken for any errors, omissions, or misstatement. The services, systems and appliances shown have not been tested and no guarantee as to the operability or efficiency can be given.

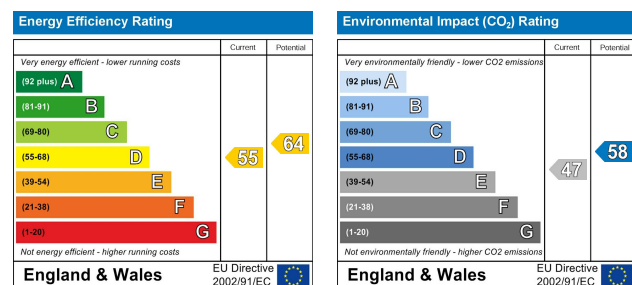

To Let: £2,500 Per Month
Twyford Avenue, W3 9QA

- 1 Reception Rooms
- 3 Bedrooms
- 1 Bathrooms



Situated in a beautiful period building on the borders of Ealing Common and Acton, this first-floor flat boasts three bedrooms. The property features a bright and spacious reception room with high ceilings throughout, along with a separate kitchen and bathroom. Twyford Avenue, renowned as one of Acton's premium roads, offers convenient access to Ealing Common (Piccadilly and District Line) and West Acton Central Line stations, both just a short walk away."

The current tenant says:
Walking distance to Ealing Common and West Acton underground stations.

What's better:
First floor three bedroom flat located on Acton and Ealing Common borders.

