



Loughborough Road, SW9

£450,000



- Private Entrance
- Victorian Conversion

- Communal Garden
- Modern Finish Throughout

- Ground Floor
- Lots of Natural Light





ABOUT THE PROPERTY

A beautifully presented two double bedroom apartment set across the ground floor of this Victorian conversion. Benefiting from its own private entrance and access to communal gardens, the apartment is beautifully finished and makes the most of its well proportioned rooms, which are flooded with natural light. The property is in excellent condition throughout and accommodation comprises two double bedrooms, a family bathroom, a separate living room and a separate kitchen.



Ideally located between Brixton and Stockwell, Loughborough Road runs between Loughborough Junction and Brixton. Residents are within easy reach of Brixton Market, renowned for its vibrant atmosphere and diverse selection of eateries, as well as the shops, bars and restaurants of nearby Acre Lane. Brixton Underground station (Victoria line) and Loughborough Junction station (Thameslink) are both within comfortable walking distance, offering excellent transport links into Central London and beyond.



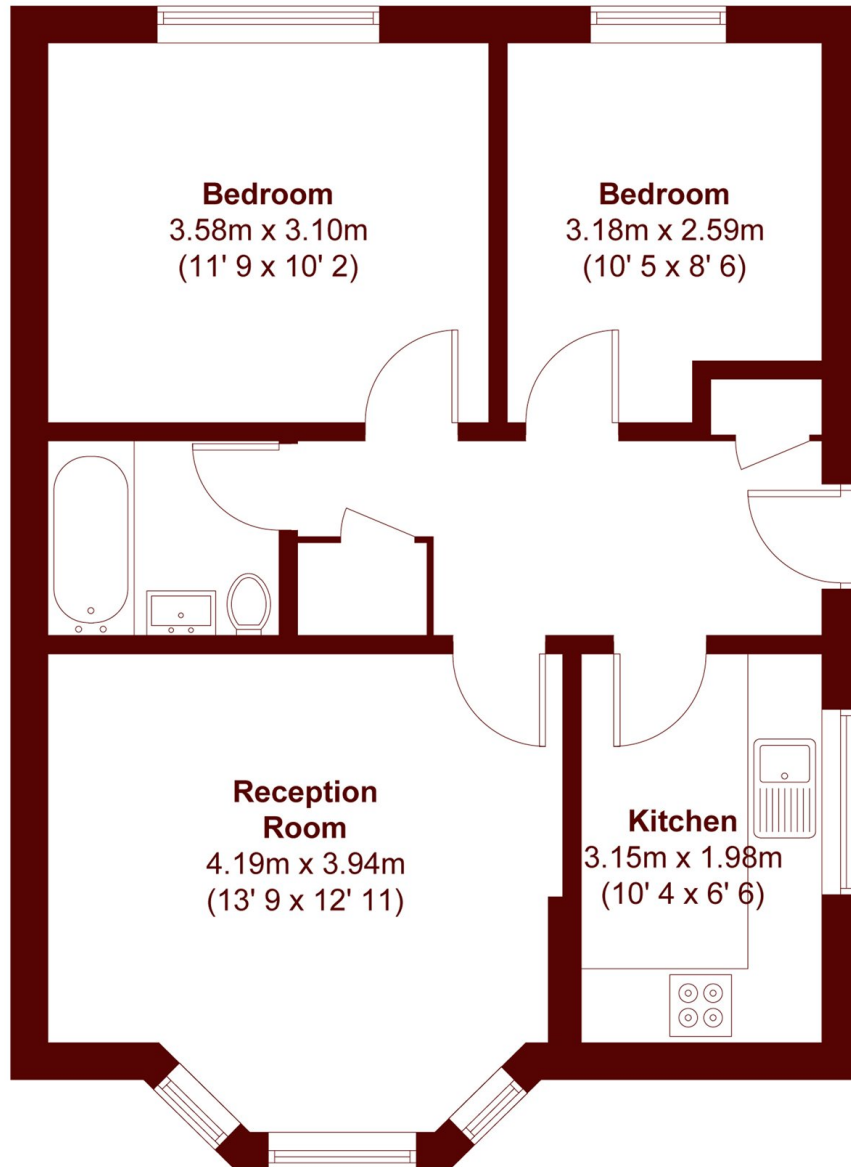

APPROX. GROSS INTERNAL FLOOR AREA
584 SQFT / 54.3 SQM

Marsh & Parsons Kennington

295 Kennington Road,
London, SE11 4QE
020 7587 1533