



Mostyn Road, SW9

£375,000



- Fourth Floor
- Balcony
- Bike Storage
- Lots of Light
- One Bedroom
- Modern Development





ABOUT THE PROPERTY

Set on the fourth floor of the Oval Quarter development, this one bedroom apartment offers fantastic light, attributed to its floor to ceiling windows, and access to a private balcony.

Located just a short walk from the beautiful Myatt's Field Park, this property is perfect for those who enjoy being surrounded by greenery and nature. With easy access to Brixton station (Victoria line), Oval station (Northern line), Loughborough Junction (Thameslink services) and Stockwell (Northern and Victoria lines) as well as a multitude of local bus services.



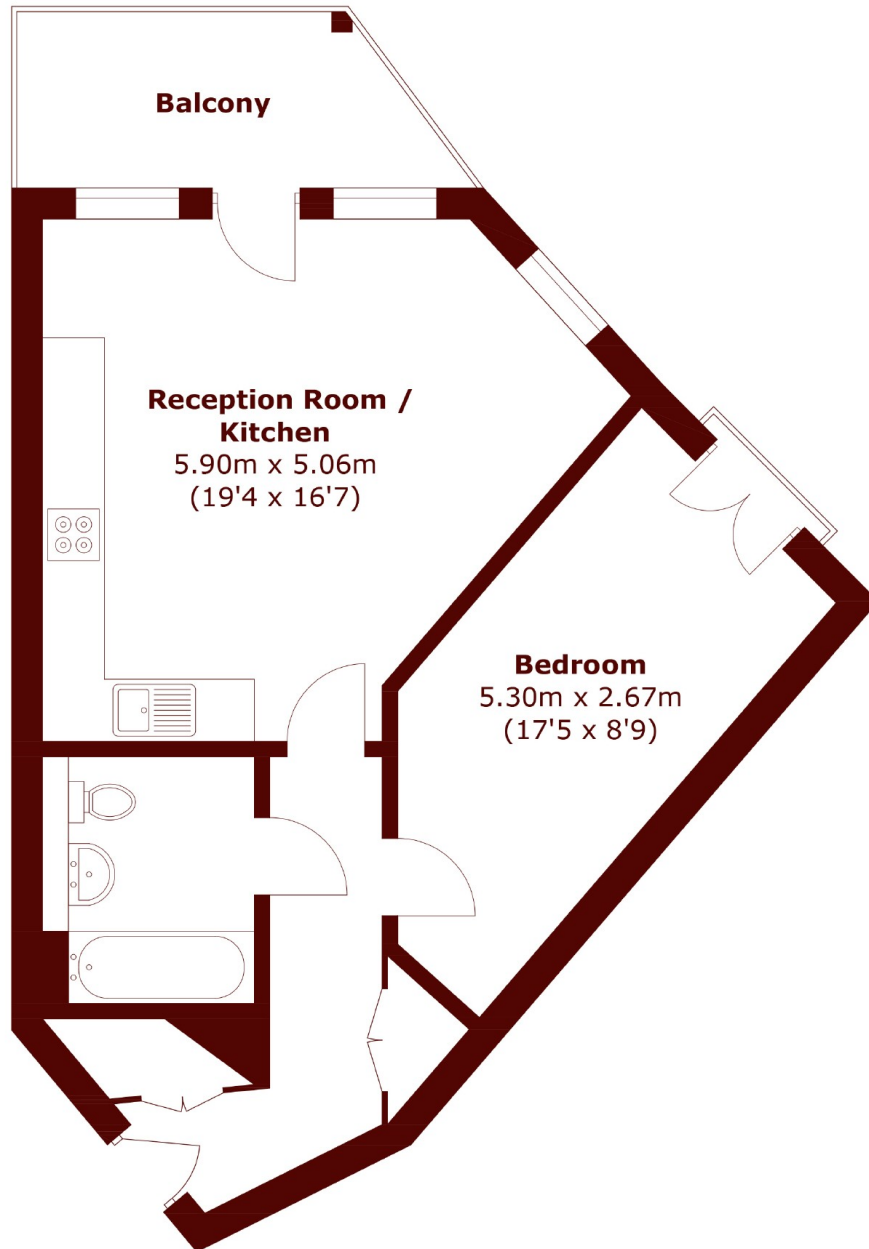

Total area (approx.): 50.8 sq. m (546.8 sq. ft)
Balcony: 6.5 sq. m (70.0 sq. ft)

Marsh & Parsons Kennington

295 Kennington Road,
London, SE11 4QE
020 7587 1533