



Charles Clowes Walk, SW11

£850,000



- 12th Floor
- Two Double Bedrooms
- Private Balcony
- Excellent Transport Links
- 24 hours Concierge
- Gym





ABOUT THE PROPERTY

Located in the heart of Nine Elms, this stylish two-bedroom apartment on the 12th floor of Haines House offers contemporary living with excellent transport links and a vibrant riverside lifestyle.

The property features a bright open-plan living area with floor-to-ceiling windows that fill the space with natural light and provide sweeping views of the surrounding cityscape. The modern kitchen comes fully integrated with high-quality appliances, perfect for both everyday living and entertaining. There are two well-proportioned bedrooms, both designed with comfort and functionality in mind, and a sleek, fully tiled bathroom finished to a high standard.

Haines House benefit from secure entry, lift access, and proximity to a range of local amenities, including shops, cafés, and restaurants. The development is within easy reach of Nine Elms and Vauxhall stations, offering convenient connections to the rest of London.



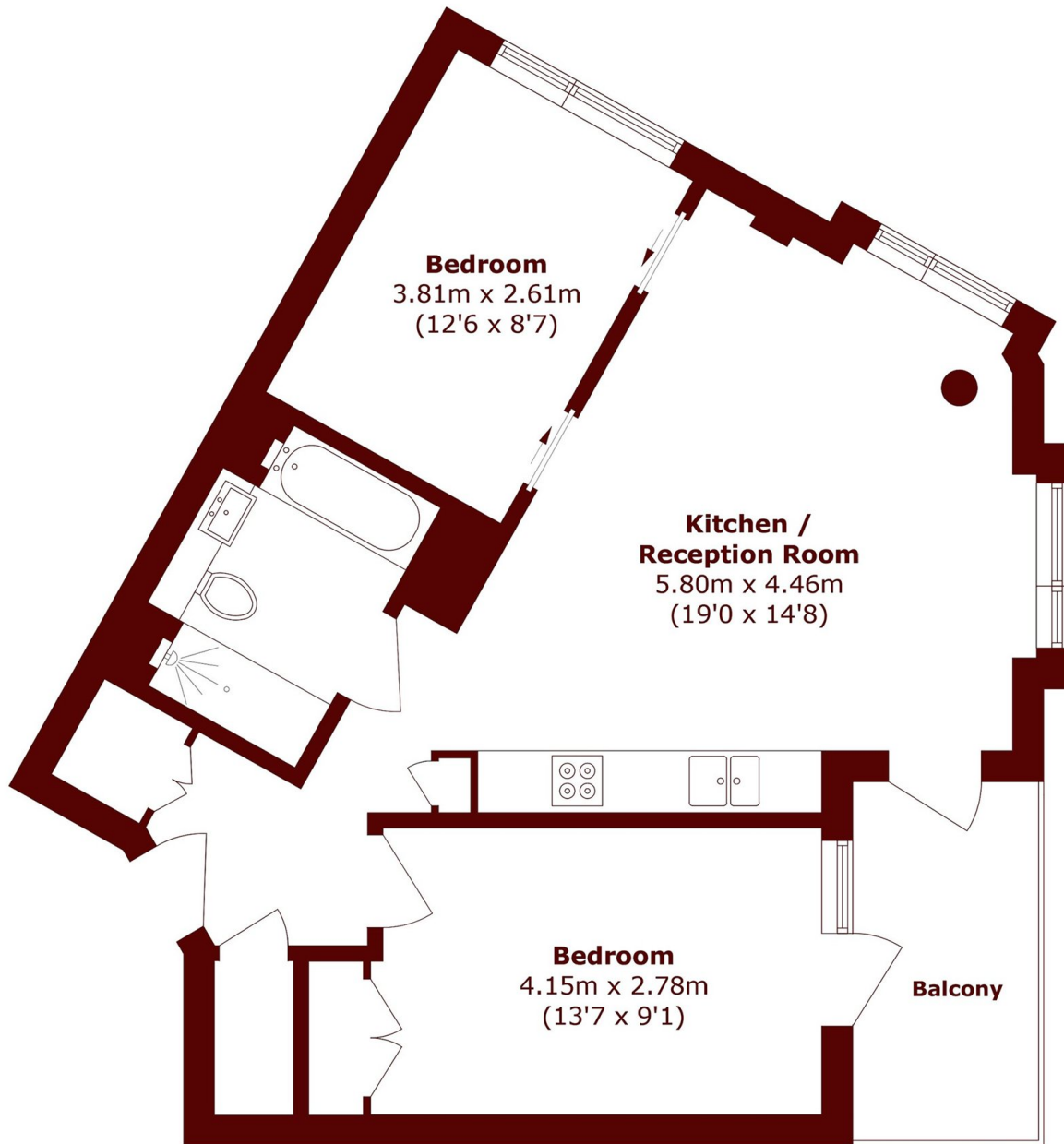

Total area (approx.): 64.5 sq. m (694.3 sq. ft)

Balcony area (approx.): 4.8 sq. m (51.7 sq. ft)

Marsh & Parsons Kennington

295 Kennington Road,
London, SE11 4QE
020 7587 1533