



Sheridan House, SE11

£599,995



- Share of Freehold
- First Floor

- Chain Free
- Excellent Location

- Purpose Built Block
- Lots of Natural Light





ABOUT THE PROPERTY

A generous two double bedroom apartment on the first floor of a popular purpose built block, presented in good condition with well-proportioned rooms. The accommodation comprises a large reception room with a private balcony, a separate fully fitted kitchen, a bathroom, and ample storage throughout. The property benefits from a share of freehold.

Situated on Wincott Street, the apartment is within easy reach of local shops, pubs, and restaurants. Excellent transport links include Kennington (Northern Line), Lambeth North (Bakerloo Line), and Waterloo stations offering mainline and underground connections (Northern, Bakerloo, Jubilee, and Waterloo & City Lines).



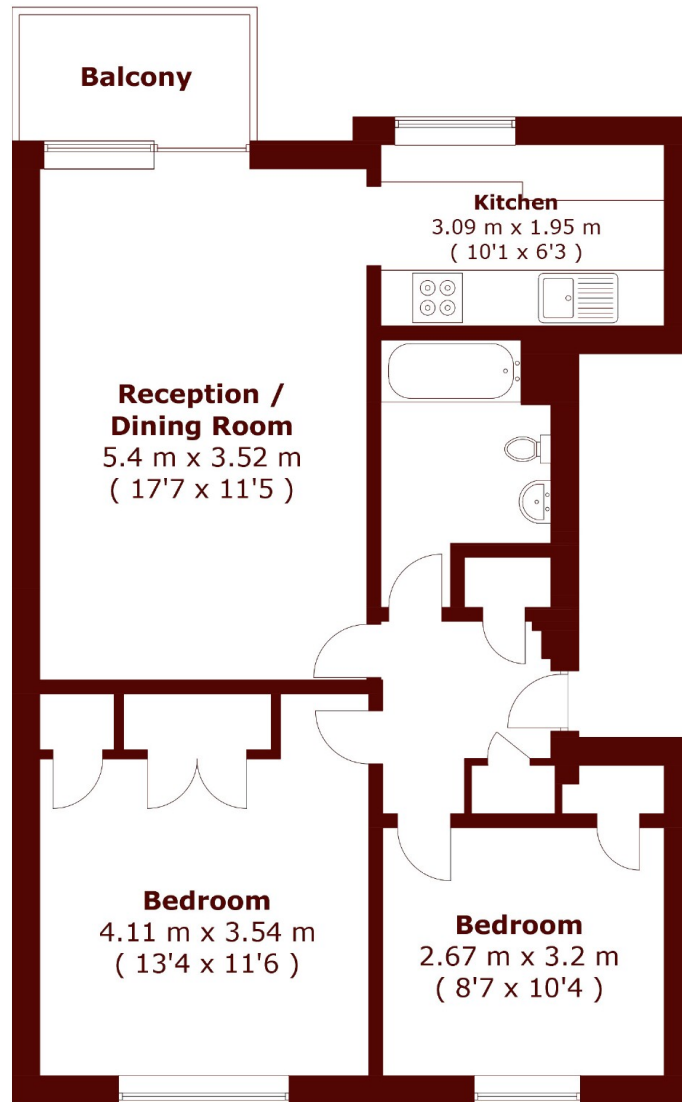

Total area (approx.): 60.6 sq. m (652 sq. ft)

Balcony area (approx.): 3.8 sq. m (40.8 sq. ft)

Marsh & Parsons Kennington

295 Kennington Road,
London, SE11 4QE
020 7587 1533