



Prospect Way, SW11

£2,700,000

 3  3  1  B

- Three Bedrooms
- Three Bathrooms
- Exceptional Finish
- Battersea Power Station
- Winter Garden
- 24-hr Concierge





ABOUT THE PROPERTY

Set within the prestigious Pico House at Battersea Power Station, this exquisite three bedroom, three bathroom apartment combines contemporary design with world class amenities to deliver an unparalleled London living experience.

Positioned on the third floor, the apartment boasts a superb open-plan living and dining space, enhanced by floor to ceiling glazing that floods the interiors with natural light. The bespoke kitchen features premium integrated appliances, sleek cabinetry, elegant finishes. The highlight of this impressive home is the enclosed winter garden, providing a serene space to unwind while overlooking the vibrant surroundings.

Each of the three double bedrooms has been beautifully appointed, including two luxurious en-suite bathrooms and a further family bathroom, all finished to exceptional standards with contemporary fixtures and fine detailing.

Residents of Pico House benefit from 24-hour concierge and on-site security, ensuring complete peace of mind. Ownership also offers access to the outstanding Battersea Power Station lifestyle, with its world-class shopping, dining, and leisure facilities, as well as excellent transport links via the Northern Line extension, River Bus and Thames Path.



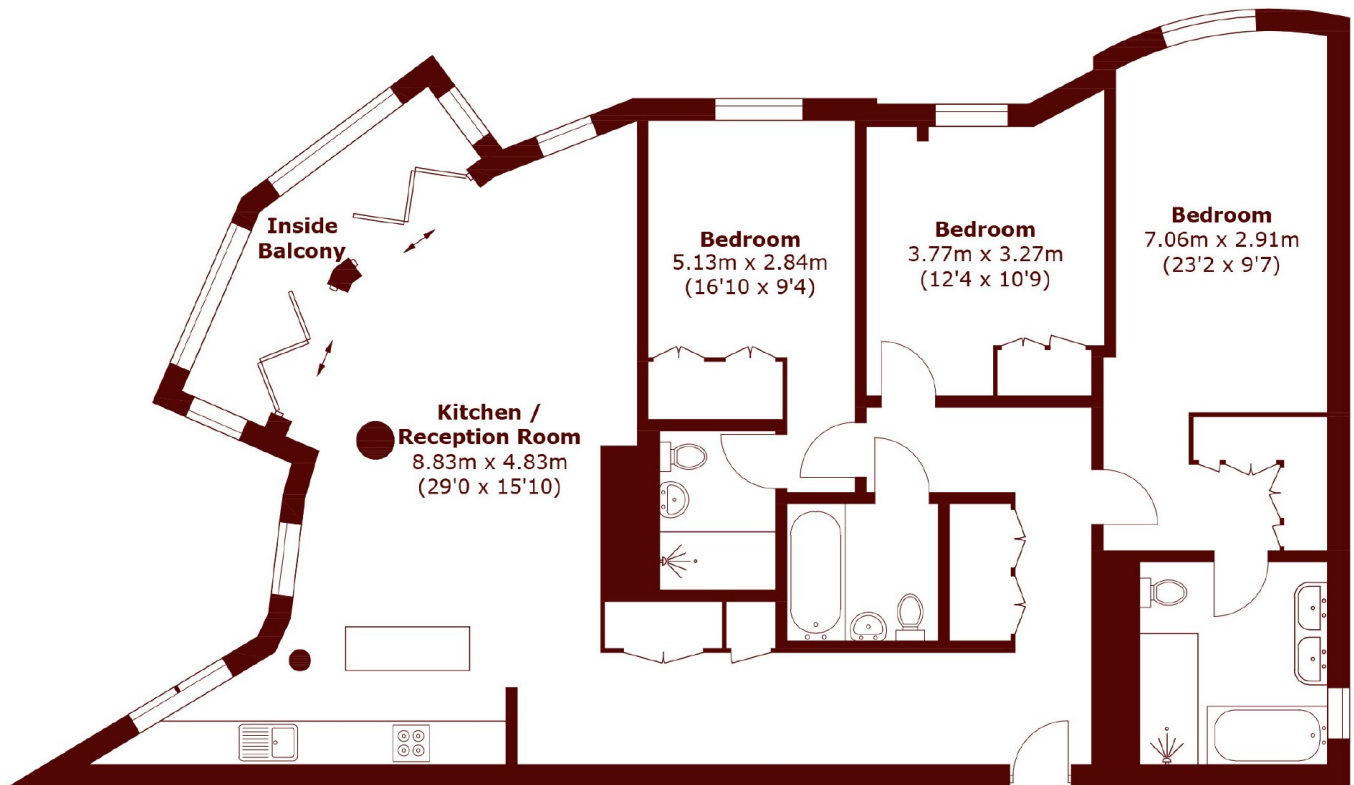

Third Floor

Total area (approx.): 125.2 sq. m (1,347.6 sq. ft)
Inside Balcony: 6.5 sq. m (69.9 sq. ft)

Marsh & Parsons Kennington

295 Kennington Road,
London, SE11 4QE
020 7587 1533