

# Bayview

Oxwich, Gower, SA3 1LS



**£129,995**





## Bayview, Oxwich

### **2 Bedroom Holiday Home**

Immerse yourself in Gower's coastal splendour at this charming two-bedroom bungalow, enjoying a 8-month holiday occupancy each year. Perfectly poised above Oxwich Bay, the property commands sweeping views across rolling fields and towards the sea—a daily reminder of why this area was named Britain's first Area of Outstanding Natural Beauty. Although not ultra-modern, it's offered in comfortable, well-maintained condition, featuring a cosy living room where patio doors open onto a sun terrace, framing those far-reaching vistas.

A small but functional kitchen and a practical bathroom ensure you have everything you need, whether you're looking for a peaceful weekend escape or a longer stay in the heart of South Gower. From Bayview, stroll down to Oxwich's golden sands and follow the coast path east to Penmaen or west to Port Eynon, soaking up panoramic seascapes en route.

With no onward chain and an affordable entry point to Gower living, this bungalow presents a rare opportunity to experience the allure of Three Cliffs Bay and the broader peninsula at your leisure.





01

Two bedrooms, a compact but functional kitchen, and a convenient bathroom—all in well-maintained condition.

02

Nestled in Bayview, Oxwich, this bungalow benefits from a 8-month holiday occupancy in the heart of South Gower.

03

Enjoy sweeping vistas from the cosy living room, complete with patio doors leading to a sun-drenched terrace.

04

With no onward chain, it's perfectly positioned for scenic walks along the golden sands and coast paths to Penmaen or Port







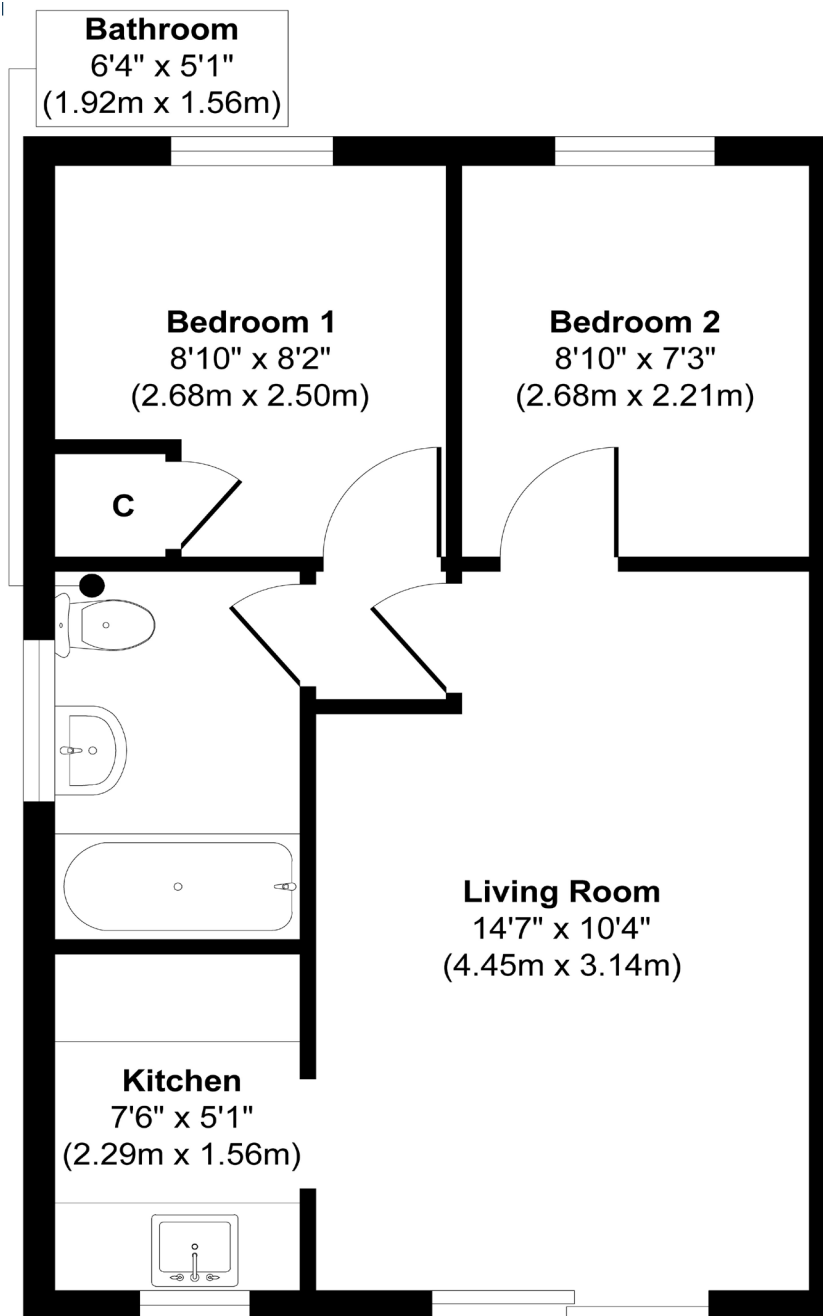

**Floor Plan**

**Approx. Gross Internal Floor Area 398 sq. ft / 36.99sq. m**

Illustration for identification purposes only, measurements are approximate, not to scale.

Produced by Elements Property

The Property is LEASEHOLD with a 999year lease from 2014 the ground rent is £160 plus VAT (every 6 months), the Service Charge is £395.20 plus Vat (also paid every 6 months) so total leasehold out goings (INC VAT ) are £1,332.48p.a.

The property is connected to mains electricity, water and sewerage.

The Council Tax is Band A (£1,345)

The EPC rating is TBC



# WELCOME TO **Oxwich**

Bayview, Oxwich, Gower – The Ideal Holiday Home Destination

Breathtaking Location

Bayview sits within the seaside hamlet of Oxwich, located on the southern fringe of the Gower Peninsula – the UK's first Area of Outstanding Natural Beauty (AONB). Nestled in an elevated position, many properties in Bayview enjoy panoramic sea views across Oxwich Bay, one of Wales' most beautiful stretches of coastline. The combination of sea, sand dunes, woodlands and salt marshes creates a peaceful, unspoiled setting that's perfect for a relaxing escape.

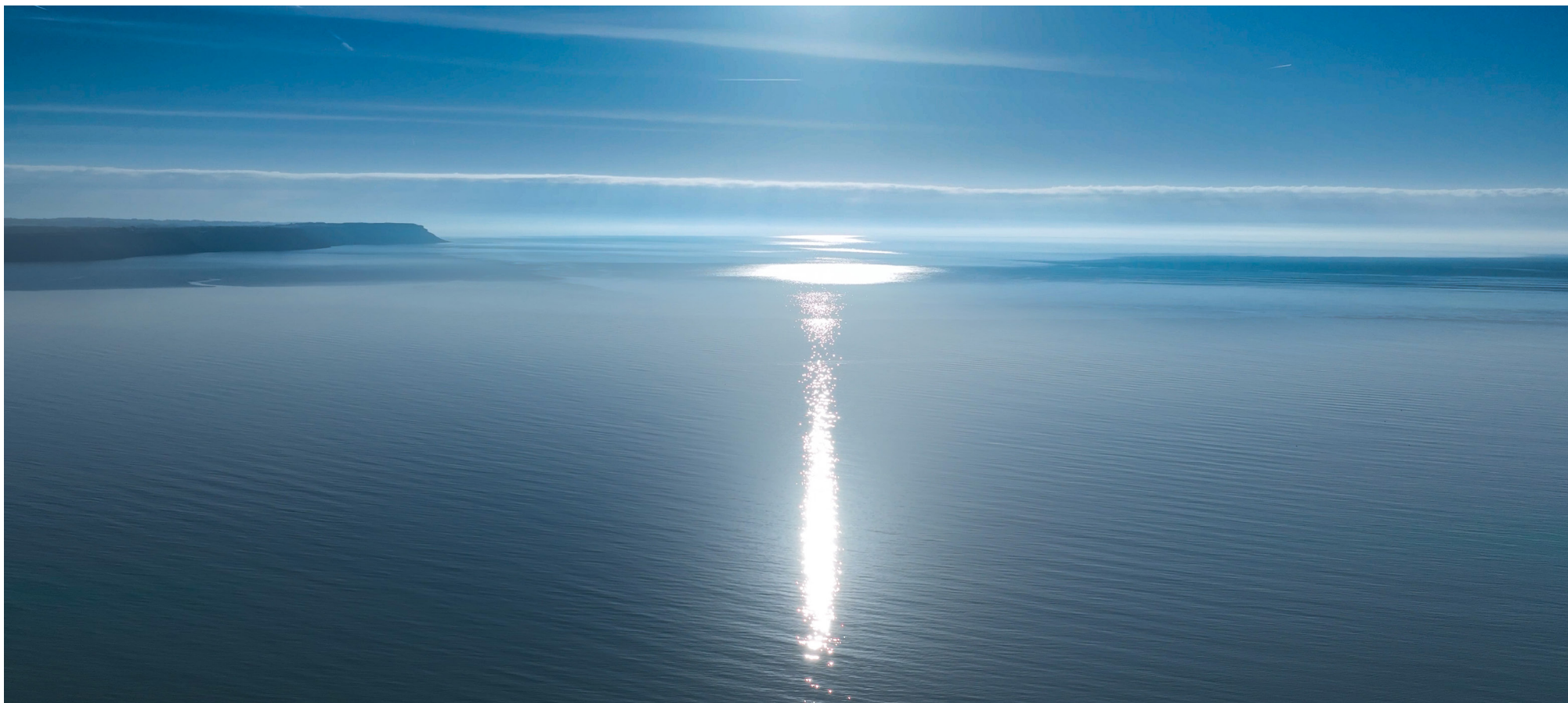



## Beach Access and Scenic Walks

One of the biggest draws of owning a holiday home in Bayview is the proximity to Oxwich Beach:

Walking time to Oxwich Beach: Approximately 7–10 minutes on foot, depending on your exact location within Bayview. It's a gentle downhill walk via quiet country lanes or a woodland path.

Oxwich Bay is a vast, golden sand beach ideal for swimming, sunbathing, watersports, or simply strolling along its two-mile stretch. It's dog-friendly year-round, making it ideal for pet owners.

From the beach, you can walk west to Tor Bay and Three Cliffs Bay via the Wales Coast Path – one of the most stunning cliffside trails in the UK.



### Local Amenities in Oxwich

While Oxwich is a small village, it offers everything you need for a restful holiday:

The Oxwich Bay Hotel – A short walk away, this beachfront hotel and restaurant is a local favourite. It serves breakfast, lunch, and dinner, has a beer garden with sea views, and regularly hosts events and weddings.

Beach House Restaurant – A Michelin-starred dining experience situated right on the beach. This destination restaurant

attracts food lovers from across the UK and offers a fine dining menu featuring local Gower produce and fresh seafood.

Oxwich Watersports – Located directly on the beach, this company offers paddleboard, kayak, and powerboat hire, plus lessons and guided coastal tours.

Oxwich Car Park and Convenience Kiosk – The beachside car park includes a small seasonal shop selling snacks, beach gear, and essentials during summer months.





### Wider Gower Attractions Nearby

Buying a holiday home in Bayview also puts you close to a host of other Gower gems:

Three Cliffs Bay – Just 10 minutes' drive or 1 hour's walk along the coast path. It's one of Wales' most photographed locations, with limestone cliffs, a meandering river, and sand dunes.

Rhossili Bay – Around 20 minutes' drive. Ranked among the top beaches in the world, with 3 miles of golden sands, iconic views from Worm's Head, and superb walking routes.

Port Eynon – 15 minutes by car. A charming beach village with fish and chips, ice cream parlours, and a family-friendly beach.

Reynoldston (10 mins drive) – Offers a lovely pub (The King Arthur Hotel) and access to Cefn Bryn, a scenic ridge with breathtaking panoramic views across Gower.

Mumbles – Around 25–30 minutes by car. This bustling seaside village has boutique shopping, eateries, and a picturesque promenade leading to Oystermouth Castle.

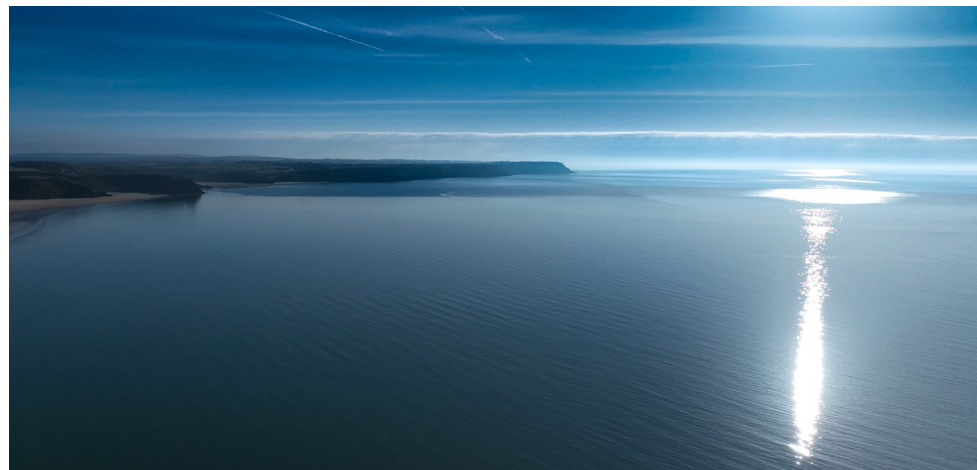



# 37 Bayview

## contact.

**Phone:**

01792 986099

**Address:**

28-30 Dunns Lane, Mumbles, SA3 4AA

**Web:**

[www.thegreenroomhomes.com](http://www.thegreenroomhomes.com)

THE  
**GREENROOM**  
ESTATE AGENCY