

# FOXLOW FIELDS

ASHBOURNE ROAD, BUXTON



A stylish collection of  
2, 3, 4 & 5 bedroom homes



[keepmoat.com](https://www.keepmoat.com)



**ASHBOURNE ROAD, BUXTON**



# FOXLOW FIELDS

# WELCOME TO FOXLOW FIELDS



- WELCOME
- LOCATION
- TRAVEL LINKS
- PICTURE YOURSELF HERE
- SITE PLAN
- MAKE IT YOUR OWN
- SPECIFICATION
- YOUR BUYING GUIDE
- 30,000 HOMES & COUNTING



## MADE FOR MAKING MEMORIES

Situated within the picturesque Peak District, Foxlow Fields in Buxton is a collection of modern 2, 3, 4, and 5 bedroom homes. While the styles of our homes vary, they all demonstrate our innovative design philosophy. We create practical, stylish and spacious homes that are perfectly suited to the demands of modern living; **ideal for first time buyers, growing families, downsizers and investors.**

Buxton is close to the A515, A53, A6 and A54. There's a range of schooling options nearby for all ages and amenities for all your everyday essentials, making living at Foxlow Fields a dream.

*Plus, with great offers like Help to Buy you could move in for less than you think. Home to sell? Ask us about Easymove.*



Backed by  
HM Government

**Easymove**



## LIFE IN BUXTON



### SPOILT FOR CHOICE

If you enjoy the outdoors then you don't have to look any further as the Peak District is on your doorstep. From Dovedale Stepping Stones to Chatsworth House and much more, there's plenty to do for everyone.

Cavendish Golf Club is just a short drive away where you can practise your swing.

Buxton Spa town hosts a range of eateries such as Pizza Express, Simply Thai, La Brasserie De La Cour and plenty more.

Fancy a spot of retail therapy? There's a selection of high-street retailers including Next, Clarks, Superdrug, New Look and new independent boutique style shops.

- WELCOME
- LOCATION
- TRAVEL LINKS
- PICTURE YOURSELF HERE
- SITE PLAN
- MAKE IT YOUR OWN
- SPECIFICATION
- YOUR BUYING GUIDE
- 30,000 HOMES & COUNTING



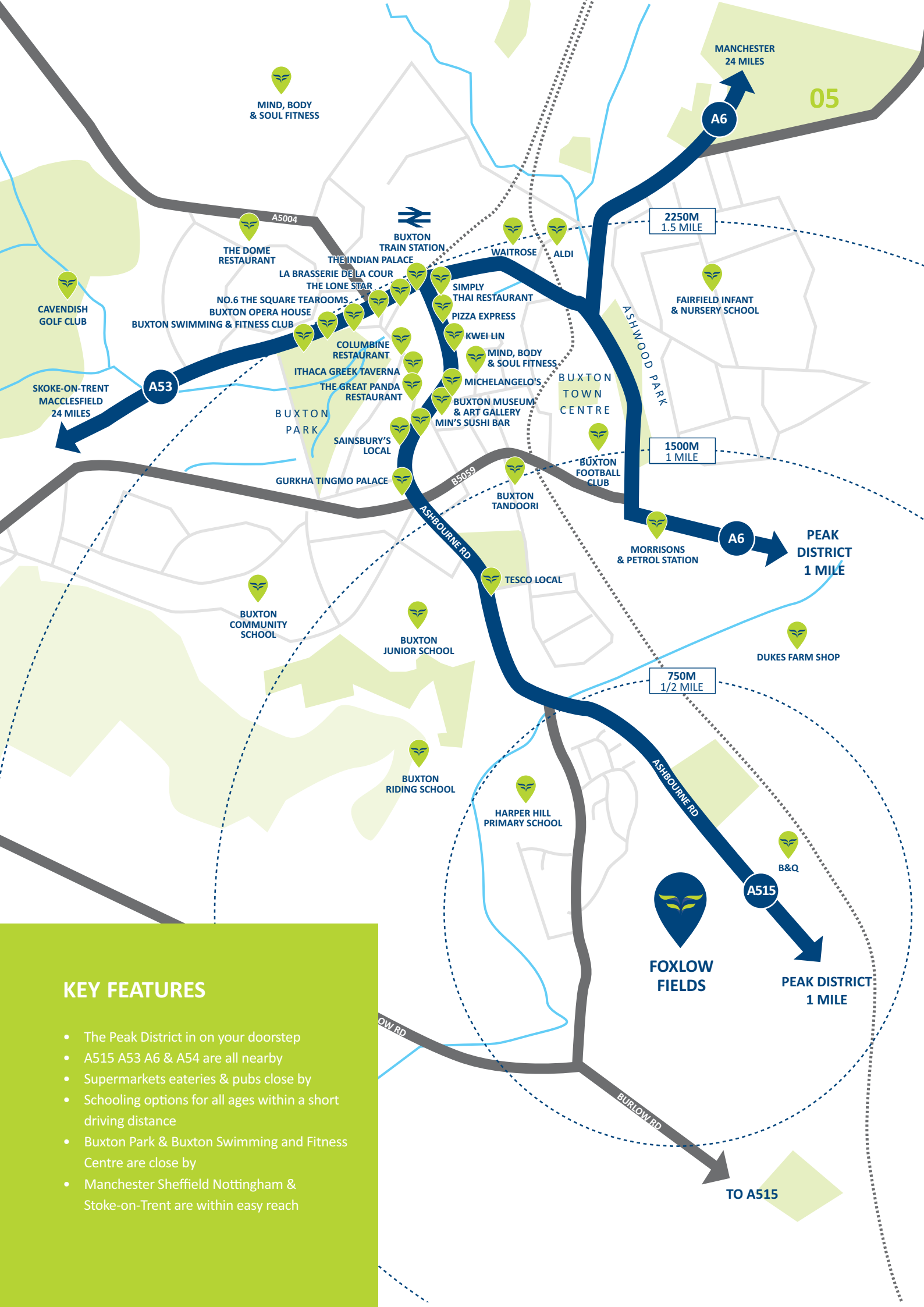

## KEY FEATURES

- The Peak District is on your doorstep
- A515 A53 A6 & A54 are all nearby
- Supermarkets, eateries & pubs close by
- Schooling options for all ages within a short driving distance
- Buxton Park & Buxton Swimming and Fitness Centre are close by
- Manchester, Sheffield, Nottingham & Stoke-on-Trent are within easy reach

# TRAVEL LINKS

## PERFECT FOR EXPLORING

Great transport links make Foxlow Fields perfect for exploring the region. With so many great towns and cities so easy to get to there's always something to do.

Some of the region's most stunning and famous countryside is nearby with excellent access to the Yorkshire Dales to the North and the Peak District and beyond.



\*TIMES FROM BUXTON TRAIN STATION.

\*All times are taken from Google Maps and National Rail. All times are approximate and subject to change.

- WELCOME
- LOCATION
- TRAVEL LINKS
- PICTURE YOURSELF HERE
- SITE PLAN
- MAKE IT YOUR OWN
- SPECIFICATION
- YOUR BUYING GUIDE
- 30,000 HOMES & COUNTING





## PICTURE YOURSELF HERE

























[WELCOME](#)  
[LOCATION](#)  
[TRAVEL LINKS](#)  
[PICTURE YOURSELF HERE](#)  
[SITE PLAN](#)  
[MAKE IT YOUR OWN](#)  
[SPECIFICATION](#)  
[YOUR BUYING GUIDE](#)  
[30,000 HOMES & COUNTING](#)



# SITE PLAN

EXISTING RESIDENTIAL DEVELOPMENT

- |   |   |
|---|---|
|  THE NUTMEG<br>2 bedroom home        |  THE FERN<br>3 bedroom home      |
|  THE BUTTERCUP<br>2 bedroom home     |  THE ALPINE<br>4 bedroom home    |
|  THE CINNAMON<br>2 bedroom home      |  THE ORCHID<br>4 bedroom home    |
|  THE LAUREL<br>3 bedroom home        |  THE THORNTON<br>4 bedroom home  |
|  THE CLOVE<br>3 bedroom home         |  THE JASMINE<br>4 bedroom home   |
|  THE MEADOWSWEET<br>3 bedroom home   |  THE MAGNOLIA<br>4 bedroom home  |
|  THE MULBERRY<br>3 bedroom home    |  THE ASPEN<br>5 bedroom home   |
|  THE BLACKTHORNE<br>3 bedroom home |  THE SAFFRON<br>5 bedroom home |
|  THE CRIMSON<br>3 bedroom home     |  AFFORDABLE HOMES              |
|  THE ELM<br>3 bedroom home         |  SHARED OWNERSHIP              |
- 
- |  |
|--|
|  SALES CENTRE<br>Plot 88    |
|  SHOW HOMES<br>Plot 89 & 90 |



- WELCOME
- LOCATION
- TRAVEL LINKS
- PICTURE YOURSELF HERE
- SITE PLAN**
- MAKE IT YOUR OWN
- SPECIFICATION
- YOUR BUYING GUIDE
- 30,000 HOMES & COUNTING



FUTURE  
COMMERCIAL  
DEVELOPMENT

OPEN FIELDS

Please Note: This site plan is only a guide to the above development. It does not bind or imply that the layout will be as indicated. Please see our Home Sales Executive for full specification and plot details at this development.



## MAKE IT YOUR OWN



- WELCOME
- LOCATION
- TRAVEL LINKS
- PICTURE YOURSELF HERE
- SITE PLAN
- MAKE IT YOUR OWN**
- SPECIFICATION
- YOUR BUYING GUIDE
- 30,000 HOMES & COUNTING



## WE NEVER FORGET IT'S YOUR HOME

Inside every Keepmoat home you'll find high standards of finish throughout, smart modern designs and living spaces that are designed with families in mind. Benefitting from a range of optional extras you can move into a new home that truly feels like your own.

When you buy a Keepmoat Home, you can rest assured that it's covered with not one, but two warranties. Our two year Keepmoat Homes Customer Care Warranty, as well as the NHBC 10 Year Building Warranty.

*Practical and stylish homes that are perfectly suited to the demands of modern living.*

Availability of up-grades and standard choices are subject to build stage at point of reservation.



## SPECIFICATION

### FINISHING TOUCHES

Our standard specification includes high quality, modern fixtures and fittings with a great choice of kitchen worktops and units.

Once you've reserved your home, we'll invite you back for your options meeting. This is the exciting bit. It's here you can discuss all the ways you can personalise your home.

*Be inspired and make your home yours.*

WELCOME  
LOCATION  
TRAVEL LINKS  
PICTURE YOURSELF HERE  
SITE PLAN  
MAKE IT YOUR OWN  
**SPECIFICATION**  
YOUR BUYING GUIDE  
30,000 HOMES & COUNTING





## KITCHEN / UTILITY\*

- Choice of kitchen units\*\*
- Choice of work top with upstand\*\*
- Stainless steel electric oven with integrated extractor hood
- Gas hob and stainless steel splash back
- Stainless steel bowl and a half sink with upgraded tap\*\*
- Integrated dishwasher washing machine and fridge/freezer\*\*
- Boiler housing

## BATHROOM / EN-SUITE\*

- Fitted white sanitaryware
- Choice of wall tiles\*\*
- Chrome hair rinser and twist handle overflow to bath
- Thermostatic shower in the en-suite\*
- Extractor fan to bathroom
- Moisture resistant light fitting

## ELECTRICAL

- White sockets and switches
- TV aerial socket to lounge
- BT socket to lounge
- 2 zone programmable gas central heating system with thermostatic radiator valves

## DECOR

- Matt emulsion painted walls and ceilings
- White gloss paint to interior wood work
- Satin chrome ironmongery to internal doors

## EXTERIORS

- Turfed and or Landscaped front garden\*
- Rotavated rear garden
- UPVC double glazed windows
- UPVC double glazed french doors\*\*

## SAFETY & SECURITY

- Security latches to windows except fire egress
- Mains fed smoke detectors to hall and landing

*Make it your own with our range of optional extras*



# YOUR BUYING GUIDE



## STEP 01

### Reservation

Once you've chosen the home for you, your sales executive will guide you through the reservation agreement. You'll need to pay a reservation fee - this could be as little as £250\* and makes up part of your deposit. It also means, subject to contracts and meeting the timescales in the agreement, the home is yours at the price agreed.

Now's a good time, if you haven't already, to ask us about how the Government-backed Help to Buy scheme \*\* can make buying your dream home more affordable. And if you've got a home to sell, our Easymove scheme could make moving easy as we'll arrange an estate agent and even pay their fees.



## STEP 02

### The Mortgage and Legal Advisor

If you need a mortgage and haven't already arranged one, you'll need to do so quickly. We can give you the details of some reputable independent financial advisers and solicitors if you need a little help. All mortgage lenders will want to value your new home for themselves before they lend you the money – even on our homes which offer fantastic value for money.

When moving house you need a solicitor to carry out the legal work of buying your home – this is called conveyancing. Your solicitor will handle all contracts, provide legal advice and carry out local council searches, work with the Land Registry and transfer the funds to pay for your property.



## STEP 03

### Exchange of Contracts

Four weeks after reservation (depending on the build stage of your new home) and if all the mortgage and legal documents are in place, we'll exchange contracts†.

At this point you'll need to pay the balance of the deposit and the whole transaction becomes legally binding. Please remember that if your deposit is in an account that you need to give notice of withdrawal, make sure you let the bank know well in advance to avoid having to pay any penalties

- WELCOME
- LOCATION
- TRAVEL LINKS
- PICTURE YOURSELF HERE
- SITE PLAN
- MAKE IT YOUR OWN
- SPECIFICATION
- YOUR BUYING GUIDE
- 30,000 HOMES & COUNTING

---

\*Reservation fee is regional and development specific and may vary, please check with your Sale Executive.

\*\*Help to buy is available on selected plots and subject to terms and conditions. † If the exchange does not take place on the agreed date we are within our rights to place the property back on the open market.



## STEP 04

### Build Completion

Once the build of your home is complete, you will be informed of a legal completion window of a month (4 weeks). During this time your home will also undergo thorough quality inspections, both internally and externally, to ensure that it meets our quality standards. It will also be subject to a final inspection by the National House Building Council (NHBC). Once this is complete, we will then be able to serve a legal completion date to your solicitor whom in turn, will notify you. This will normally be within 7 days after the inspection.

Around this time, we'll invite you to a home demonstration to familiarise yourself with your new home. During the demonstration we'll show you everything from how to work your heating system and appliances to the location of your fuse box.



## STEP 05

### Legal Completion

You're nearly there. Legal completion is when your lender releases the funds to pay for your home. This is all done through your solicitor.

At this stage, we will provide your solicitor with the title deeds of your home.



## STEP 06

### Move in

Your dream Keepmoat home and a great new life awaits... once you've unpacked all the boxes.

Don't forget, we're always on hand to help you every step of the way even after you've moved in. Our regional customer care teams featuring highly trained staff can address any questions or issues that you may have with your new home.





## 30,000 HOMES AND COUNTING

There is no substitute for experience, and we have that in abundance. We've already created 30,000 dream homes and counting.

While the number may be impressive, we know that there's only one home that's important - and that's yours.

That's why we treat every home we build like it's our first - lavishing it with care and attention to detail from start to finish.

*We never forget that it's your home.*

WELCOME  
LOCATION  
TRAVEL LINKS  
PICTURE YOURSELF HERE  
SITE PLAN  
MAKE IT YOUR OWN  
SPECIFICATION  
YOUR BUYING GUIDE  
30,000 HOMES & COUNTING



*Start the next  
exciting chapter  
in your life*



Artists impression, features may vary

# THE ALPINE 4 bedroom home

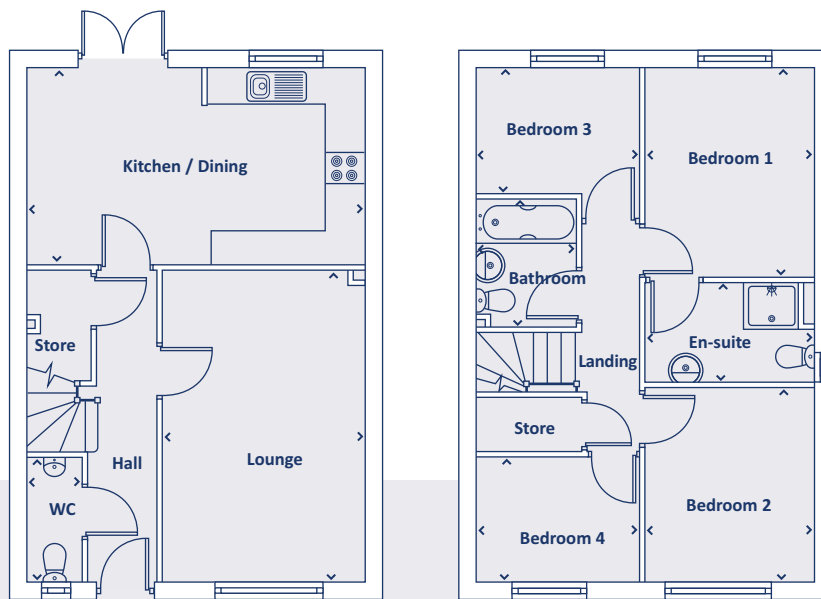

## GROUND FLOOR

Kitchen / Dining	5552 x 3285	18'3" x 10'9"
Lounge	3325 x 5069	10'11" x 16'8"
WC	906 x 2010	3'0" x 6'7"

## FIRST FLOOR

Bedroom 1	2761 x 3469	9'1" x 11'5"
En-suite	2761 x 1643	9'1" x 5'5"
Bedroom 2	2761 x 3149	9'1" x 10'4"
Bedroom 3	2713 x 2490	8'11" x 8'2"
Bedroom 4	2713 x 2000	8'11" x 6'7"
Bathroom	1694 x 2085	5'7" x 6'10"

› Longest measurement taken

**PLEASE NOTE:**

For illustration purposes only. All dimensions are + or - 50mm and these measurements should not be used for the purchase of carpets or furniture. Please see our Sales Executive for full specification and plot details at this development.

**CONSUMER  
CODE FOR  
HOME BUILDERS**  
[www.consumercode.co.uk](http://www.consumercode.co.uk)



Artists impression, features may vary

# THE BLACKTHORNE 3 bedroom home

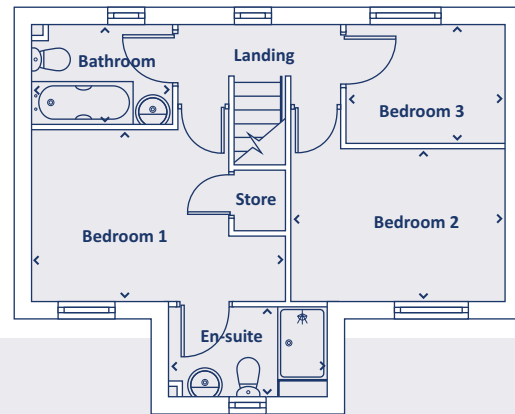
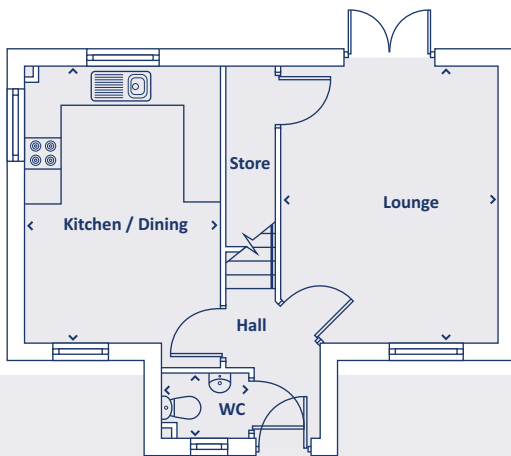

## GROUND FLOOR

Kitchen / Dining	3202 x 4504	10'6" x 14'9"
Lounge	3528 x 4509	11'7" x 14'10"
WC	1453 x 1054	4'9" x 3'6"

## FIRST FLOOR

Bedroom 1	4150 x 2831	13'7" x 9'3"
En-suite	2606 x 1482	8'7" x 4'10"
Bedroom 2	3528 x 2500	11'7" x 8'2"
Bedroom 3	2568 x 1916	8'5" x 6'3"
Bathroom	2292 x 1585	7'6" x 5'2"

› Longest measurement taken

**PLEASE NOTE:**

For illustration purposes only. All dimensions are + or - 50mm and these measurements should not be used for the purchase of carpets or furniture. Please see our Sales Executive for full specification and plot details at this development.

**CONSUMER  
CODE FOR  
HOME BUILDERS**

[www.consumercode.co.uk](http://www.consumercode.co.uk)



Artists impression; features may vary

# THE BUTTERCUP 2 bedroom home

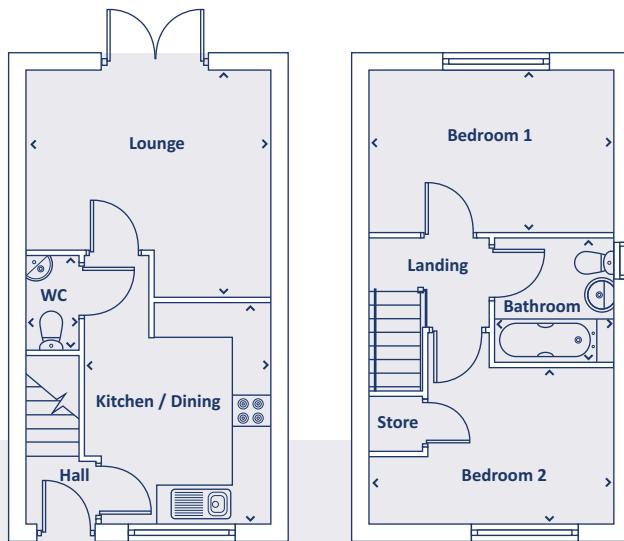

## GROUND FLOOR

Kitchen / Dining	3049 x 3625	10'0" x 11'11"
Lounge	3992 x 3716	13'1" x 12'2"
WC	1558 x 855	5'1" x 2'10"

## FIRST FLOOR

Bedroom 1	3992 x 2673	13'1" x 8'9"
Bedroom 2	3992 x 2560	13'1" x 8'5"
Bathroom	1940 x 2015	6'4" x 6'7"

› Longest measurement taken

**PLEASE NOTE:**

For illustration purposes only. All dimensions are + or - 50mm and these measurements should not be used for the purchase of carpets or furniture. Please see our Sales Executive for full specification and plot details at this development.

**CONSUMER  
CODE FOR  
HOME BUILDERS**  
[www.consumercode.co.uk](http://www.consumercode.co.uk)





Artists impression, features may vary

## THE CINNAMON 2 bedroom home

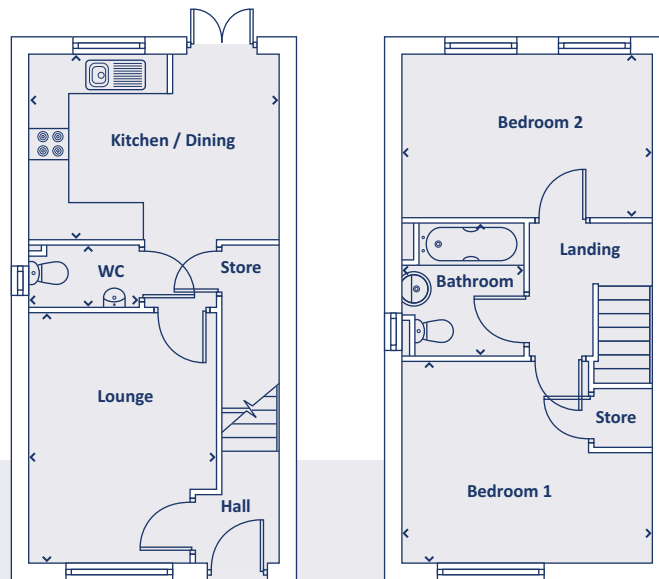

### GROUND FLOOR

Kitchen / Dining	4033 x 3000	13'3" x 9'10"
Lounge	3056 x 4102	10'0" x 13'5"
WC	1775 x 1002	5'10" x 3'3"

### FIRST FLOOR

Bedroom 1	4048 x 3302	13'3" x 10'10"
Bedroom 2	4048 x 2650	13'3" x 8'8"
Bathroom	1952 x 2160	6'5" x 7'1"

› Longest measurement taken

**PLEASE NOTE:**

For illustration purposes only. All dimensions are + or - 50mm and these measurements should not be used for the purchase of carpets or furniture. Please see our Sales Executive for full specification and plot details at this development.

**CONSUMER  
CODE FOR  
HOME BUILDERS**

[www.consumercode.co.uk](http://www.consumercode.co.uk)



Artists impression, features may vary

# THE CLOVE 3 bedroom home

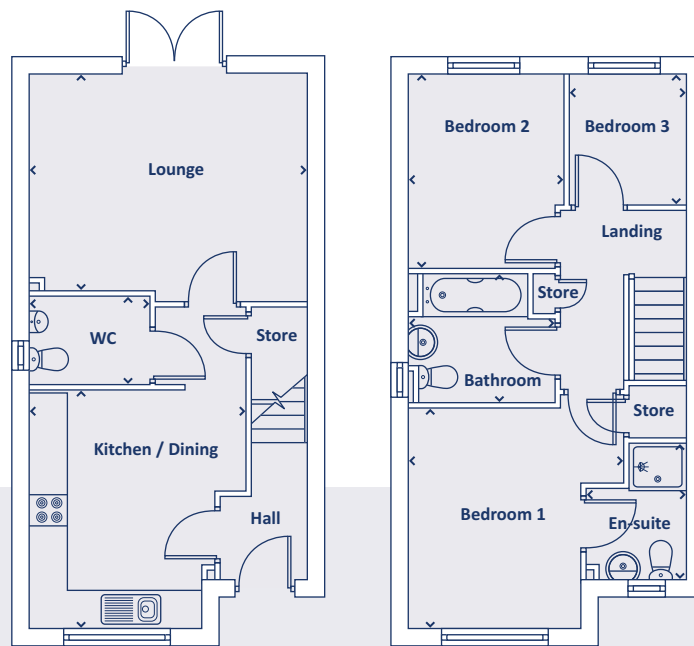

## GROUND FLOOR

Kitchen / Dining	3547 x 3913	11'8" x 12'10"
Lounge	4554 x 3562	14'11" x 11'8"
WC	1958 x 1425	5'6" x 4'8"

## FIRST FLOOR

Bedroom 1	3544 x 3612	11'8" x 11'10"
En-suite	1622 x 2227	5'4" x 7'4"
Bedroom 2	2556 x 3197	8'5" x 10'6"
Bedroom 3	1906 x 2144	6'3" x 7'0"
Bathroom	2219 x 2089	7'3" x 6'10"

› Longest measurement taken

**PLEASE NOTE:**

For illustration purposes only. All dimensions are + or - 50mm and these measurements should not be used for the purchase of carpets or furniture. Please see our Sales Executive for full specification and plot details at this development.

**CONSUMER  
CODE FOR  
HOME BUILDERS**  
[www.consumercode.co.uk](http://www.consumercode.co.uk)



Artists impression, features may vary

# THE CRIMSON 3 bedroom home

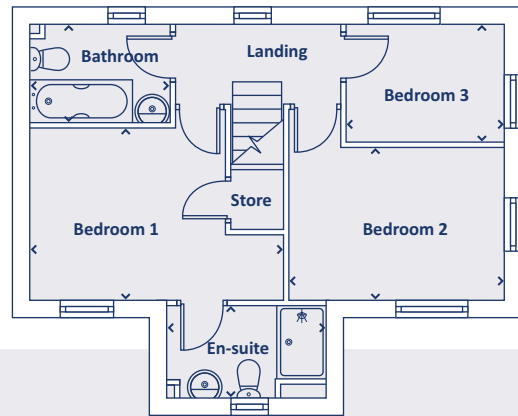
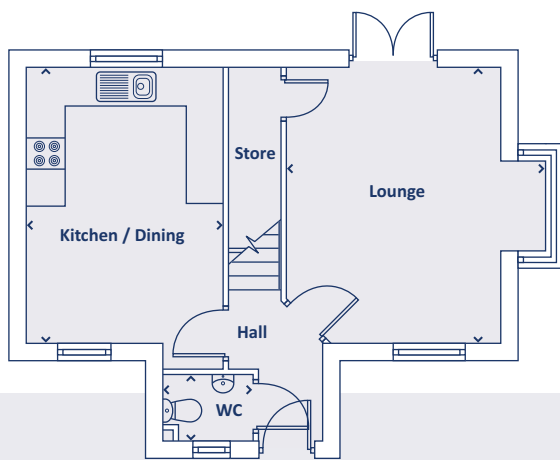

## GROUND FLOOR

Kitchen / Dining	3202 x 4509	10'6" x 14'10"
Lounge	4203 x 4509	13'9" x 14'10"
WC	1453 x 1054	4'9" x 3'6"

## FIRST FLOOR

Bedroom 1	4150 x 2831	13'7" x 9'3"
En-suite	2612 x 1482	8'7" x 4'10"
Bedroom 2	3528 x 2500	11'7" x 8'2"
Bedroom 3	2568 x 1916	8'5" x 6'3"
Bathroom	2292 x 1585	7'6" x 5'2"

› Longest measurement taken

**PLEASE NOTE:**

For illustration purposes only. All dimensions are + or - 50mm and these measurements should not be used for the purchase of carpets or furniture. Please see our Sales Executive for full specification and plot details at this development.

**CONSUMER CODE FOR HOME BUILDERS**  
www.consumercode.co.uk



Artists impression, features may vary

## THE ELM 3 bedroom home

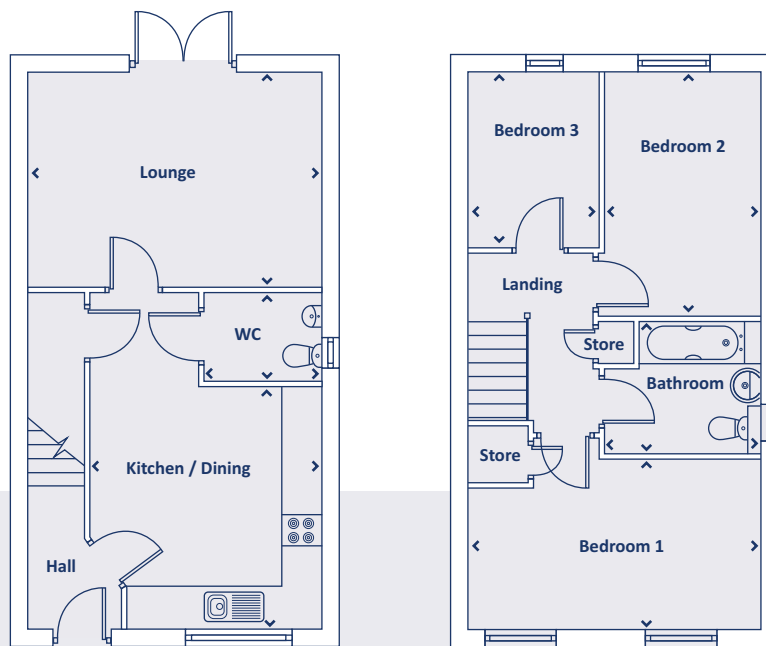

### GROUND FLOOR

Kitchen / Dining	3771 x 5516	12'4" x 18'1"
Lounge	4779 x 3512	15'8" x 11'6"
WC	1888 x 1425	6'2" x 4'8"

### FIRST FLOOR

Bedroom 1	4779 x 2762	15'8" x 9'1"
Bedroom 2	2536 x 4000	8'4" x 13'1"
Bedroom 3	2150 x 2878	7'1" x 9'5"
Bathroom	2346 x 2137	7'8" x 7'0"

› Longest measurement taken

**PLEASE NOTE:**

For illustration purposes only. All dimensions are + or - 50mm and these measurements should not be used for the purchase of carpets or furniture. Please see our Sales Executive for full specification and plot details at this development.

**CONSUMER  
CODE FOR  
HOME BUILDERS**

[www.consumercode.co.uk](http://www.consumercode.co.uk)



Artists impression; features may vary

# THE FERN 3 bedroom home

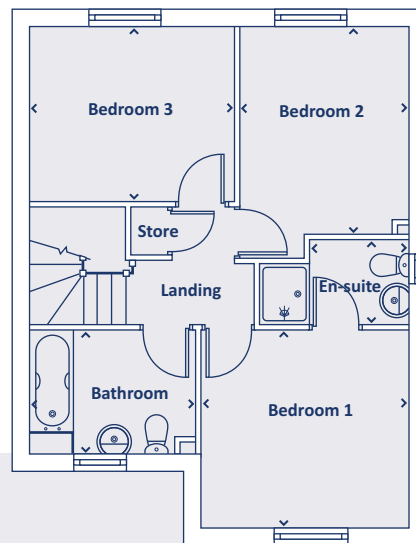
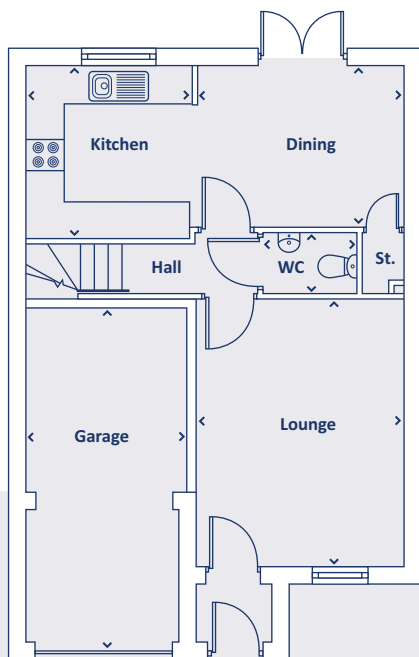

## GROUND FLOOR

Kitchen	2677 x 2822	8'9" x 9'3"
Dining	3369 x 2614	11'1" x 8'7"
Lounge	3384 x 4396	11'1" x 14'5"
WC	1520 x 1010	5'0" x 3'4"
Garage	2622 x 5587	8'7" x 18'4"

> Longest measurement taken

## FIRST FLOOR

Bedroom 1	3384 x 3253	11'1" x 10'8"
En-suite	2427 x 1375	8'0" x 4'6"
Bedroom 2	2775 x 3782	9'1" x 12'5"
Bedroom 3	3331 x 2822	10'11" x 9'3"
Bathroom	2759 x 2031	9'1" x 6'8"

**PLEASE NOTE:**

For illustration purposes only. All dimensions are + or - 50mm and these measurements should not be used for the purchase of carpets or furniture. Please see our Sales Executive for full specification and plot details at this development.

**CONSUMER  
CODE FOR  
HOME BUILDERS**  
[www.consumercode.co.uk](http://www.consumercode.co.uk)



Artists impression, features may vary

# THE JASMINE 4 bedroom home

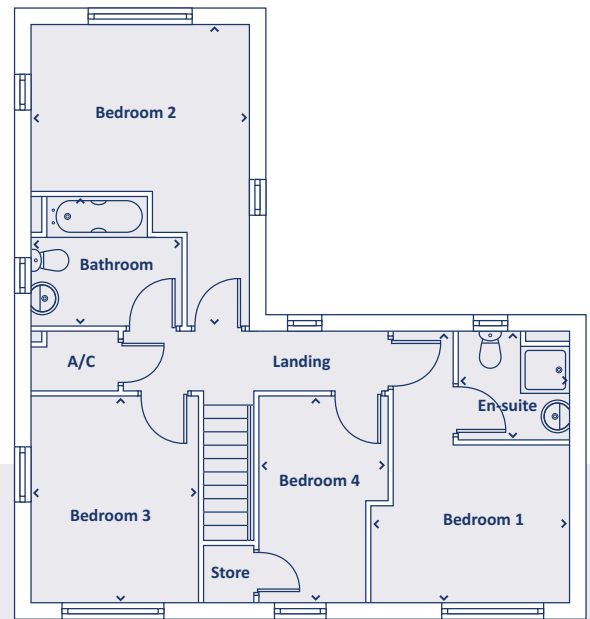
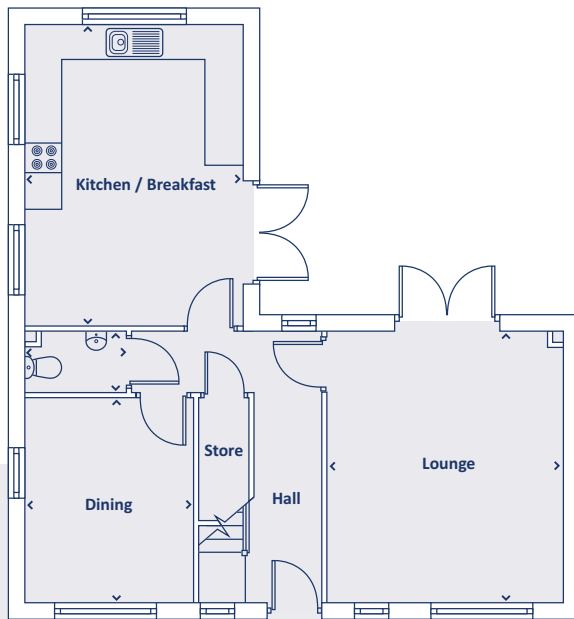

## GROUND FLOOR

Kitchen / Breakfast	3609 x 5057	11'10" x 16'7"
Lounge	3964 x 4509	13'0" x 14'10"
Dining	2790 x 3406	9'2" x 11'2"
WC	1650 x 1010	5'5" x 3'4"

› Longest measurement taken

## FIRST FLOOR

Bedroom 1	3285 x 4509	10'9" x 14'10"
En-suite	1807 x 1800	5'11" x 5'11"
Bedroom 2	3609 x 5082	11'10" x 16'8"
Bedroom 3	2790 x 3406	9'2" x 11'2"
Bedroom 4	1800 x 3406	5'11" x 11'2"
Bathroom	2529 x 2220	8'4" x 7'3"

**PLEASE NOTE:**

For illustration purposes only. All dimensions are + or - 50mm and these measurements should not be used for the purchase of carpets or furniture. Please see our Sales Executive for full specification and plot details at this development.

**CONSUMER CODE FOR HOME BUILDERS**  
www.consumercode.co.uk



Artists impression, features may vary

# THE LAUREL 3 bedroom home

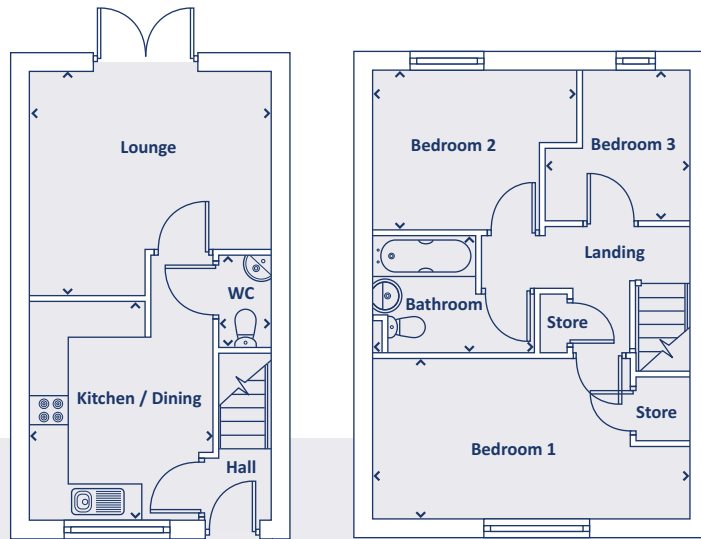

## GROUND FLOOR

Kitchen / Dining	3044 x 3625	10'0" x 11'11"
Lounge	3992 x 3716	13'1" x 12'2"
WC	1558 x 855	5'1" x 2'10"

## FIRST FLOOR

Bedroom 1	5248 x 2639	17'3" x 8'8"
Bedroom 2	2770 x 2639	9'1" x 8'8"
Bedroom 3	1784 x 2493	5'10" x 8'2"
Bathroom	2677 x 1970	8'9" x 6'6"

› Longest measurement taken

**PLEASE NOTE:**

For illustration purposes only. All dimensions are + or - 50mm and these measurements should not be used for the purchase of carpets or furniture. Please see our Sales Executive for full specification and plot details at this development.

**CONSUMER  
CODE FOR  
HOME BUILDERS**  
[www.consumercode.co.uk](http://www.consumercode.co.uk)



Artists impression, features may vary

# THE MAGNOLIA 4 bedroom home

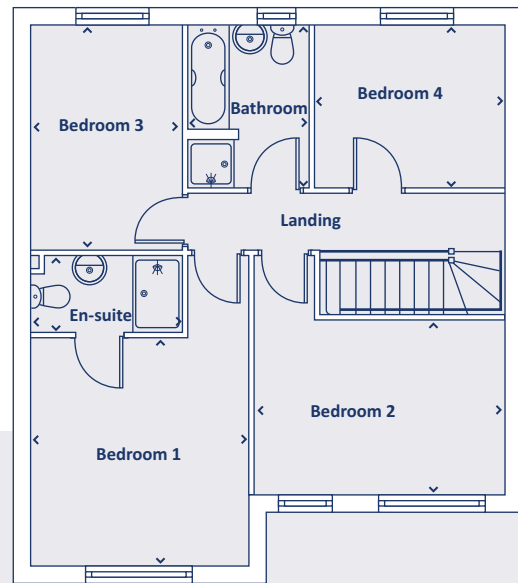
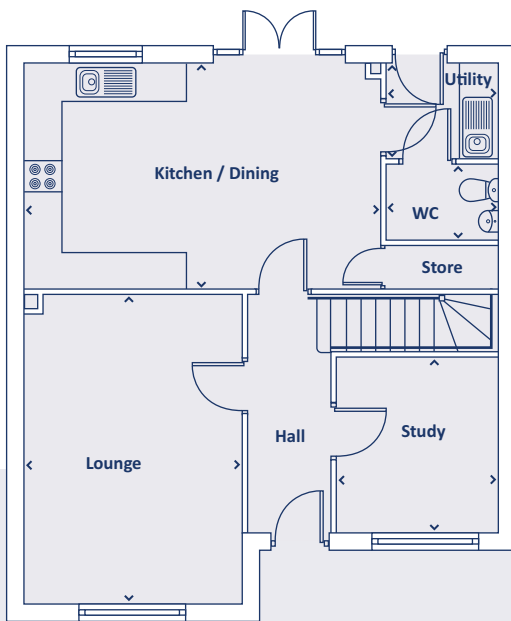

## GROUND FLOOR

Kitchen / Dining	5879 x 3702	19'3" x 12'2"
Lounge	3497 x 4998	11'6" x 16'5"
Study	2626 x 2875	8'7" x 9'5"
Utility	1561 x 1811	5'1" x 5'11"
WC	1811 x 1271	5'11" x 4'2"

› Longest measurement taken

## FIRST FLOOR

Bedroom 1	3497 x 5039	11'6" x 16'6"
En-suite	2490 x 1227	8'2" x 4'0"
Bedroom 2	4168 x 3914	13'8" x 12'10"
Bedroom 3	2490 x 3697	8'2" x 12'2"
Bedroom 4	3075 x 2670	10'1" x 8'9"
Bathroom	2007 x 2670	6'7" x 8'9"

### PLEASE NOTE:

For illustration purposes only. All dimensions are + or - 50mm and these measurements should not be used for the purchase of carpets or furniture. Please see our Sales Executive for full specification and plot details at this development.

**CONSUMER  
CODE FOR  
HOME BUILDERS**

[www.consumercode.co.uk](http://www.consumercode.co.uk)





Artists impression, features may vary

# THE MEADOWSWEET 3 bedroom home

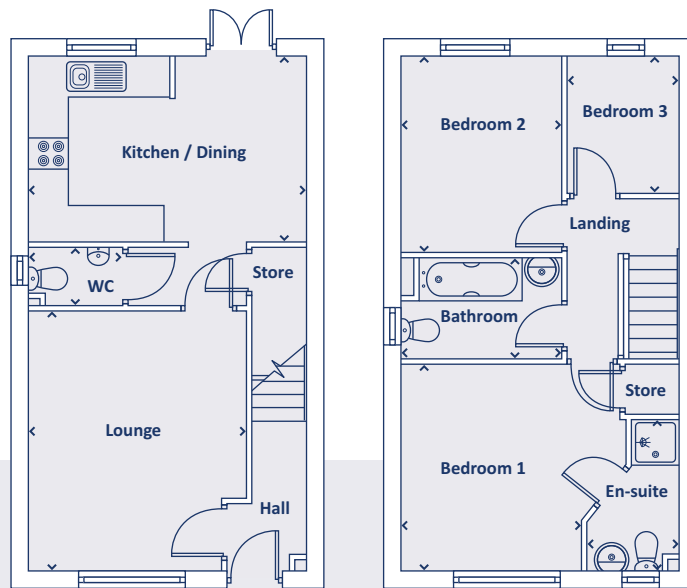

## GROUND FLOOR

Kitchen / Dining	4498 x 3035	14'9" x 10'0"
Lounge	3550 x 4266	11'8" x 14'0"
WC	1510 x 961	4'11" x 3'2"

## FIRST FLOOR

Bedroom 1	3645 x 3390	12'0" x 11'1"
En-suite	1492 x 2472	4'11" x 8'1"
Bedroom 2	2587 x 3210	8'6" x 10'6"
Bedroom 3	1819 x 2240	6'0" x 7'4"
Bathroom	2587 x 1661	8'6" x 5'5"

› Longest measurement taken

**PLEASE NOTE:**

For illustration purposes only. All dimensions are + or - 50mm and these measurements should not be used for the purchase of carpets or furniture. Please see our Sales Executive for full specification and plot details at this development.

**CONSUMER  
CODE FOR  
HOME BUILDERS**  
[www.consumercode.co.uk](http://www.consumercode.co.uk)



Artists impression, features may vary

# THE MULBERRY 3 bedroom home

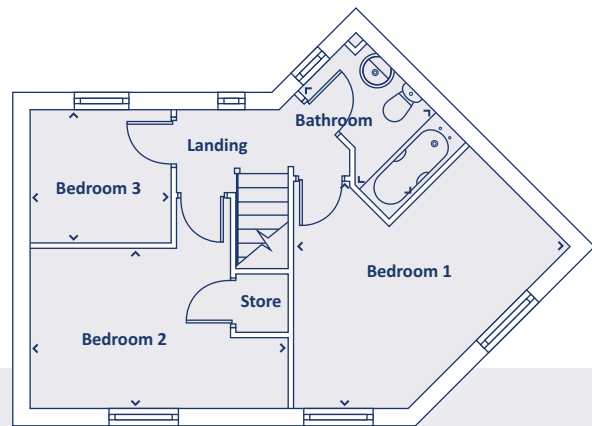
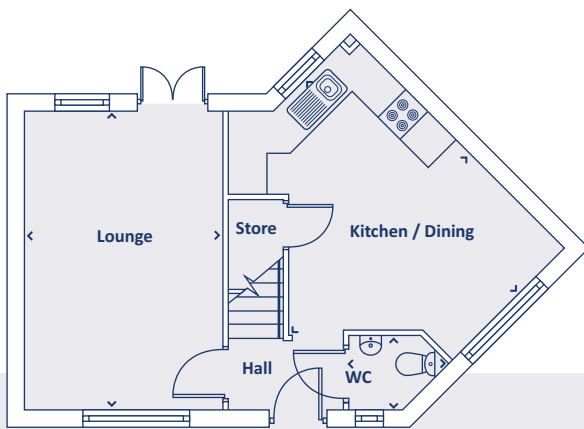

## GROUND FLOOR

Kitchen / Dining	4536 x 4784	14'11" x 15'8"
Lounge	3210 x 4847	10'6" x 15'11"
WC	1095 x 1377	3'57" x 4'6"

## FIRST FLOOR

Bedroom 1	4521 x 3693	14'10" x 12'1"
Bedroom 2	4215 x 2617	13'10" x 8'7"
Bedroom 3	2276 x 2137	7'6" x 7'0"
Bathroom	1694 x 2530	5'7" x 8'4"

› Longest measurement taken

**PLEASE NOTE:**

For illustration purposes only. All dimensions are + or - 50mm and these measurements should not be used for the purchase of carpets or furniture. Please see our Sales Executive for full specification and plot details at this development.

**CONSUMER CODE FOR HOME BUILDERS**  
www.consumercode.co.uk



Artists impression, features may vary

## THE ORCHID 4 bedroom home

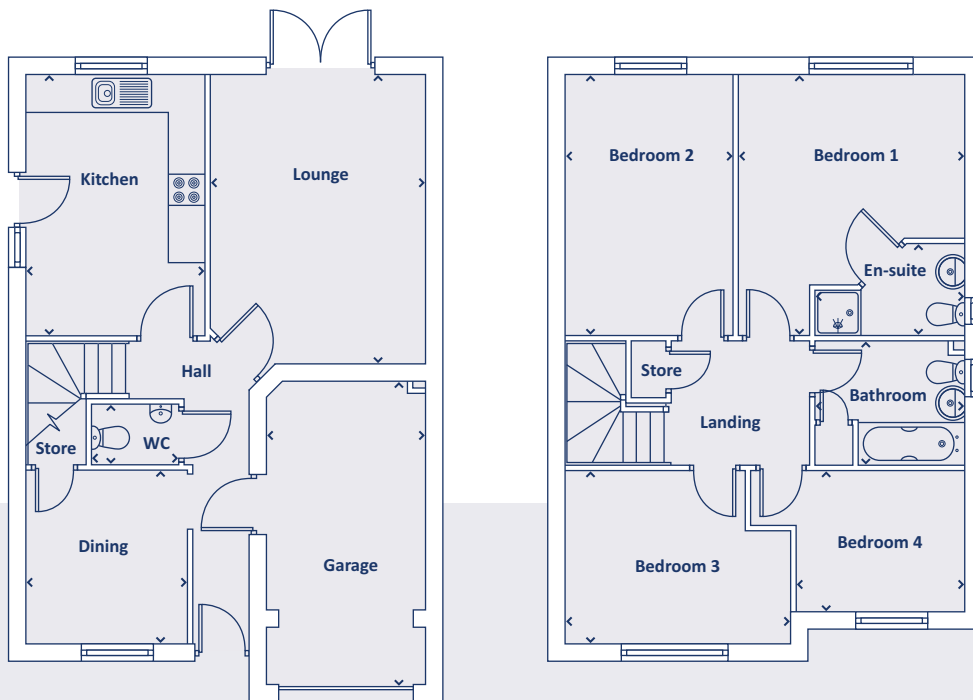

### GROUND FLOOR

Kitchen	2935 x 4275	9'8" x 14'0"
Dining	2650 x 2835	8'8" x 9'4"
Lounge	3506 x 4747	11'6" x 15'7"
WC	1450 x 1010	4'9" x 3'4"
Garage	2647 x 5173	8'8" x 17'0"

› Longest measurement taken

### FIRST FLOOR

Bedroom 1	3694 x 4275	12'1" x 14'0"
En-suite	2418 x 1519	7'11" x 5'0"
Bedroom 2	2747 x 4275	9'0" x 14'0"
Bedroom 3	3697 x 2835	12'2" x 9'4"
Bedroom 4	3494 x 2272	11'6" x 7'5"
Bathroom	2424 x 2050	7'11" x 6'9"

#### PLEASE NOTE:

For illustration purposes only. All dimensions are + or - 50mm and these measurements should not be used for the purchase of carpets or furniture. Please see our Sales Executive for full specification and plot details at this development.

**CONSUMER  
CODE FOR  
HOME BUILDERS**

[www.consumercode.co.uk](http://www.consumercode.co.uk)



Artists impression, features may vary

# THE SAFFRON 5 bedroom home

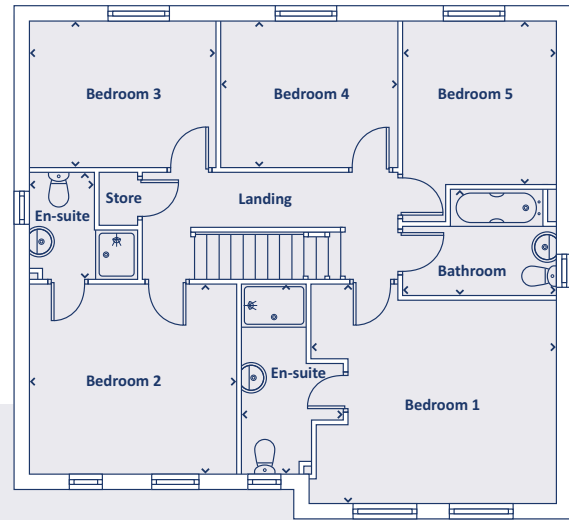
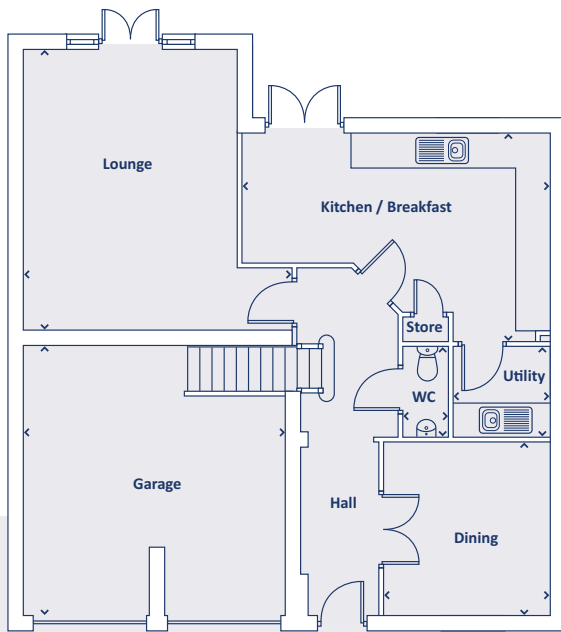

## GROUND FLOOR

Kitchen / Breakfast	5715 x 3847	18'9" x 12'7"
Dining	3060 x 3197	10'0" x 10'6"
Lounge	3894 x 5253	12'9" x 17'3"
Utility	1755 x 1660	5'9" x 5'5"
WC	855 x 1660	2'10" x 5'5"
Garage	5357 x 4858	17'7" x 15'11"

› Longest measurement taken

## FIRST FLOOR

Bedroom 1	4559 x 4078	14'11" x 13'5"
En-suite	1894 x 3518	6'3" x 11'7"
Bedroom 2	3807 x 3518	12'6" x 11'7"
En-suite	1947 x 1997	6'5" x 6'7"
Bedroom 3	3419 x 2683	11'3" x 8'10"
Bedroom 4	3287 x 2683	10'9" x 8'10"
Bedroom 5	2842 x 2993	9'4" x 9'10"
Bathroom	2842 x 1985	9'4" x 6'6"

### PLEASE NOTE:

For illustration purposes only. All dimensions are + or - 50mm and these measurements should not be used for the purchase of carpets or furniture. Please see our Sales Executive for full specification and plot details at this development.

**CONSUMER  
CODE FOR  
HOME BUILDERS**  
[www.consumercode.co.uk](http://www.consumercode.co.uk)



Artists impression, features may vary

# THE THORNTON 4 bedroom home

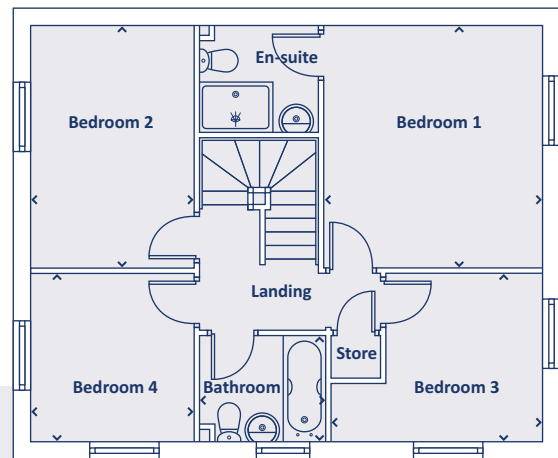
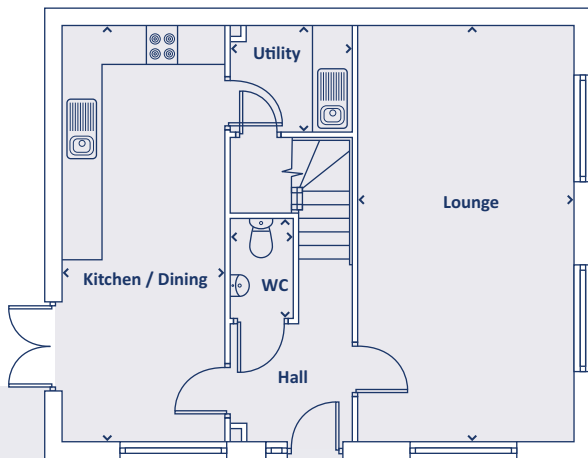

## GROUND FLOOR

Kitchen / Dining	2600 x 6810	8'6" x 22'4"
Lounge	3515 x 6810	11'6" x 22'4"
Utility	1945 x 1720	6'5" x 5'8"
WC	1012 x 1621	3'4" x 5'4"

› Longest measurement taken

## FIRST FLOOR

Bedroom 1	3572 x 3980	11'9" x 13'1"
En-suite	1960 x 1735	6'5" x 5'8"
Bedroom 2	2657 x 3980	8'9" x 13'1"
Bedroom 3	3449 x 2737	11'4" x 9'0"
Bedroom 4	2657 x 2737	8'9" x 9'0"
Bathroom	2083 x 1710	6'10" x 5'7"

**PLEASE NOTE:**

For illustration purposes only. All dimensions are + or - 50mm and these measurements should not be used for the purchase of carpets or furniture. Please see our Sales Executive for full specification and plot details at this development.

**CONSUMER  
CODE FOR  
HOME BUILDERS**  
[www.consumercode.co.uk](http://www.consumercode.co.uk)



**FOXLOW**  
FIELDS

All enquiries:

**01298 807 512**

or email: [FoxlowFields@keepmoat.com](mailto:FoxlowFields@keepmoat.com)



[keepmoat.com](http://keepmoat.com)