

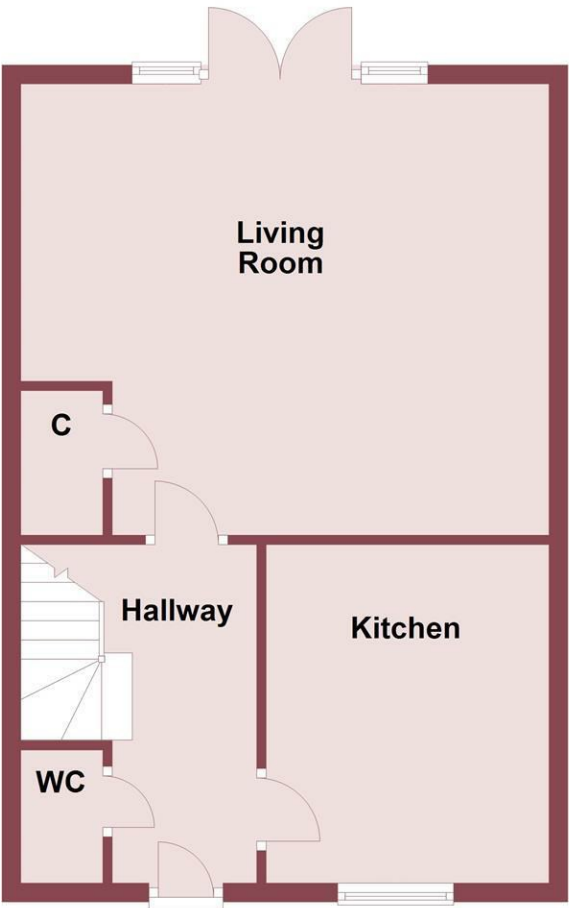

Ground Floor

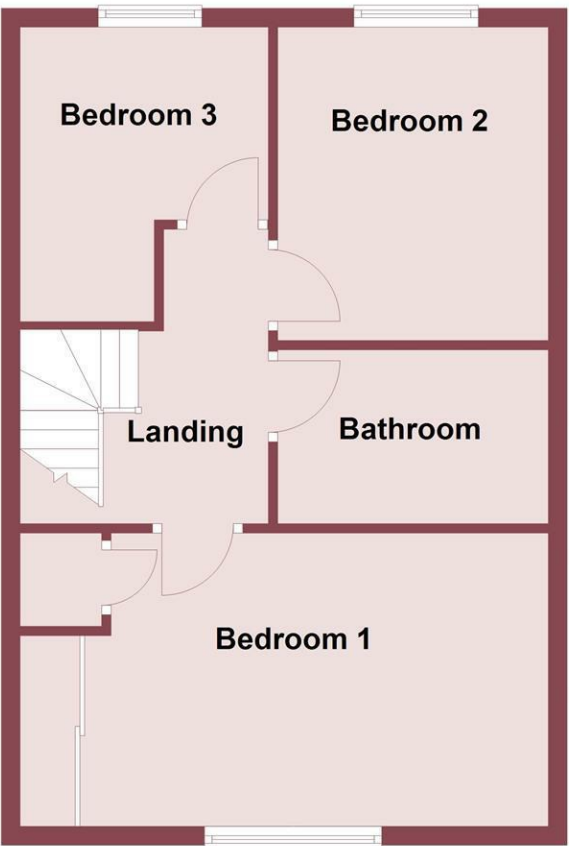

First Floor



# Dunlin Close, Neston, CH64 6UL

£213,500

3 Bedroom
 1 Reception
 1 Bathroom
 3 Bedroom

**\*\*No Onward Chain - Affordable House - Highly Regarded Location\*\***

Hewitt Adams are delighted to offer this beautifully presented, 3 bedroom, semi-detached property situated on Boundary Park - walking distance to Neston Town Centre and Parkgate. \*This property is discounted by 30% as it is part of the affordable housing scheme, making it a perfect property for First Time Buyers.

The property comprises of an entrance hall with a WC, a modern kitchen, the lounge / dining area is beautifully presented with French doors leading on to the rear garden patio. The first floor will lead you to three bedrooms and a bathroom with the main bedroom boasting fitted mirrored wardrobes.

Externally, the front of the property includes a brick set driveway providing off road parking for multiple cars, and the rear garden is designed with a decked seating area and mainly laid to lawn with secure boundaries.

\*Note: This is part of the affordable housing scheme and any potential buyer must meet the eligibility criteria set by the local council. Please see link below -

<https://www.cheshirewestandchester.gov.uk/residents/housing/accessing-affordable-housing/make-an-application>



**Hallway**

Composite front door to hallway, radiator, stairs to first floor, doors to;

**Living Room/Diner**

Double glazed patio doors leading to garden, radiator with television and telephone points, storage cupboard.

**Kitchen**

Fitted kitchen with a range of wall and base units with complementary work surfaces and tiling. Sink, gas hob, electric oven, cooker hood and fridge freezer. Central heating boiler, radiator, double glazed window to front aspect and doorway to hall.

**WC**

WC, wash hand basin, radiator.

**Landing**

Doors to;

**Bedroom 1**

Double glazed window to front aspect, built in wardrobes, radiator with television and telephone points.

**Bedroom 2**

Double glazed window to rear aspect and radiator.

**Bedroom 3**

Double glazed window to rear aspect and radiator.

**Bathroom**

Comprising; Bath with shower, extractor fan and part tiling, wash hand basin, WC and radiator.

