

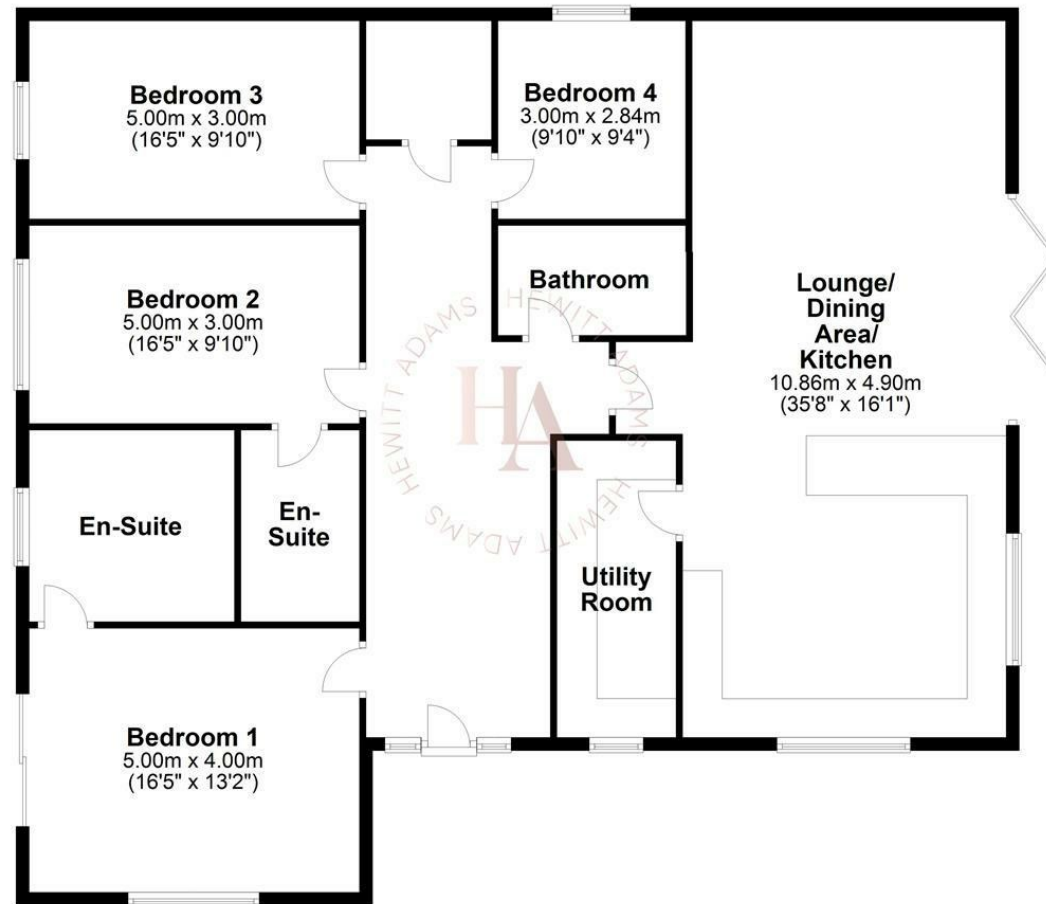

Ground Floor

Approx. 172.4 sq. metres (1855.8 sq. feet)



Total area: approx. 172.4 sq. metres (1855.8 sq. feet)
For illustration purposes only - not to scale

Lees Lane, Neston, Cheshire CH64 7TH
Offers In Excess Of £550,000

4 Bedroom 2 Reception 3 Bathroom

****LAND WITH PLANNING PERMISSION - SOUGHT AFTER NESTON LOCATION - LARGE PLOT****

Land with full planning permission granted for a detached bungalow with 4 double bedrooms. This is perfect for someone seeking tranquility and privacy. The building plot is located down a quiet country lane with gated access down a long private driveway.

There is direct access from the plot to the Wirral Way, where walks can be enjoyed. This access is also perfect for anyone who has a horse and wants access directly on to the Wirral Way.

These CGI images illustrate beautifully what the finished bungalow could look like. The building plot measures approximately 30m x 40m, which easily accommodates the large detached four-bedroom bungalow. There is enough space to landscape the gardens to a standard that complements the size of this dwelling.

As well as a sizable building plot - There is also an orchard, back paddock and front paddock. Not to mention the long sweeping driveway. The overall size of the land and plot together is approximately 2 acres.

Viewings can be arranged to appreciate the size, privacy and peacefulness of this location. All information related to the planning can be found by following the planning reference link - Planning

