



Latimer Road

North Kensington, W10



£6,000 pcm

Latimer Road

North Kensington, W10

Set in a row of picturesque Victorian cottages, this beautiful, completely refurbished 4 bedroom house has been elegantly extended and brought into modern day living. With bright open spaces and wooden floors, the ground floor benefits from a generous eat-in kitchen with concertina doors leading to a smart patio garden. The spacious reception room presents as a blank canvas allowing one to place their own style and create a home. Upstairs is the master bedroom, shower room, 3 further bedrooms and a sumptuous family bathroom.

- Newly Refurbished
- Eat-in Kitchen
- Centrally Located
- Modern Living





Latimer Road

North Kensington, W10

Latimer Road is located a short distance from a wide range of attractive amenities including shops, post office, cafes and restaurants as well as Portobello Road, Golborne Road and the wide open spaces of Wormwood Scrubs.

Council Tax band: E

EPC Energy Efficiency Rating: E

EPC Environmental Impact Rating: E

Latimer Road, W10

Approx. Gross Internal Area = 155.5 sq m / 1674 sq ft
 Eaves Storage = 7.3 sq m / 78 sq ft
 Total = 162.8 sq m / 1752 sq ft



= Reduced headroom below 1.5 m / 5'0"

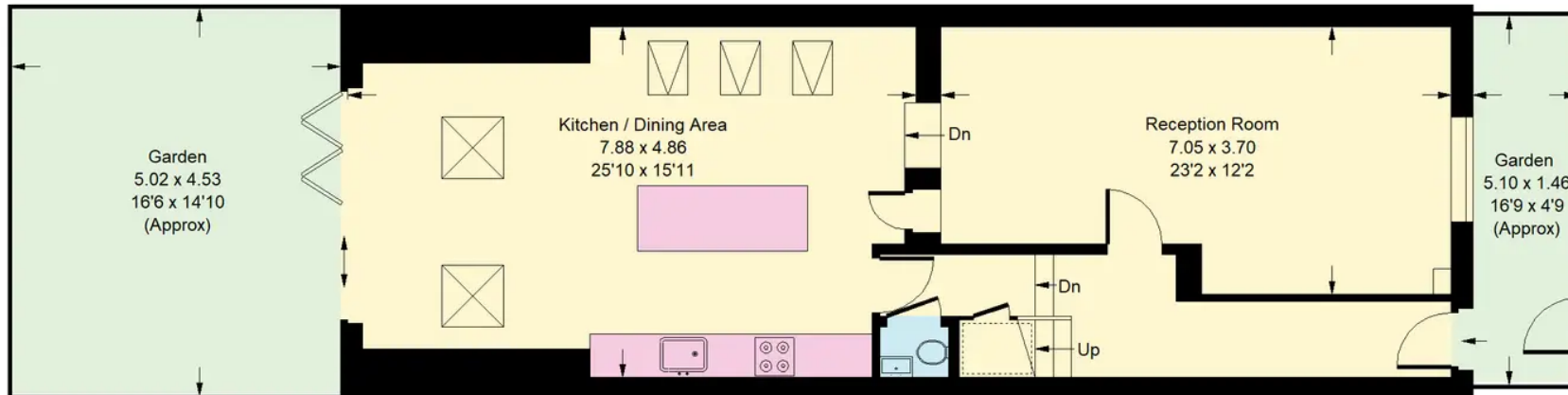
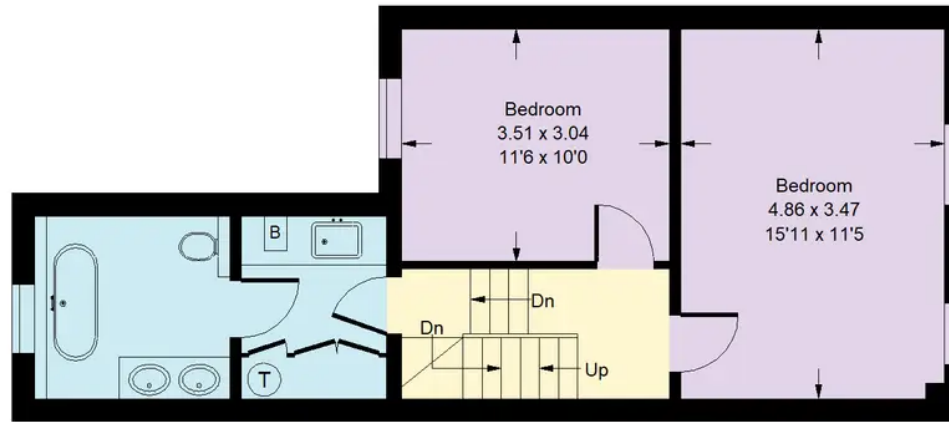

Ground Floor

Whilst every attempt has been made to ensure the accuracy of the floor plan, measurements are approximate and not to scale.
 No guarantee is given on the total square footage of the property quoted on the plan. Figures given are for guidance.
 Plan is for illustration purposes only, not to be used for valuations.



Rigby & Marchant

115 Westbourne Studios 242 Acklam Road, London - W10 5JJ

020 7221 7210

info@rigbyandmarchant.co.uk

www.rigbyandmarchant.co.uk/

