

Christchurch Avenue

Queen's Park, NW6

£2,817 PCM

RIGBY & MARCHANT

A smart and very well presented ground floor flat is available to let in W6 Queen's Park. A wonderful modern apartment which is flooded with natural light and well equipped which is ideal for the short stay. Your home away from home.

Christchurch Avenue benefits from all the local amenities of Queen's Park and Kilburn. Transport links include Brondesbury Park Overground, Kilburn Underground Station on the Jubilee line and Queen's Park for the Bakerloo line.

Tenure: Leasehold

EPC Energy Efficiency Rating: C

EPC Environmental Impact Rating: C



Approx. Gross Internal Area
45.2 sq m / 486 sq ft

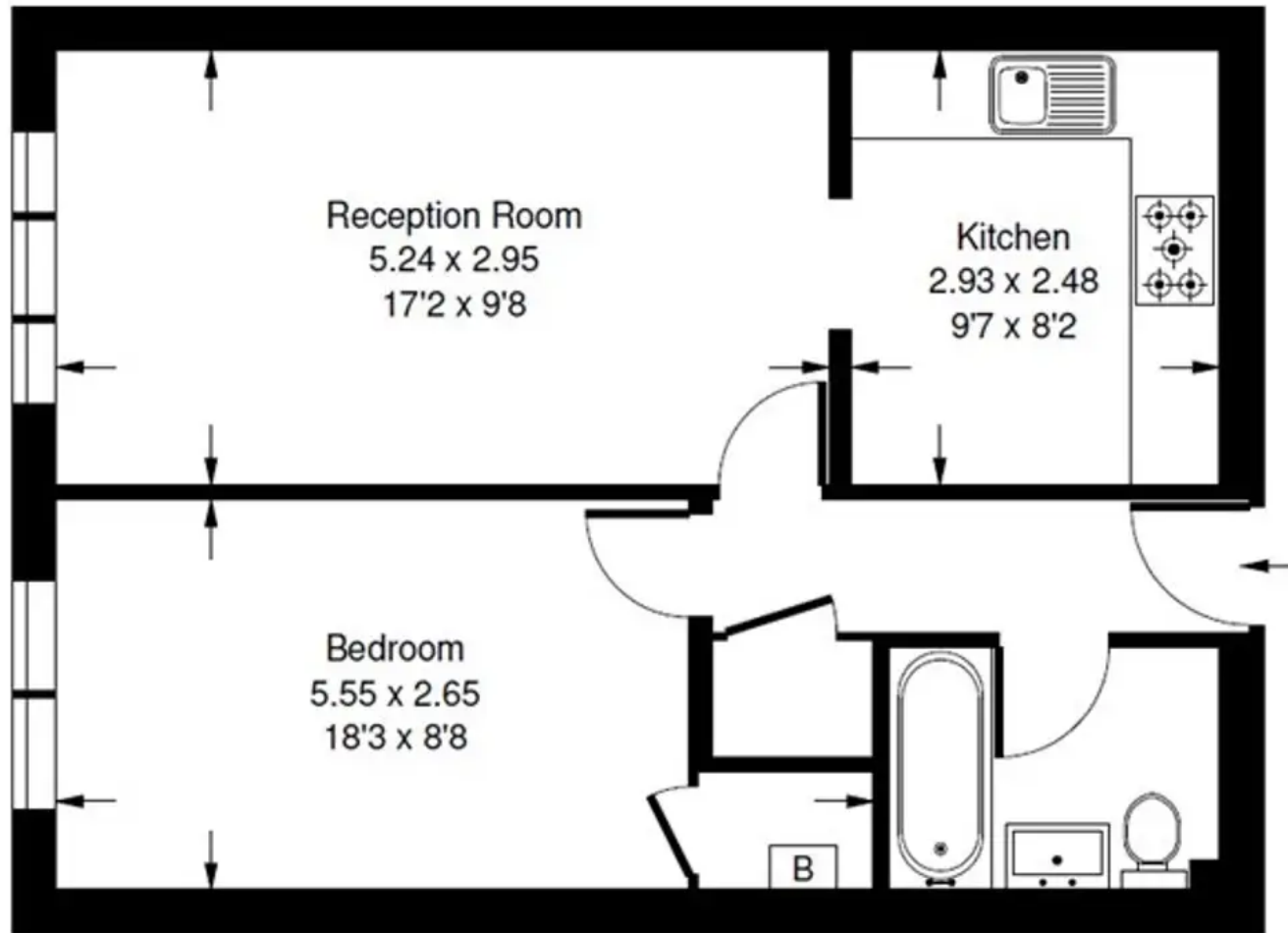

Ground Floor

Whilst every attempt has been made to ensure the accuracy of the floor plan, measurements are approximate and not to scale.
No guarantee is given on the total square footage of the property quoted on the plan. Figures given are for guidance.
Plan is for illustration purposes only, not to be used for valuations.



Rigby & Marchant

115 Westbourne Studios 242 Acklam Road, London - W10 5JJ

020 7221 7210

sales@rigbyandmarchant.co.uk

www.rigbyandmarchant.co.uk/

**RIGBY &
MARCHANT**



Rigby & Marchant

115 Westbourne Studios 242 Acklam Road, London - W10 5JJ

020 7221 7210

sales@rigbyandmarchant.co.uk

www.rigbyandmarchant.co.uk/

**RIGBY &
MARCHANT**