



A ESTATE AGENTS
— OF —
GLOUCESTERSHIRE



, THE GABLES, STANDISH LANE, MORETON VALENCE, STONE, GL2 7LZ

The Property

This is a delightful example of a 1920's detached home with views to open fields set in lovely grounds we believe to be in the region of 0.25 of an acre. The owners have enjoyed the house for nearly 20 years. They have invested over the years in extending and modernising the property throughout to create a lovely home. Complimented by proportioned grounds for all the family to enjoy.

On approach picket fencing with five bar gates leads onto a chipping driveway providing a wealth of parking up to a detached double garage. Pedestrian gate with pathway leading up to the front entrance.

Internally into the entrance hall, stairs lead to the first floor. A very good-sized snug or bedroom four with views to the front. A family sitting room with a lovely fireplace and log burner inset taking centre stage with views to two elevations over the grounds and fields. A dining room with French doors opening to a sun terrace and lawns. Stone flooring through these rooms and hallway

A delightful, fitted kitchen/breakfast room with a range of base and wall mounted cabinets. Space for dining table and chairs. Space for all appliances.

Opening to very spacious utility/boot room with a range of built in cabinets, washing machine and tumble drier. Door to downstairs cloakroom with window to the side. Natural stone flooring through this area. A lovely open timber framed porch to the rear with access to the driveway and grounds. Perfect for a busy family with children and pets.

To the first floor a master bedroom suite with windows to two elevations to take advantage of the lovely open views, free standing wardrobes and complimented by a beautifully presented en-suite shower room. Two further double bedrooms all having a wealth of natural light.

A stunning four-piece family bathroom with a roll top bath taking centre stage and lovely double shower, all finished with great attention to detail, in grey and white tiles to floor and walls.

Beautifully presented throughout. The internal space flows with ease and provides versatile living space.





Outside

Outside

The grounds surround the property with open lawns and wealth of shrubs planted. Flat lawns provide space for all the family to enjoy.

The current owners run a very successful cattery within the grounds all securely presented to include an office. This provides a second income, if of interest can be discussed with the owners. (Running of the cattery is subject to being accepted and obtaining a license through the local council.

Sitting on the edge of three lovely local villages and having an ease of access to both Junction 12 & 13 of the M5 motorway. We believe the grounds are within 0.25 of an acre plot.

The property also has no direct neighbours allowing for a great amount of privacy and open fields to the rear and side.



Useful Information

Tenure: Freehold

Viewing arrangements: Strictly by appointment through AJ Estate Agents

Fixtures and Fittings: Some items mentioned within the sales particulars are included, all others are specifically excluded. They may be available by separate negotiation.

Local Authorities: SDC. Council Tax Band E and EPC rating D





Location

Moreton Valance sits on the edge of a small hamlet and sits in close proximity to Whitminster. Whitminster is a small village on the outskirts of Gloucester with a local pub, hotel, village store, various takeaway outlets and Highfield Garden World with restaurant. A popular village primary school and playing fields are in the village. Along with a village hall.

Located within a short distance to the M5 at junction 13 and 12, ideal for commuting to Bristol, Birmingham. With an ease of access to the lovely villages of Eastington & Frampton On Severn.

A short drive to Gloucester, Stonehouse and Stroud where you will find a wealth of shopping and leisure facilities. Superb links to railway stations at Cam and Stonehouse that provide direct trains to London and Bristol.. All making this a great location for commuters and family life.



Directions

From junction 13 of M5, turn towards towards Frampton and Dursley off the motorway, At the roundabout take third turning on the A38 towards Gloucester. Carry on past the garden center on the left and through the traffic lights. continue along the A38 passing the sign on the left for Moreton Valance, take the next right hand turning sign posted for Standish. the house is on the right hand side with a a five bar gate and chipings driveway.



The Gables, Standish Lane, Moreton Valence, Gloucester, GL2

Approximate Area = 1763 sq ft / 163.7 sq m

Garage = 315 sq ft / 29.2 sq m

Total = 2078 sq ft / 192.9 sq m

For identification only - Not to scale

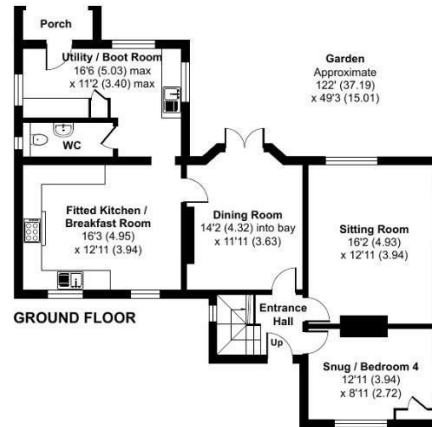
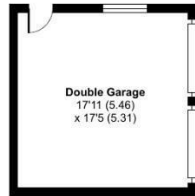

Garden
Approximate
122' (37.19)
x 49'3 (15.01)



Floor plan produced in accordance with RICS Property Measurement Standards incorporating International Property Measurement Standards (IPMS2 Residential). © nlichecom 2024. Produced for AJ Estate Agents of Gloucestershire. REF: 1077642

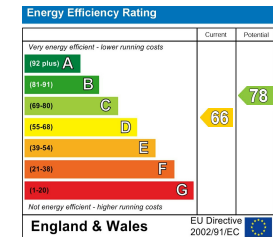

01453 703303
homes@ajeaglos.co.uk
www.ajeaglos.co.uk
rightmove



If you require any particulars in an alternative format, please contact AJ Estate Agents of Gloucs Ltd on 01453 703303. We will do all we can to accommodate. IMPORTANT NOTICE: AJ Estate Agents of Gloucs Ltd, their client/s and any joint agents give notice that: 1. They are not authorised to make or give any representations or warranties in relation to the property either here or elsewhere, either on their own behalf or on behalf of their client/s or otherwise. They assume no responsibility for any statement that may be made in these sales particulars. Sales particulars do not form part of any offer or contract and must not be relied upon as statements or representation of facts. 2. Any areas, measurements or distances are approximate. The written wording, photographs and plans are purely for guidance only and are not necessarily comprehensive. It is not to be assumed that the property has all necessary planning, building regulations or other consents and AJ Estate Agents of Gloucs Ltd have not tested any services, equipment, or facilities. Purchasers must satisfy themselves by inspection or otherwise.