



2 Starlings Bridge Nightingale Road , Hitchin, SG5 1QW

Located at the bottom of Nightingale Road in Hitchin, this ground floor maisonette is in an ideal location between the Train station and the town centre.

The property comprises of a spacious open plan reception, kitchen, and dining area, with patio doors to a small outside space. The master bedroom has an en-suite shower room. There is a second bedroom with a separate family bathroom with a shower over the bath.

This property also comes with the added benefit of an allocated parking space, a rare find in such a desirable location. Council Tax Band C. Viewing highly recommended.

£1,500 Per month

2 Starlings Bridge Nightingale Road , Hitchin, SG5 1QW

 2

 2

 1





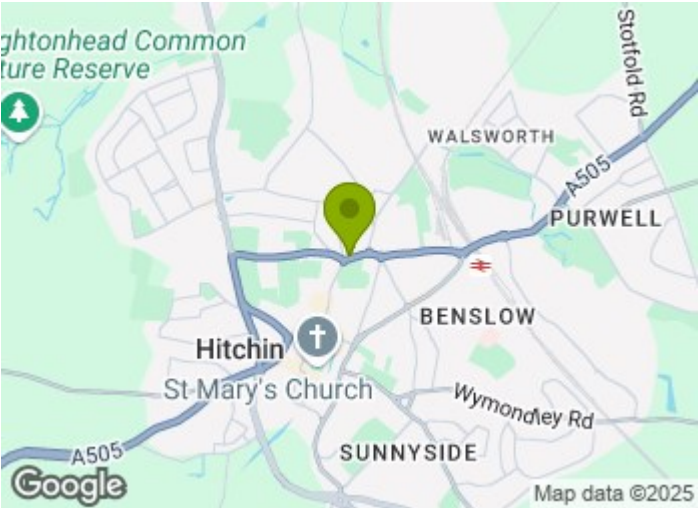

[Directions](#)



GROUND FLOOR
750 sq.ft. (69.7 sq.m.) approx.

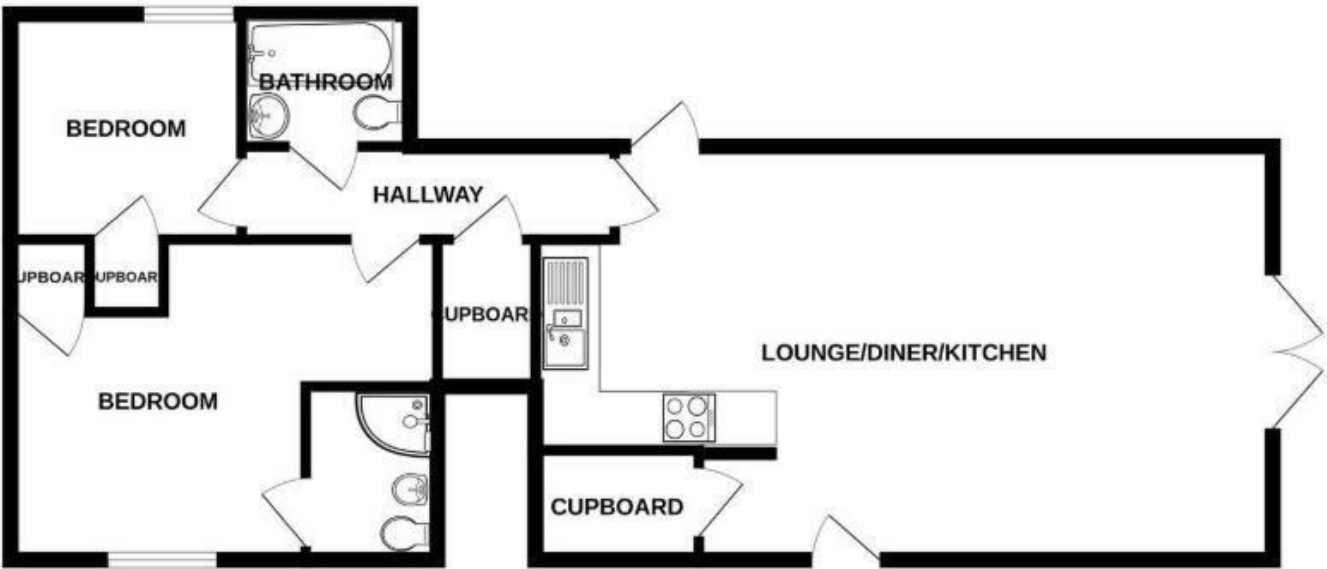

TOTAL FLOOR AREA : 750 sq.ft. (69.7 sq.m.) approx.
Whilst every attempt has been made to ensure the accuracy of the floorplan contained here, measurements of doors, windows, rooms and any other items are approximate and no responsibility is taken for any error, omission or mis-statement. This plan is for illustrative purposes only and should be used as such by any prospective purchaser. The services, systems and appliances shown have not been tested and no guarantee as to their operability or efficiency can be given.
Made with Metropix ©2025.

Every care has been taken with the preparation of these particulars, but complete accuracy cannot be guaranteed. If there is any point, which is of particular importance to you, please obtain professional confirmation. Alternatively, we will be pleased to check the information for you. These Particulars do not constitute a contract or part of a contract. All measurements quoted are approximate. The Fixtures, Fittings & Appliances have not been tested and therefore no guarantee can be given that they are in working order. Photographs are reproduced for general information and it cannot be inferred that any item shown is included in the sale.

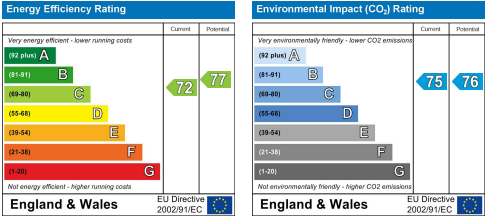

Green Door
3 Maiden Street
Weston
Hitchin Hertfordshire,
SG4 7DG
info@greendoorpm.co.uk
call 01462 510765
www.greendoorpm.co.uk

