



# GREENDOOR

PROPERTY MANAGEMENT



## 24 Farthing Drive , Letchworth Garden City, SG6 2TR

Green Door are delighted to present a modern five bedroom detached family home located on the sought after Lordship Farm Estate. Downstairs the property consists of a spacious lounge, conservatory and recently fitted kitchen, separate utility room and downstairs WC. Whilst upstairs there is a very spacious master bedroom with en-suite and four further bedrooms some with beautiful views over the countryside plus a well fitted family bathroom. The property has an enclosed rear garden and at the front of the property there is driveway parking for two cars and a double garage. The property has a gas boiler and central heating and is connected to all mains services.

Pets considered

Council tax band E. Available August 2024

**£2,300**

# 24 Farthing Drive

, Letchworth Garden City, SG6 2TR



[Directions](#)





# Floor Plan

## Master Floorplan Image

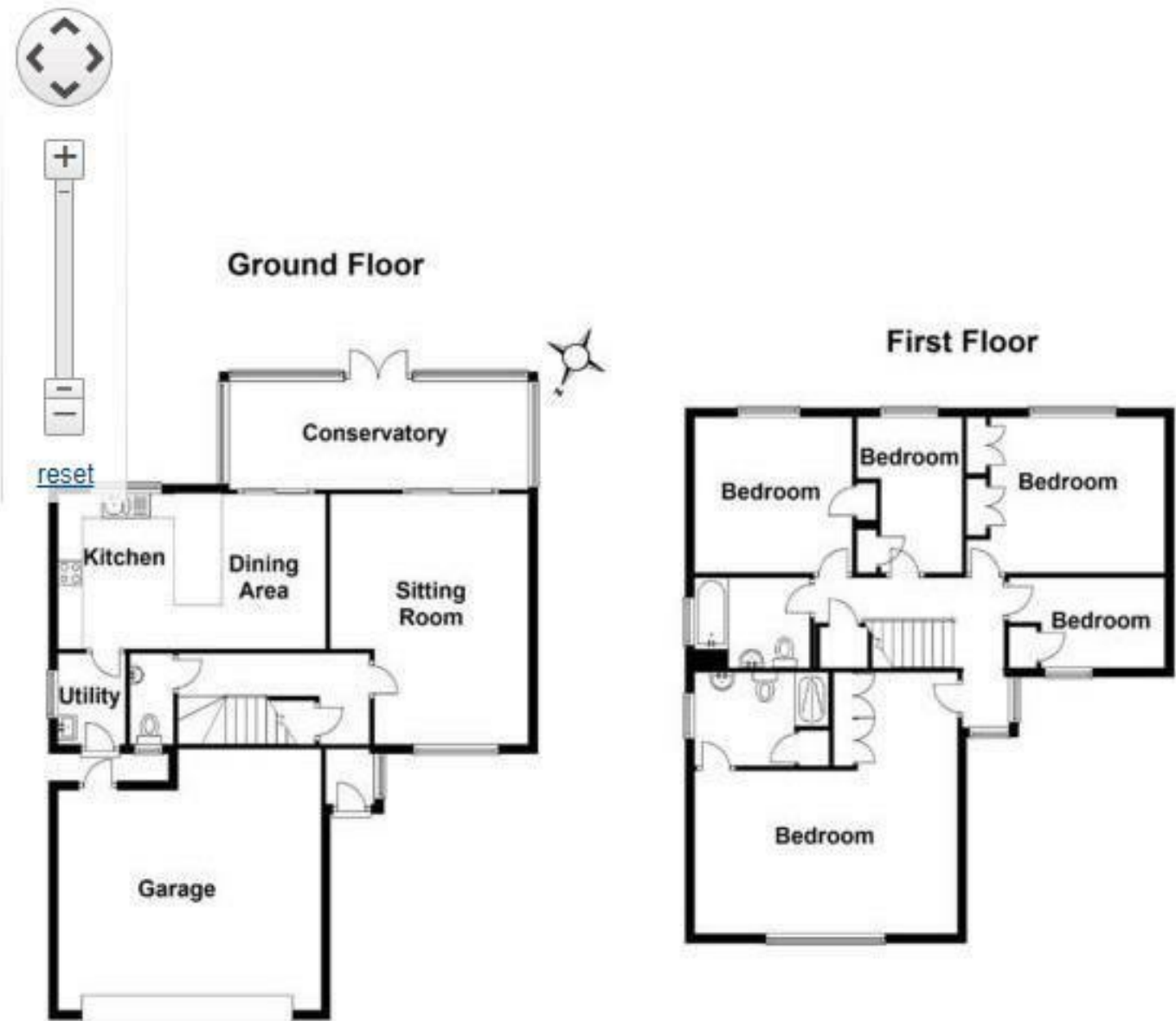

These particulars, whilst believed to be accurate are set out as a general outline only for guidance and do not constitute any part of an offer or contract. Intending purchasers should not rely on them as statements of representation of fact, but must satisfy themselves by inspection or otherwise as to their accuracy. No person in this firm's employment has the authority to make or give any representation or warranty in respect of the property.

