



Linmere Area Masterplan

4 Bedroom Homes

-  **The Aspen**
Plots 31, 32, 33, 34, 40, 41, 42 & 43
-  **The Alnwick**
Plots 22, 35 & 64

3 Bedroom Homes

-  **The Wainwright**
Plots 36, 37, 38, 39, 62, 63, 65, 66, 67, 68, 123, 124, 128 & 129
-  **The Cedar**
Plots 23, 25, 26, 27 & 28
-  **The Maple**
Plot 125
-  **The Chestnut**
Plots 20, 21, 24, 29, 82, 83, 122, 126, 127, 130 & 131
-  **The Oak**
Plots 30, 121 & 132
-  **The Quilter**
Plot 135
-  **The Wharfe**
Plots 69 & 70
-  **The Thespian**
Plots 106, 116, 117 & 133
-  **The Turner**
Plots 14, 15, 16, 17, 18, 19, 84, 85, 86, 100, 101, 102, 103, 104, 114, 115, 119, 120, 134, 136, 137, 138, 139, 148 & 149
-  **The Tailor**
Plots 98, 99, 105, 112, 113, 118, 146 & 147

2 Bedroom Homes

-  **The Saddler**
Plots 13, 61, 71, 81, 87 & 97

Apartments

-  **The Marston Apartments**
Plots 1-12
-  **The Linslade Apartments**
Plots 44-49
-  **The Heartwood Apartments**
Plots 50-60
-  **The Whipsnade Apartments**
Plots 72-80
-  **The Aldenham Apartments**
Plots 88-96





Affordable Homes

- 

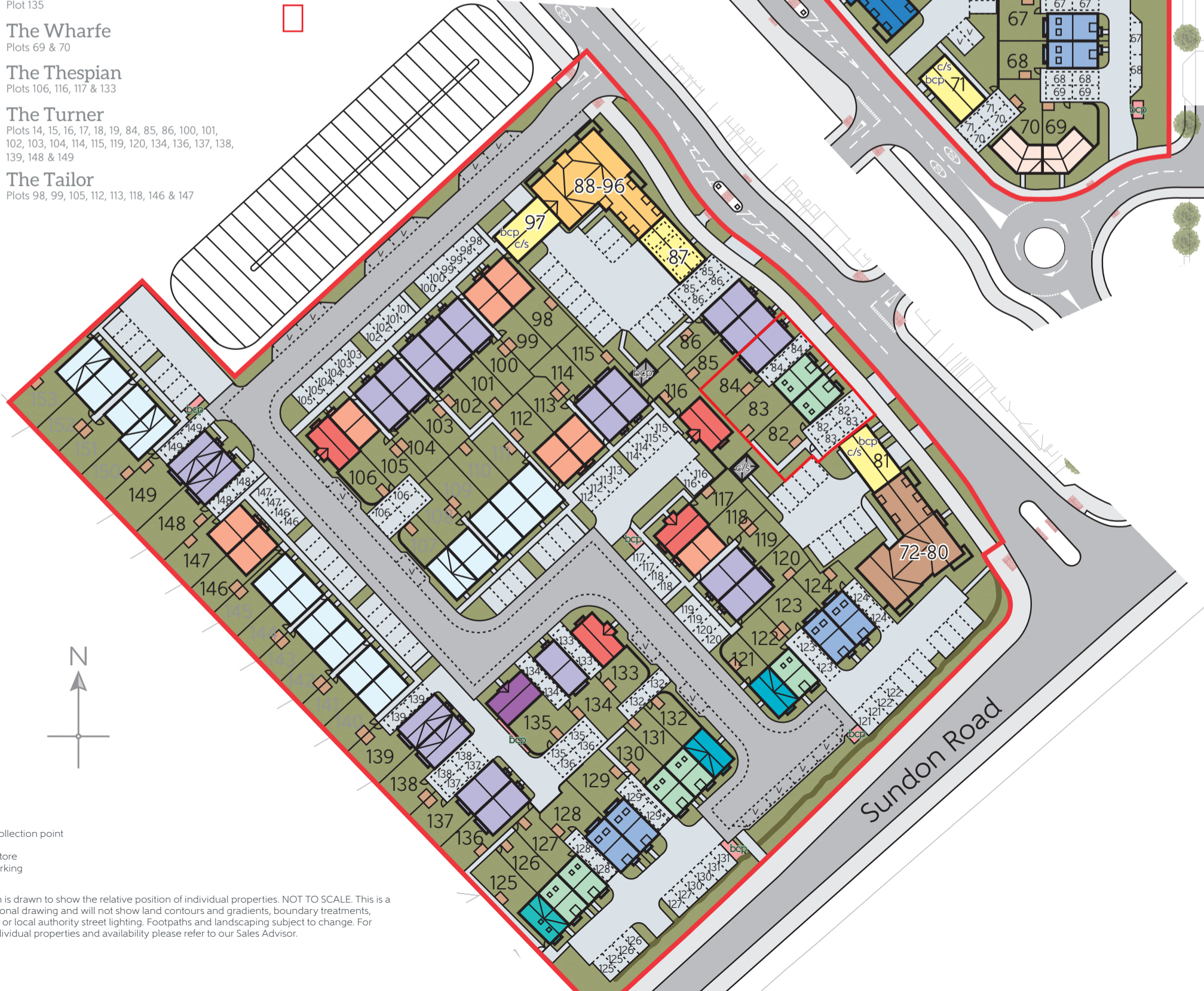
Show Home and Sales Area

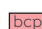
- 



-  - Bin collection point
-  - Shed
-  - Cycle Store
-  - Visitor parking

The site plan is drawn to show the relative position of individual properties. NOT TO SCALE. This is a two dimensional drawing and will not show land contours and gradients, boundary treatments, landscaping or local authority street lighting. Footpaths and landscaping subject to change. For details of individual properties and availability please refer to our Sales Advisor.