



9 Cater Road, Lane End, Buckinghamshire, HP14 3JD - £375,000

Located in a walkway position is this improved three bedroom end of terraced home.

Storm Porch | Entrance Hall | Cloakroom | Lounge/Dining Room | Modern Fitted Kitchen | First Floor Landing | Three Bedrooms | Family Bathroom | Gas Heating To Radiators | Double Glazing | Residents Parking |

A popular style of property that overlooks a small green to the front and well located for local amenities. The accommodation comprises storm porch, entrance hall with small study area, refitted modern cloakroom/W.C., lounge/dining room with box bay overlooking front garden and double doors opening to garden, refitted kitchen with integral appliances, first floor landing, three good size bedrooms, family bathroom, double glazing, gas heating to radiators, well kept gardens to front and rear and residents parking to rear.

Price... £375,000

Freehold

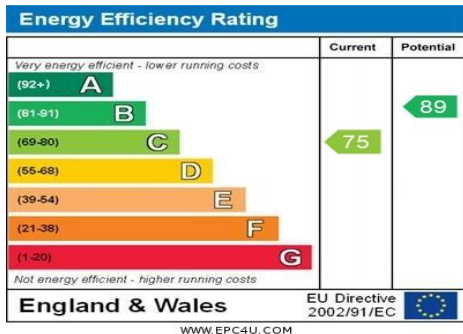

LOCATION

Situated in the village of Lane End approximately 5 miles from High Wycombe and 5 miles from Thameside Marlow. The village provides a good range of facilities, local school and buses connect Lane End with High Wycombe, from where there is a 25 minute rail service to London Marylebone as well as direct links to Oxford and Birmingham. Chiltern countryside literally surrounds Lane End, while in contrast, junctions 4 and 5 of the M40 are reached in about ten minutes.



DIRECTIONS

Enter Lane End from the Stokenchurch direction on Finings Road B482. Continue through the village centre passing by the pond then take the second turning left into Simmons Way. Cater Road is the third turning on the left. The property is located on the left behind the car park.



ADDITIONAL INFORMATION

EPC Rating

C

Council Tax

Band C

MORTGAGE

Contact your local Wye Residential office who can introduce you to their Independent Financial Adviser

Whilst we endeavour to make our sales details accurate and reliable they should not be relied on as statements of representation of fact and do not constitute any part of an offer or contract.



Approx Gross Internal Area
84 sq m / 909 sq ft

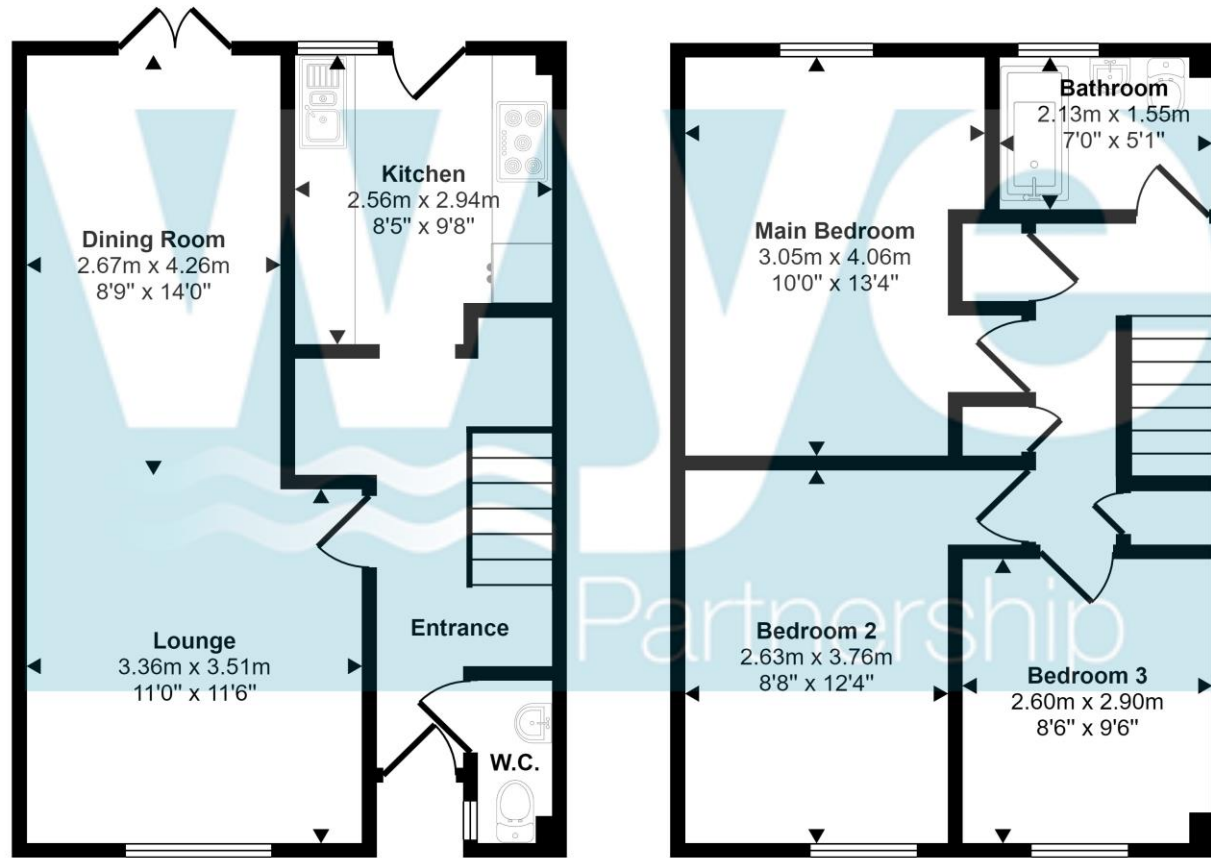

Ground Floor
Approx 42 sq m / 448 sq ft

First Floor
Approx 43 sq m / 461 sq ft

This floorplan is only for illustrative purposes and is not to scale. Measurements of rooms, doors, windows, and any items are approximate and no responsibility is taken for any error, omission or mis-statement. Icons of items such as bathroom suites are representations only and may not look like the real items. Made with Made Snappy 360.