

Floor Plan

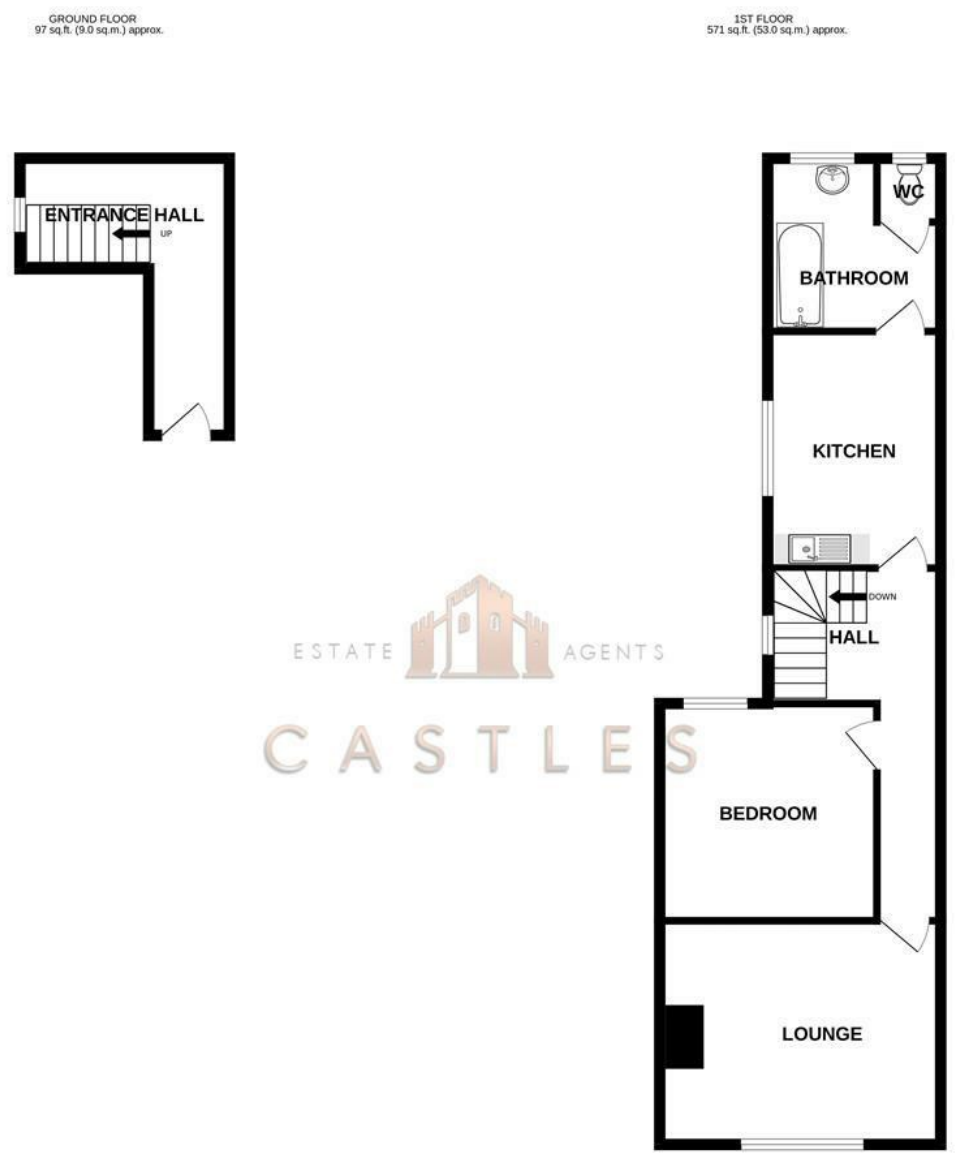

TOTAL FLOOR AREA : 667 sq.ft. (62.0 sq.m.) approx.

Whilst every attempt has been made to ensure the accuracy of the floorplan contained here, measurements of doors, windows, rooms and any other items are approximate and no responsibility is taken for any error, omission or mis-statement. This plan is for illustrative purposes only and should be used as such by any prospective purchaser. The services, systems and appliances shown have not been tested and no guarantee as to their operability or efficiency can be given.

Made with Metropix ©2025

These particulars, whilst believed to be accurate are set out as a general outline only for guidance and do not constitute any part of an offer or contract. Intending purchasers should not rely on them as statements of representation of fact, but must satisfy themselves by inspection or otherwise as to their accuracy. No person in this firms employment has the authority to make or give any representation or warranty in respect of the property.

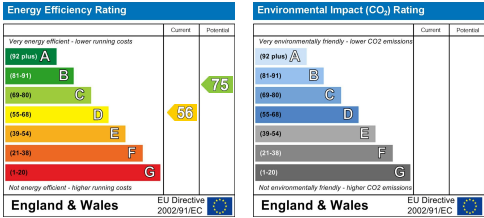

107a New Road
Portsmouth, PO2 7QN

We are pleased to welcome to the market this one bedroom first floor apartment being offered with Share Of Freehold located in New Road, Portsmouth.

The property is a fair size and the accommodation consists of a private entrance and stairwell up to the flat. There is a large lounge to the front of the property with a fire place, double bedroom with built in storage, kitchen and bathroom.

The property would make a great first time purchase and is a short walk to transport links and local shops.

For more information or to arrange a viewing please call Castles today.

Asking price £115,000

DIRECTORS

CHARLES TUSON • GARY AGAR • SEAN WREN



1 CASTLE STREET
PORTCHESTER
PO16 9QD



02394318899



CHARLES@CASTLESESTATES.CO.UK
GARY@CASTLESESTATES.CO.UK
SEAN@CASTLESESTATES.CO.UK

COMPANY NUMBER: 12821075 • VAT NUMBER: 356389459

107a New Road
Portsmouth, PO2 7QN



- SHARE OF FREEHOLD
- FIRST FLOOR FLAT
- GENEROUS SIZE
- DOUBLE BEDROOM
- CLOSE TO LOCAL SHOPS
- IDEAL FIRST TIME BUY

LOUNGE
14'5" x 11'5" (4.4 x 3.5)

KITCHEN
8'10" x 12'1" (2.7 x 3.7)

BATHROOM
8'10" x 8'10" (2.7 x 2.7)

BEDROOM
11'1" x 12'1" (3.4 x 3.7)

Financial Services
If you are looking to get a comparison on your mortgage deal then do let us know as we can put you in touch with some independent mortgage advisors that would be

happy to help. It is always worth a last minute comparison before you purchase a property as the current deals can change weekly.

Solicitors
If you are looking for a solicitor to handle the conveyancing process then do let us know as we can point you in the direction of some local, well recommended companies that would be happy to help and provide you with a quote.

Anti Money Laundering
Castles Estate Agents have a legal obligation to complete anti-money

laundering checks at our cost via a portal called Credas. Please note the Credas AML check includes taking a copy of identification for each purchaser, a proof of address and proof of name document is required. Please note we cannot agree a transaction without the Credas AML check being completed and there will be a small admin fee of £25+VAT charged to the successful purchasers to complete these legally required checks.

