

Floor Plan

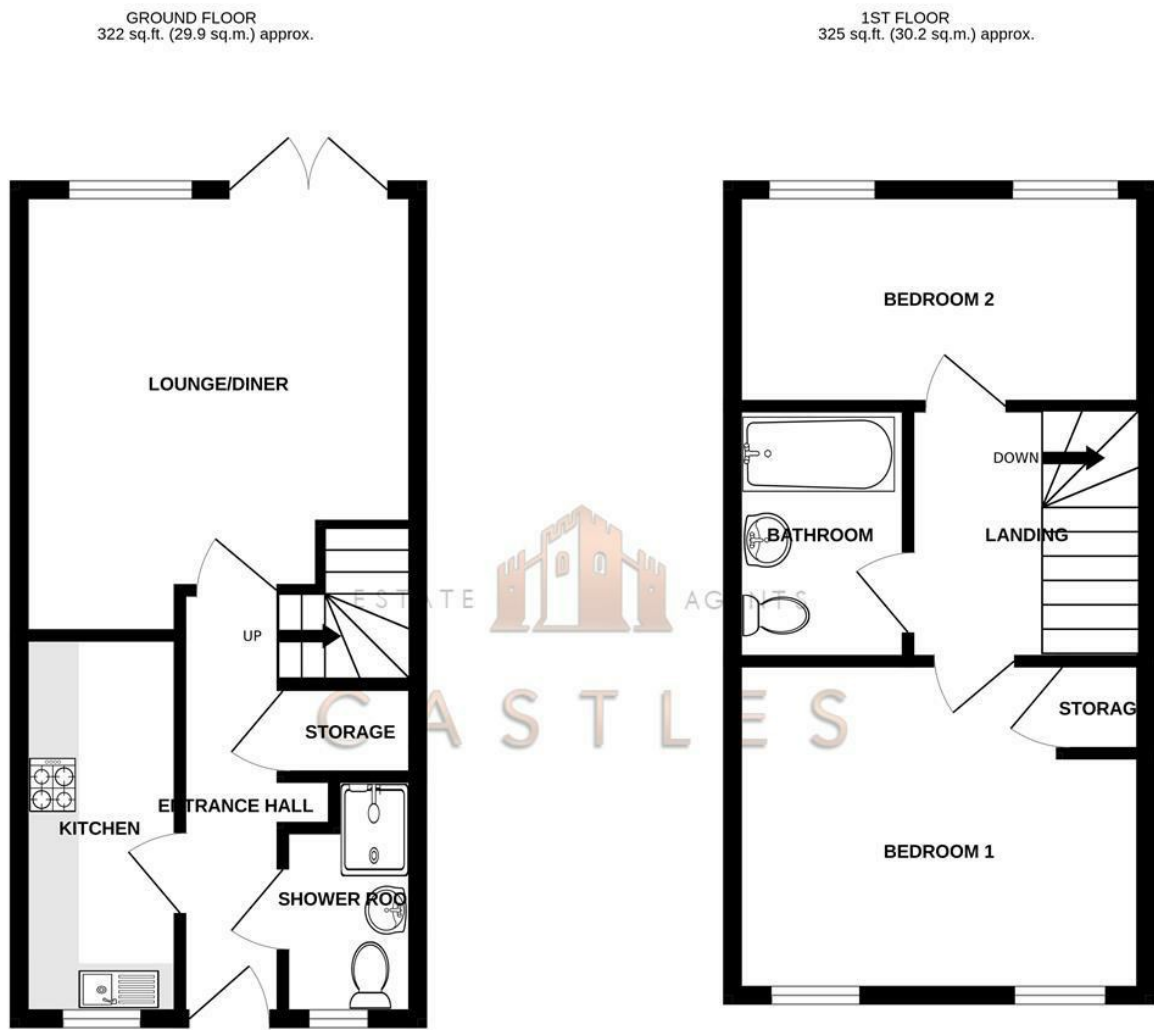

TOTAL FLOOR AREA : 647 sq.ft. (60.1 sq.m.) approx.

Whilst every attempt has been made to ensure the accuracy of the floorplan contained here, measurements of doors, windows, rooms and any other items are approximate and no responsibility is taken for any error, omission or mis-statement. This plan is for illustrative purposes only and should be used as such by any prospective purchaser. The services, systems and appliances shown have not been tested and no guarantee as to their operability or efficiency can be given.

Made with Metropix ©2025

These particulars, whilst believed to be accurate are set out as a general outline only for guidance and do not constitute any part of an offer or contract. Intending purchasers should not rely on them as statements of representation of fact, but must satisfy themselves by inspection or otherwise as to their accuracy. No person in this firms employment has the authority to make or give any representation or warranty in respect of the property.

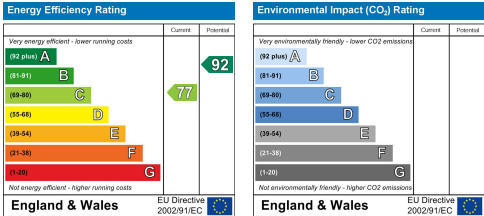

8 Consort Court High Street  
Fareham, PO16 7AP

We are pleased to welcome to the market this two bedroom mid terrace property located in High Street Fareham.

The property is well presented throughout and has just bee recently decorated.

The ground floor consists of a kitchen and shower room to the front of the property with an open plan lounge diner to the rear with french doors opening on to a courtyard garden.

Moving upstairs there are two double bedrooms and a family bathroom.

This property would make a great first time buy for anyone looking to get their foot onto the ladder.

The shops of Fareham are literally round the corner and Fareham Train Station is a short walk away.

For more information or to arrange a viewing please call Castles today.

Offers over £225,000



8 Consort Court High Street  
Fareham, PO16 7AP

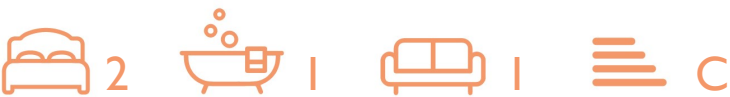

- TWO BEDROOMS
- CLOSE TO SHOPS
- RECENTLY DECORATED
- TWO BATHROOMS
- SHORT WALK TO TRAIN STATION
- PERFECT FIRST TIME BUY

**KITCHEN**  
4'11" x 12'1" (1.5 x 3.7)

**LOUNGE/DINER**  
12'5" x 13'9" x 11'5" (3.8 x 4.2 x 3.5)

**SHOWER ROOM**  
3'7" x 5'10" (1.1 x 1.8)

**BATHROOM**  
5'6" x 7'10" (1.7 x 2.4)

**BEDROOM 1**  
12'9" x 10'5" (3.9 x 3.2)

**BEDROOM 2**  
12'5" x 6'6" (3.8 x 2.0)

**Financial Services**  
If you are looking to get a comparison on your mortgage deal then do let us know as we can put you in touch with some

independent mortgage advisors that would be happy to help. It is always worth a last minute comparison before you purchase a property as the current deals can change weekly.

**Solicitors**  
If you are looking for a solicitor to handle the conveyancing process then do let us know as we can point you in the direction of some local, well recommended companies that would be happy to help and provide you with a quote.

**Anti Money Laundering**  
Castles Estate Agents have a legal obligation to complete anti-money laundering checks at our cost via a portal called Credas. Please note the Credas

AML check includes taking a copy of identification for each purchaser, a proof of address and proof of name document is required. Please note we cannot agree a transaction without the Credas AML check being completed and there will be a small admin fee of £25+VAT charged to the successful purchasers to complete these legally required checks.

