



Glebe Close, Thetford

Glebe Close

Thetford

Welcome to your dream home! This charming three-bedroom mid-terrace property effortlessly combines modern living with classic charm. As you step through the useful porch entrance, you'll immediately notice the exquisite geometric tiled flooring, which seamlessly extends into the cottage-style kitchen. This space is perfect for storing pushchairs, coats, and shoes, and even includes a personal door into the garage, offering potential for conversion (subject to consents), complete with a sink and plumbing for a washing machine.

Council Tax band: A

Tenure: Freehold

- Extended ground floor accommodation
- Landscaped garden with artificial lawn and non slip decking
- Overlooking a green to the rear
- Cosy woodburner in the lounge
- Three double bedrooms
- Garage and driveway parking
- Great location for access to town and amenities
- Modern cottage style kitchen
- Further potential for garage conversion (subject to necessary consents/approvals)
- Chain free sale!





Glebe Close

Thetford

The kitchen itself is a delightful blend of functionality and style, featuring handleless doors and drawers, butcher block effect work surfaces, and a ceramic sink unit. Equipped with a built-in electric oven, hob, and extractor, plus space for a tall standing fridge/freezer, this kitchen is ready to cater to all your culinary needs.

A hallway leads you into the heart of the home where the living accommodations shine. Cleverly extended to the rear, this open-plan space is ideal for family gatherings and relaxation. The lounge area, with its cosy woodburner, promises warmth and ambiance on cold winter evenings, while the versatile layout allows for flexible furniture arrangements to suit your lifestyle.

Beyond the lounge, the dining and family areas await. The dining space comfortably seats six and includes a convenient area perfect for working from home. Adjacent, you'll find a dedicated play area for children, all bathed in natural light from the French-style doors that open to the rear garden.

On the first floor, the landing offers practical storage solutions, with three generously sized double bedrooms, each boasting built-in storage. The bathroom is a modern sanctuary, featuring a white suite with a panel bath, marble effect tiled surround, rainwater head shower, separate mixer riser, pedestal wash basin, and WC.



Glebe Close, Thetford, IP24

Approximate Area = 1090 sq ft / 101.2 sq m

Garage = 144 sq ft / 13.3 sq m

Total = 1234 sq ft / 114.5 sq m

For identification only - Not to scale

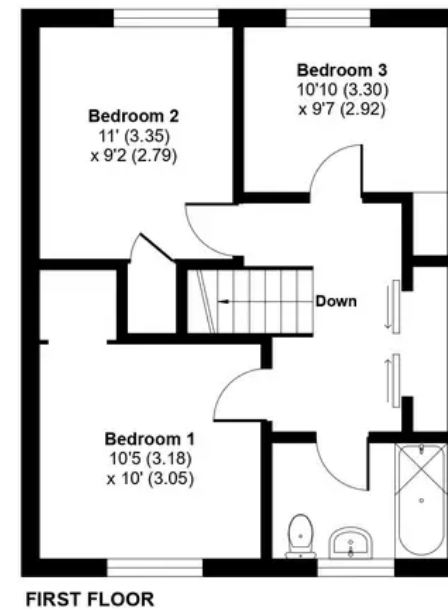

Front Garden

The exterior of this property is equally impressive. The front garden is gravelled for low maintenance, with driveway parking leading to the garage.

Rear Garden

The recently landscaped rear garden, with new fencing, artificial lawn, and a non-slip decked area, is a northwest-facing haven perfect for evening sunsets. The garden opens directly onto a green, providing a perfect play area for children and ensuring the property is not overlooked.

Garage

Single Garage

Driveway

2 Parking Spaces

Located in a prime spot for easy access to the town and amenities, this home is chain-free and ready for you to move in and make your own. With further potential for a garage conversion (subject to necessary consents), this property offers a unique blend of modern convenience and classic charm. Don't miss the opportunity to make this versatile and beautifully appointed home yours.





Suite 2, The Limes, 32 Bridge St, Thetford IP24 3AG
0184 281 8688

thetford@locationlocation.com
www.locationlocation.com

We are required by law to conduct anti-money laundering checks on all those selling or buying a property. Whilst we retain responsibility for ensuring checks are carried out correctly and for ongoing monitoring, the initial checks are carried out on our behalf by Lifetime Legal who will contact you once you have agreed to instruct us in your sale or had an offer accepted on a property you wish to buy. The cost of these checks is £60 inc VAT, which covers the cost of obtaining relevant data and any manual checks and monitoring which might be required. This fee is paid in advance, directly to Lifetime Legal and is non-refundable.

In accordance with The Consumer Protection from Unfair Trading Regulations 2008 all property particulars, photographs and floor plans are for guidance only. They do not constitute a contract or part of a contract. Lease details, service charges and ground rent (where applicable) and council tax are given as a guide only and should be checked and confirmed by your Solicitor prior to exchange of contracts. We have not carried out a structural survey and the services, appliances and specific fittings have not been tested. All photographs, measurements, floor plans and distances referred to are given as a guide only and should not be relied upon for the purchase of carpets or any other fixtures or fittings. The copyright of all details, photographs and floor plans remain exclusive to Location Location.