



20 Ravenswood Drive

Brighton BN2 6WN

Asking Price Of £375,000
Freehold

- THREE BEDROOMS
- SHOWER ROOM
- LIVING ROOM
- KITCHEN

- SPACIOUS GARDEN
- NO ONWARD CHAIN
- PRESENTED IN GOOD DECORATIVE ORDER
- UPVC DOUBLE GLAZED WINDOWS

Whitlock and Heaps are pleased to bring to market this end of terrace family home that is neutrally decorated throughout and offers good size accommodation with a double aspect living room and kitchen. The delightful rear garden backs onto open farmland. The property also benefits from UPVC double glazed windows, gas central heating and is being sold with no onward chain.

ENTRANCE HALL Radiator, understairs storage cupboard.

KITCHEN Incorporating stainless steel sink unit with drainer, adjacent laminate work surface with cupboards and drawers under, matching eye level wall cupboards, gas cooker, fridge/freezer and washing machine, tiled splashback, UPVC double glazed window overlooking the garden, door to:

UTILITY AREA Gas fired boiler, radiator, UPVC window and door to garden.

LIVING ROOM Double aspect with two UPVC double glazed windows, electric fire with brick surround and hearth, two radiators.

FIRST FLOOR

LANDING Hatch to loft space, radiator.

BEDROOM 1 UPVC double glazed window, fitted cupboard, radiator.

BEDROOM 2 Double aspect with two UPVC double glazed windows, fitted cupboard, radiator.

BEDROOM 3 UPVC double glazed window, fitted cupboard, radiator.

SHOWER ROOM Comprising walk in shower, wash hand basin with cupboard under, low level w.c, radiator, UPVC double glazed window, part tiled walls.

FRONT GARDEN Laid to lawn.

REAR GARDEN Well established being mainly laid to lawn and backing onto fields.

Freehold

Council Tax Band B (taken from www.brighton-hove.gov.uk/council-tax).

We advise that you check this information, we will not be held responsible if the council tax band differs when occupying the property.

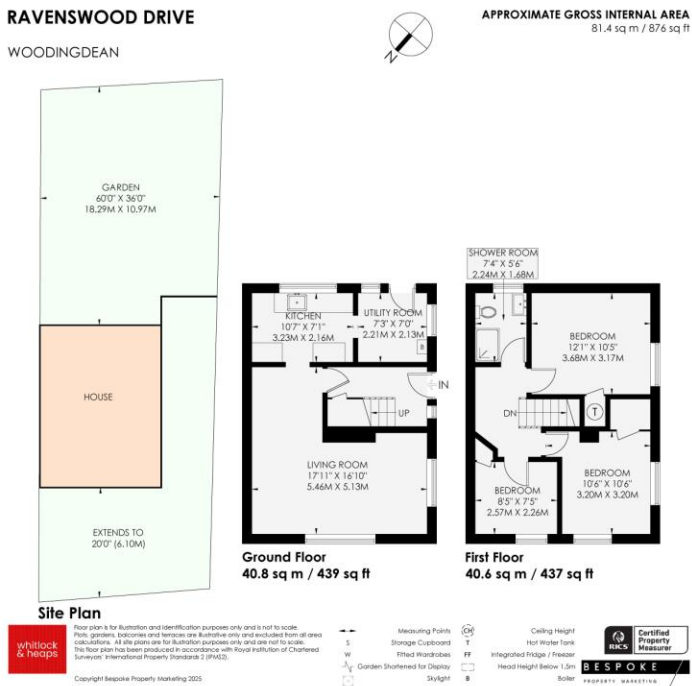

Score	Energy rating	Current	Potential
92+	A		
81-91	B		86 B
69-80	C		
55-68	D	62 D	
39-54	E		
21-38	F		
1-20	G		

65 Sackville Road, Hove BN3 3WE
sales@whitlockandheaps.co.uk
01273 778577



Disclaimer: Whitlock & Heaps have produced these particulars in good faith and they are set out as a general guide. Accuracy is not guaranteed, nor do they form part of any contract. If there is any particular aspect of these details which you require any confirmation, please do contact us, especially if contemplating a long journey. All measurements are approximate. Fixtures and fittings, other than those mentioned above, to be agreed with the seller. Any services, systems or appliances at the property have not been tested.