



3 ORIEL VILLAS 2 ORIEL ROAD, CHELTENHAM, GLOUCESTERSHIRE, GL50 1XN



## A VERY SMART AND RECENTLY RENOVATED ONE BEDROOM APARTMENT SET WITHIN THIS ATTRACTIVE PERIOD CONVERSION WHICH HAS CREATED A WONDERFUL PIED DE TERRE OF FIRST TIME BUY.

### THE PROPERTY

Oriel Villas was a development by Boo Homes in 2012 and is located on Oriel Road moments from Imperial Gardens, the Promenade, and the High Street.

The apartment is positioned on first floor with a recently decorated communal hallway.

On entering the apartment, the inner hall provides access off the tiled shower room, bedroom, and main living area.

The living area is a generous open plan space enjoying a double aspect. The kitchen was installed in 2025 and has integrated appliances. The open hall could very easily be used as a work from home solution.

### PARKING

The apartment has one allocated parking space in the secure gated parking area.

### AGENTS NOTE

The apartment has been recently redecorated and has oak flooring throughout. It will be sold chain free. There is also a communal recycling area.

### TENURE

Leasehold

Lease: 999 years from 2012

Service Charge: £69.42 per month = 5.05% of costs

Ground Rent: £250 per annum until 2031

Managing Agents: Cambray Property Management

Pets: Maybe be considered if required

No short term lets are permitted







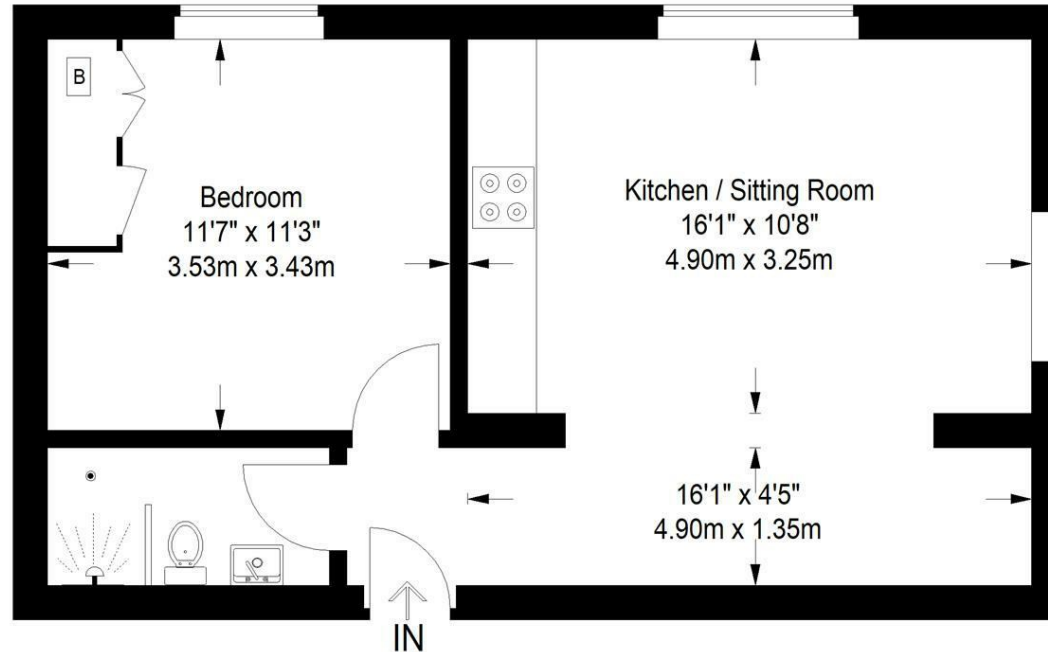

Gross Internal Area = 439 sq ft / 40.8 sq m



Illustration for identification purposes only, measurements are approximate and are not to scale.

Please check all details before making any decisions reliant upon them.

Copyright Read Maurice. (ID 1209024)

EPC: Band D

Rating: 59

Council Tax: B

Area: 439.00 sq ft

**readmaurice** 

**3 ORIEL VILLAS 2 ORIEL ROAD, CHELTENHAM, GLOUCESTERSHIRE, GL50 1XN**

These particulars, whilst believed to be accurate are set out as a general outline only for guidance and do not constitute any part of an offer or contract. Intending purchasers should not rely on them as statements or representation of fact, but must satisfy themselves by inspection or otherwise as to their accuracy. We have not carried out a detailed survey nor tested the services, appliances and specific fittings. Room sizes should not be relied upon for carpets and furnishings. The measurements given are approximate. No person in this firm's employment has the authority to make or give any representation or warranty in respect of the property. PRN: 19407056 - Date of printing 16th June 2025

48 Andover Road, Cheltenham, GL50 2TL

Tel: 01242 241122

Email: [post@readmaurice.co.uk](mailto:post@readmaurice.co.uk)

[www.readmaurice.co.uk](http://www.readmaurice.co.uk)