

HUNTERS[®]

HERE TO GET *you* THERE



Somerset Terrace

Bristol, BS3 4LL

Guide Price £385,000



A substantial (circa 1200sq ft) victorian home a stones throw from Victoria Park



living room 11'10" x 11'1" (3.62 x 3.40)
 dining room 15'3" x 10'10" (4.66 x 3.32)
 kitchen 13'5" x 6'9" (4.09 x 2.08)
 cellar 12'9" x 10'8" (3.91 x 3.27)
 bedroom one 15'3" x 11'7" (4.66 x 3.55)
 bedroom two 11'7" x 11'1" (3.54 x 3.40)
 bathroom 10'4" x 7'5" (3.15 x 2.27)

Area Map

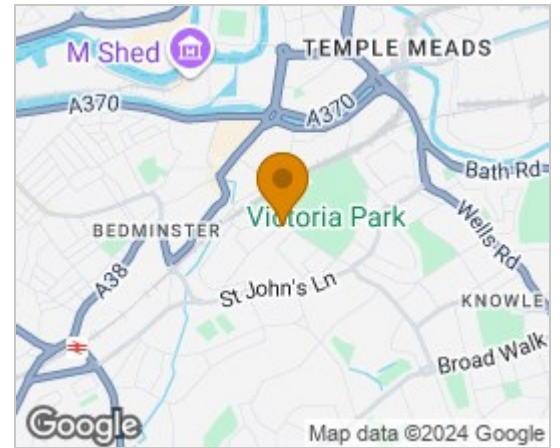

Floor Plans

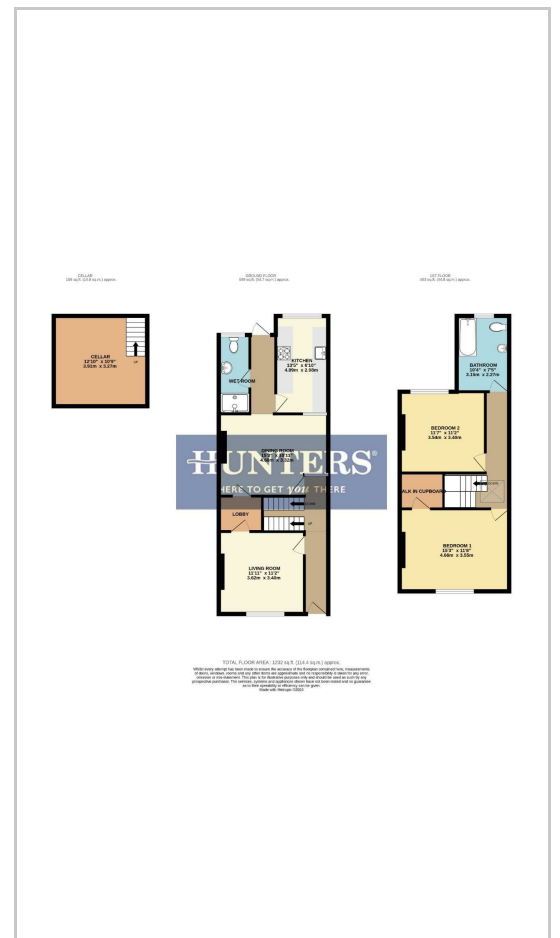

Energy Efficiency Graph

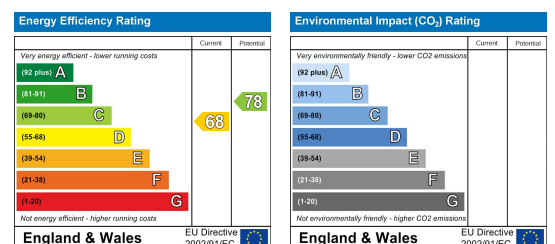

These particulars are intended to give a fair and reliable description of the property but no responsibility for any inaccuracy or error can be accepted and do not constitute an offer or contract. We have not tested any services or appliances (including central heating if fitted) referred to in these particulars and the purchasers are advised to satisfy themselves as to the working order and condition. If a property is unoccupied at any time there may be reconnection charges for any switched off/disconnected or drained services or appliances - All measurements are approximate. **THINKING OF SELLING?** If you are thinking of selling your home or just curious to discover the value of your property, Hunters would be pleased to provide free, no obligation sales and marketing advice. Even if your home is outside the area covered by our local offices we can arrange a Market Appraisal through our national network of Hunters estate agents.

165 East Street, Bedminster, BS3 4EJ
 Tel: 0117 953 5375 Email: bedminster@hunters.com <https://www.hunters.com>