

79 Cyril Bell Close, Lymm

£245,000

🛏 2 🚿 1 🚗 1



AN EARLY VIEWING IS STRONGLY RECOMMENDED TO APPRECIATE THIS FRESHLY REFURBISHED, SPACIOUS 2 BEDROOM FIRST FLOOR APARTMENT IN A DELIGHTFUL LOCATION WITH VIEWS OVER THE BRIDGEWATER CANAL.

Key Features

- Two bed, first floor Retirement apartment
- Attractive and very well maintained community within walking distance of Lymm Village centre and amenities
- Glorious views over the Bridgewater Canal towards the Northern Hills
- Recently refitted kitchen
- No onward chain
- On-site Laundry and House Manager - pull cord assistance system in situ
- Internal viewing highly recommended
-
-

607 sq.ft. (56.4 sq.m.) approx.

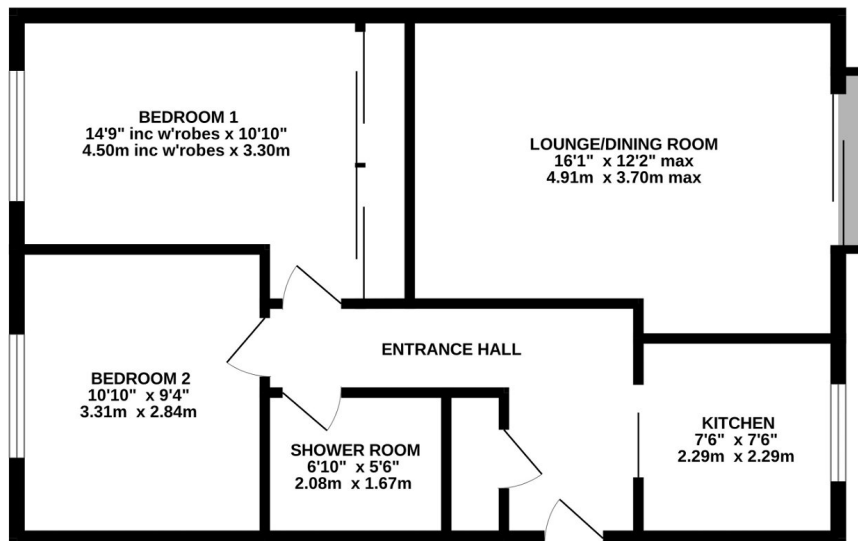

TOTAL FLOOR AREA : 607 sq.ft. (56.4 sq.m.) approx.

Whilst every attempt has been made to ensure the accuracy of the floorplan contained here, measurements of doors, windows, rooms and any other items are approximate and no responsibility is taken for any error, omission or mis-statement. This plan is for illustrative purposes only and should be used as such by any prospective purchaser. The services, systems and appliances shown have not been tested and no guarantee as to their operability or efficiency can be given.

Made with Metropix ©2023