

Limefield Avenue, Lymm, WA13 0QB

£725,000

🛏 4 🍽 2 🛋 2



Refurbished four-bedroom detached family home in a prime Lymm location

Beautifully refurbished and presented throughout, this impressive four-bedroom detached family home is ideally positioned at the top of a quiet cul-de-sac in one of Lymm's most sought-after locations—just a short walk from Lymm Village centre and Lymm High School.

The property benefits from a spacious driveway offering ample off-road parking, a double garage, and a fully enclosed West facing rear garden—perfect for family living and entertaining.

Inside, the accommodation includes two generous reception rooms, a stylish dining kitchen and a separate utility room. Every detail has been carefully considered to create a home that combines modern comfort with practical family living.

Early viewing is highly recommended to fully appreciate all that this exceptional property has to offer.

Key Features

- Four bedroom executive detached property
- Two generous sized reception rooms
- Downstairs WC
- Driveway parking for several vehicles
- Easy walking distance to Lymm village centre, schools and amenities
- Premium plot in a highly sought after location
- Principal bedroom with en suite shower room
- Fully enclosed, private West facing rear garden
- Double garage
- Early viewings strongly recommended

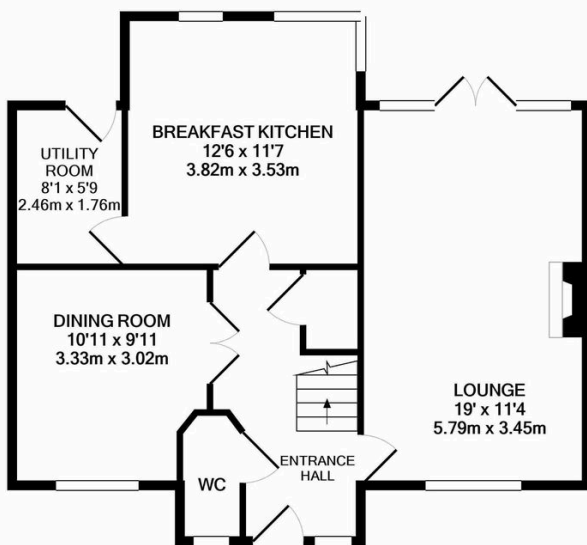

GROUND FLOOR
APPROX. FLOOR
AREA 625 SQ.FT.
(58.0 SQ.M.)

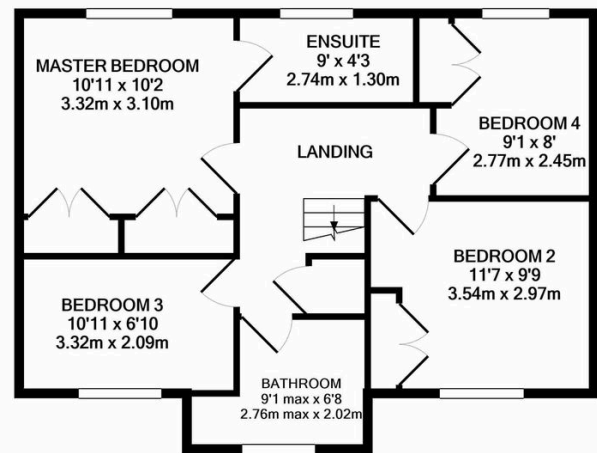

1ST FLOOR
APPROX. FLOOR
AREA 572 SQ.FT.
(53.1 SQ.M.)

TOTAL APPROX. FLOOR AREA 1196 SQ.FT. (111.1 SQ.M.)

Whilst every attempt has been made to ensure the accuracy of the floor plan contained here, measurements of doors, windows, rooms and any other items are approximate and no responsibility is taken for any error, omission, or mis-statement. This plan is for illustrative purposes only and should be used as such by any prospective purchaser. The services, systems and appliances shown have not been tested and no guarantee as to their operability or efficiency can be given.

Made with Metropix ©2021