

1 Dane Bank Road, Lymm, WA13 9DQ

£1,250,000

🛏 4 🚿 2 🛋 2



This exceptional extended Edwardian residence, originally constructed in 1903, has been updated by the current owners and offers period elegance with modern living. The property retains a wealth of original architectural features, including moulded architraves, ornate cornicing, detailed coving, elegant ceiling roses, and traditional sash windows. Perfectly positioned just a stone's throw from Lymm's picturesque village centre, this stunning home offers a rare opportunity to enjoy classic architectural charm alongside contemporary living. Early viewings are highly recommended to fully appreciate the quality, character, and location of this remarkable period property.

Key Features

- Iconic Edwardian residence situated in an elevated position in a highly sought after location
- Located a stone's throw from Lymm village centre
- Fabulous 32ft living dining kitchen
- 19ft Principal Bedroom
- Landscaped gardens and outdoor entertaining space
- Constructed 1903
- Retaining a wealth of original architectural features
- Separate Family Room & Sitting Room
- Top floor configuration makes excellent guest accommodation
- Early viewings are highly recommended to appreciate the quality and character of this period property

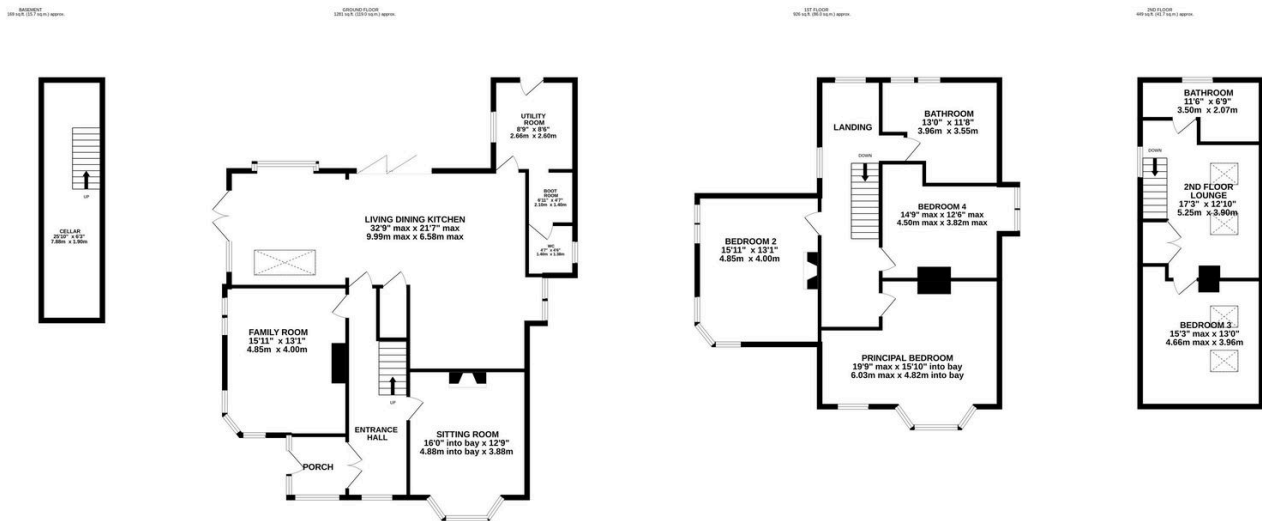

TOTAL FLOOR AREA : 2824 sq.ft. (262.4 sq.m.) approx.

Whilst every attempt has been made to ensure the accuracy of the floorplan contained here, measurements of doors, windows, rooms and any other items are approximate and no responsibility is taken for any error, omission or mis-statement. This plan is for illustrative purposes only and should be used as such by any prospective purchaser. The services, systems and appliances shown have not been tested and no guarantee as to their operability or efficiency can be given.

Made with Metropix ©2025