

Agden Brow Park, Lymm WA13 0UB

£75,000

🛏 1 🚿 1 🛋 1



One-Bedroom Park Home with EXPANSIVE COUNTRYSIDE VIEWS

This smart and spacious park home is located on a well-established site, just a short walk from the local shop, Post Office, and a highly regarded public house. Lymm village is only a 5-minute drive away, providing easy access to amenities and local attractions.

Comprising of a lounge/dining room, a fully fitted kitchen, shower room and bedroom. Paved to front and side elevations giving ample space, patio gardens offer stunning, expansive views of the open countryside from the rear.

Internal viewing is highly recommended to fully appreciate all it has to offer. CHAIN FREE.

Key Features

- CHAIN FREE
- Established community for the over 50's
- Patio Gardens
- LPG gas central heating
- Close to shop, country pubs, post office and bus route
- Fabulous, expansive views from rear over open countryside
- One bedroom park home on well established site
- Allocated parking space and visitors parking
- Electricity and water metered and billed separately, every 3 months
- Internal viewing highly recommended

337 sq.ft. (31.3 sq.m.) approx.

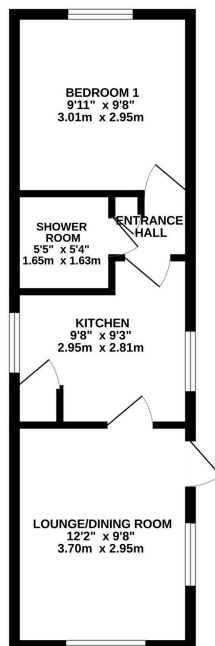

TOTAL FLOOR AREA: 337 sq.ft. (31.3 sq.m.) approx.

Whilst every attempt has been made to ensure the accuracy of the floorplan contained here, measurements of doors, windows, rooms and any other items are approximate and no responsibility is taken for any error, omission or misstatement. This plan is for illustrative purposes only and should be used as such by any prospective purchaser. The services, systems and appliances shown have not been tested and no guarantee as to their operability or efficiency can be given.
Made with Metropix C0205