

Richmond Drive, Lymm WA13 9HE

£395,000

🛏 2 🚿 1 🛋 1



This delightful two semi-bungalow is situated in a popular location within walking distance of Oughtrington Primary School. Well maintained throughout and offering versatile accommodation, having undergone refurbishment with new roof, boiler, shower room and render to the front elevation. Benefitting from gardens to the front and rear, off road parking and garage, early viewings are strongly recommended to appreciate all that this property has to offer.

Key Features

- Two bedroom semi-detached bungalow
- Good sized lounge
- Conservatory
- Driveway providing off-road parking
- Walking distance of Oughtrington Primary School
- Refurbished with new roof, shower room and boiler
- Newly fitted Shower Room
- South facing, fully enclosed rear garden
- Garage
- Viewings strongly recommended

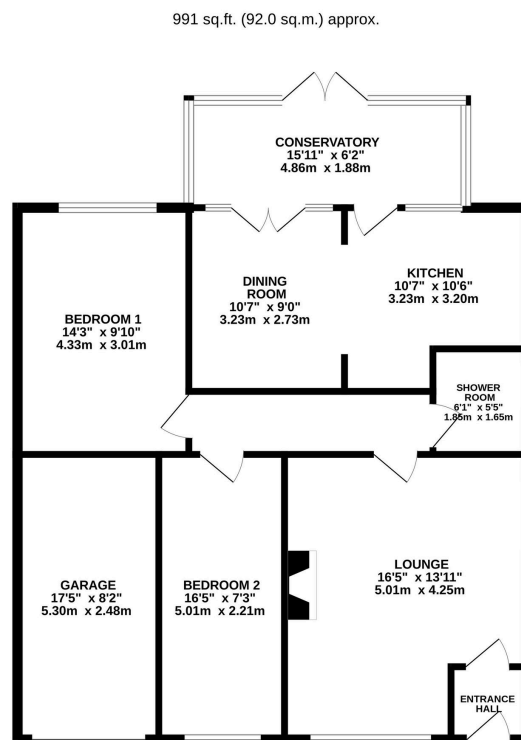

TOTAL FLOOR AREA: 991 sq.ft. (92.0 sq.m.) approx.
Whilst every attempt has been made to ensure the accuracy of the figures contained herein, measurements of doors, windows, rooms and any other items are approximate and no responsibility is taken for any error, omission or misstatement. The plan is for illustrative purposes only and should be used as such for any prospective purchase. The services, systems and appliances shown have not been tested and no guarantee as to their quality or efficiency can be given.
Made with Metropix 12/2025