

Hillside, Agden Brow Park, Lymm, WA13 0UD

£160,000

🛏 2 🚿 1 🚿 1



Two-Bedroom Park Home with Expansive Countryside Views

This smart and spacious two-bedroom park home is located on a well-established site, just a short walk from the local shop, Post Office, and a highly regarded public house. Lymm village is only a 5-minute drive away, providing easy access to amenities and local attractions.

Comprising of a lounge/dining room, a fully fitted kitchen, and a newly refurbished shower room. Paved to front and side elevations giving ample space, patio gardens with mature shrubs, along with a raised decked veranda, accessed from the home and the garden, offering stunning, expansive views of the open countryside from the rear.

Internal viewing is highly recommended to fully appreciate all it has to offer. CHAIN FREE.

Key Features

- CHAIN FREE
- Established community of over 50's
- Decked veranda and patio garden
- Electricity and water metered and billed separately, every 3 months
- Close to shop, country pubs, post office and bus route
- Fabulous, expansive views from rear over open countryside
- Two bedroom park home on well established site
- LPG gas central heating
- Off road parking and visitor parking available
- Internal viewing highly recommended

Ground Floor

Approx. 48.9 sq. metres (526.0 sq. feet)

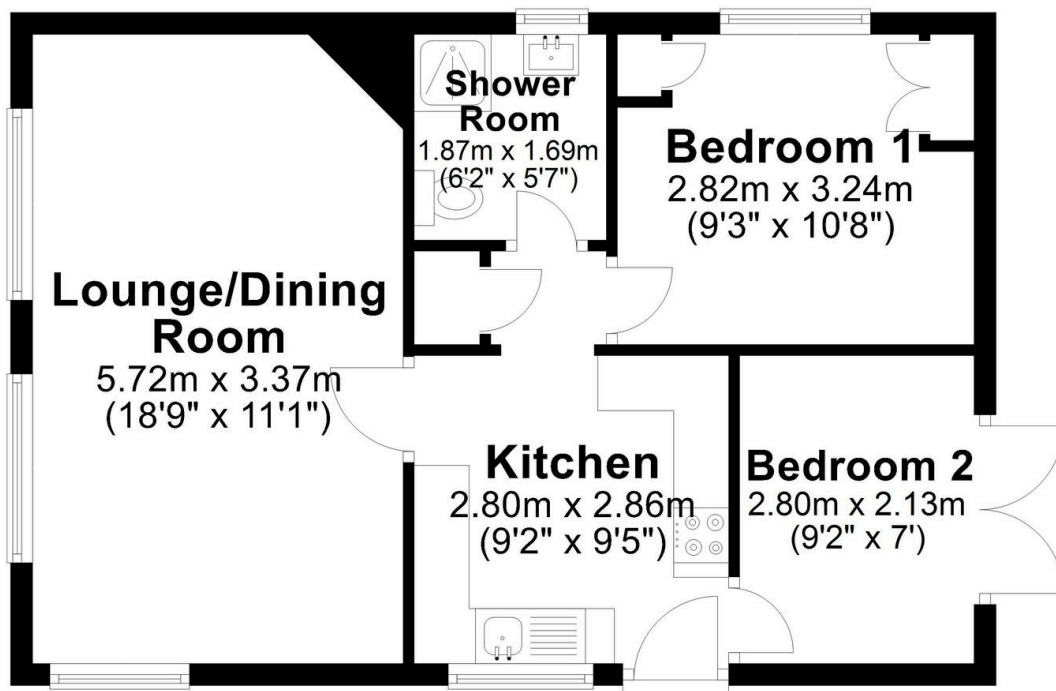

Total area: approx. 48.9 sq. metres (526.0 sq. feet)