

Sycamore Cottage, Knutsford Road, Grappenhall, Warrington, WA4 2TU

Offers Over £800,000

🛏 5 🍽 3 🚗 3



Sycamore Cottage is an exceptional and substantial detached family home sitting in large mature gardens. Since 2002 the property has been subject to significant enhancement following alteration and extension. The result is a striking family home with accommodation arranged over two floors extending to almost 2661 sq ft. This offers great flexibility for the growing family. Approached via electrically operated remote controlled gates, this leads to extensive driveway parking and a substantial detached double garage. Early viewings are strongly recommended.

Key Features

- Exceptional and substantial detached property
- Extensive driveway providing plentiful off-road parking
- 27ft Lounge
- Separate sitting room and dining room
- Guest bedroom with en suite shower room
- Large mature gardens
- Detached double garage
- Sun Room
- Master bedroom with en suite bathroom
- Early viewings strongly recommended of this beautifully presented family home

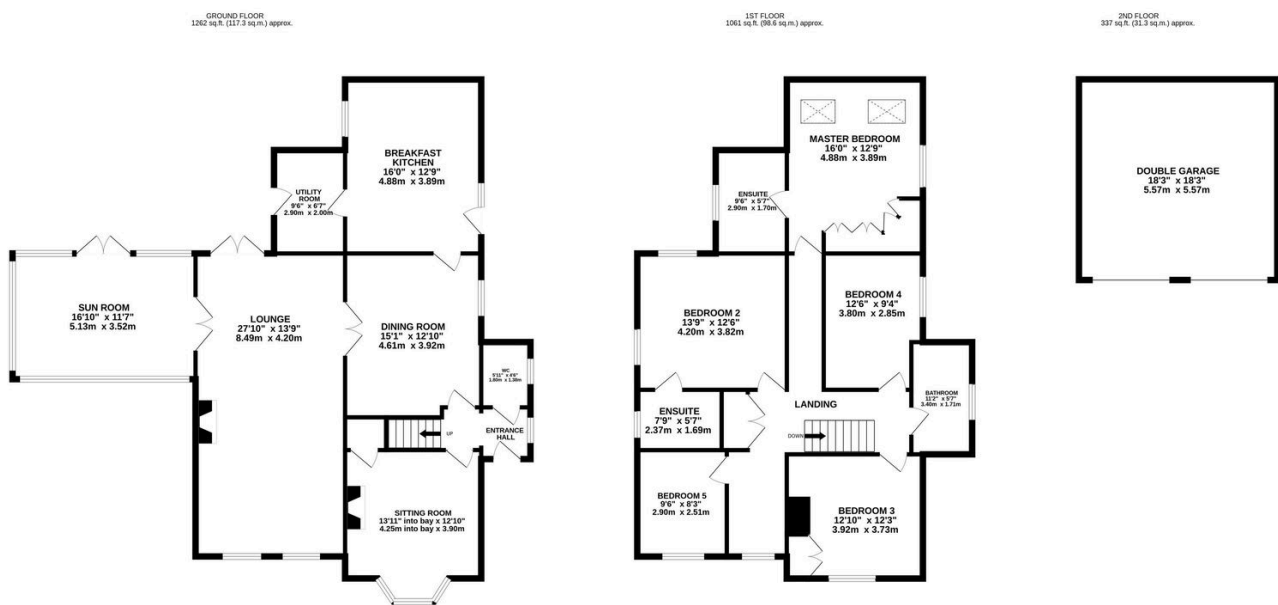

TOTAL FLOOR AREA : 2661 sq.ft. (247.2 sq.m.) approx.

Whilst every attempt has been made to ensure the accuracy of the floorplan contained here, measurements of doors, windows, rooms and any other items are approximate and no responsibility is taken for any error, omission or mis-statement. This plan is for illustrative purposes only and should be used as such by any prospective purchaser. The services, systems and appliances shown have not been tested and no guarantee as to their operability or efficiency can be given.

Made with Metropix ©2025