

## The Moorings, 133 Higher Lane, Lymm, WA13 0BU

£895,000

🛏️ 4 🚿 1 🚗 3



Being sold with the benefit of No Onward Chain, The Moorings is a spacious four bedroom detached property situated in a prime location on Higher Lane. Sitting on a generous plot with a good sized driveway providing plentiful off-road parking, double garage and beautifully maintained gardens to both the front and rear elevations, early viewings are strongly recommended to appreciate all that this delightful family home has to offer.

## Key Features

- No Onward Chain
- Popular location on Higher Lane close to Lymm High School
- Sitting on a generous sized plot with well maintained gardens to the front and rear elevation
- Useful ground floor office with its own private entrance
- Offering well-proportioned rooms throughout
- Well presented four bedroom detached property
- Good sized driveway and detached double garage
- Original doors throughout
- Outbuildings to include utility room, WC and garden store
- Early viewings are strongly recommended to appreciate all that this family home has to offer and its ideal location

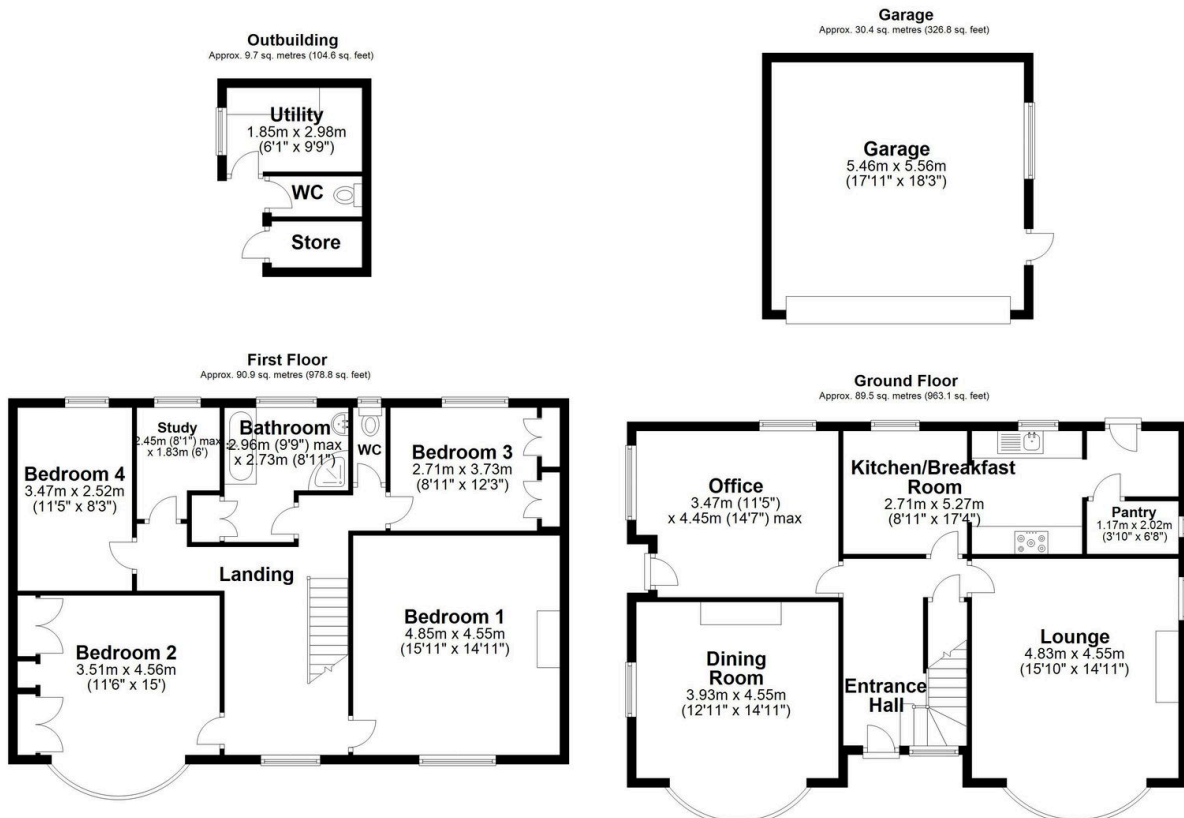

Total area: approx. 220.5 sq. metres (2373.2 sq. feet)

Measurements of rooms and any other items are approximate and no responsibility is taken for any misstatement. This plan is for illustrative purposes only and should be used as such. Produced by OpenInsight.co.uk  
Plan produced using PlanUp.