

7 Crossland Mews, Lymm WA13 9GB

£170,000

🛏️ 2 🚿 1 🚗 1



A beautifully presented ground floor apartment with two bedrooms, open plan living / dining room and recently refurbished kitchen and bathroom. This property would be perfect for first time buyers, down sizers and investors. Early viewings recommended. EPC C.

Key Features

- Two bedroom ground floor apartment
- Gas central heating
- Bathroom re-fitted to a high specification
- Communal gardens
- No onward chain
- Recently refurbished and redecorated throughout
- Well appointed kitchen with granite worktops
- Secure communal entrance
- Private parking
- Viewings highly recommended

546 sq.ft. (50.7 sq.m.) approx.

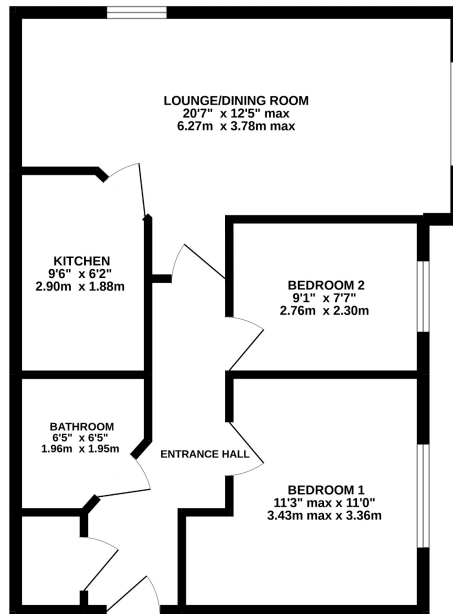

TOTAL FLOOR AREA: 546 sq.ft. (50.7 sq.m.) approx.
Whilst every attempt has been made to ensure the accuracy of the floorplan contained herein, measurements of doors, windows, rooms and any other items are approximate and no responsibility is taken for any error, omission or mis-statement. This plan is for illustrative purposes only and should be used as such for any prospective purchase. The services, systems and appliances shown have not been tested and no guarantee as to their operability or efficiency can be given.
Made with Metropix ©2022