



Banner & Co

42 Eagle Brow, Lymm, Cheshire, WA13 0LZ

£1,450,000

🛏️ 5 🚗 4 🚗 5



- Fabulous five bedroom detached family property
- Good sized driveway
- Welcoming Reception Hallway
- Separate Lounge
- Delightful gardens
- Walking distance of Lymm village centre and all of its amenities
- Triple Garaging
- Stunning kitchen opening to Living Room
- Formal Dining Room
- Early viewings highly recommended

This superb family home occupies a generous sized plot and is located close to all amenities. The accommodation on offer boasts a welcoming entrance reception hallway, study, cloakroom, lounge, home office, downstairs WC, breakfast room opening onto the kitchen and further living room, separate dining room and utility room. To the first floor there is a superb master bedroom with Juliet style balcony doors to the rear overlooking the garden and en suite shower room, four further bedrooms, two boasting en suite shower rooms and separate family bathroom. Externally the private gardens wrap around the property and are bordered by the original sandstone wall. A driveway offers abundant space for the parking of several vehicles and the tripe garage provides additional space. There is a good sized garden to the rear which is fully enclosed and offers a good degree of privacy.

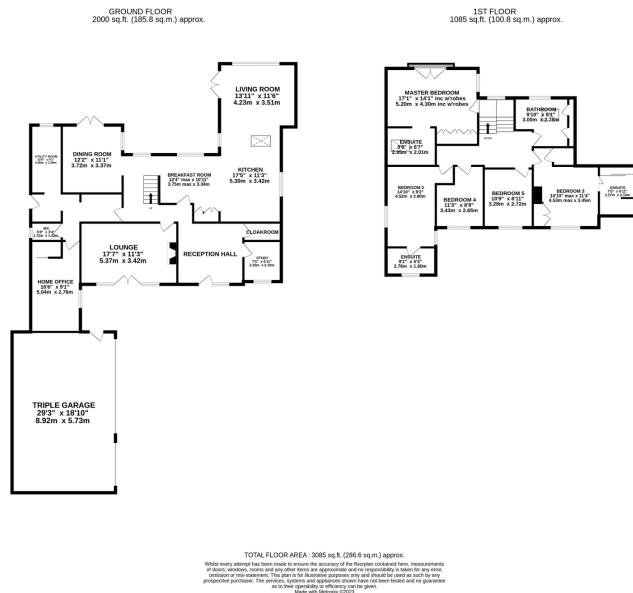

Energy Efficiency Rating			
Score	Energy rating	Current	Potential
92+	A		
81-91	B		
69-80	C	73 C	79 C
55-68	D		
39-54	E		
21-38	F		
1-20	G		