

71 Higher Lane, Lymm, WA13 0BZ

£650,000

🛏 5 🚿 1 🚗 3



NEW PRICE - traditional semi-detached family home which we believe was built in the early 1850's. Now in need of some updating, this property has ample potential for a new buyer to transform into their ideal home. Occupying a highly sought after residential location this period style property boasts well proportioned rooms throughout and retains a wealth of original features including deep skirting boards, high ceilings with cornicing and picture rails and oozes great charm and potential.

Key Features

- NEW PRICE - Traditional semi-detached property
- Located in a highly sought after residential location
- Retaining a wealth of original features
- Good sized private rear garden
- Detached Garage
- In need of some updating
- Well proportioned rooms
- Oozing with charm and offering great potential
- Two Cellars
- Viewings strongly recommended

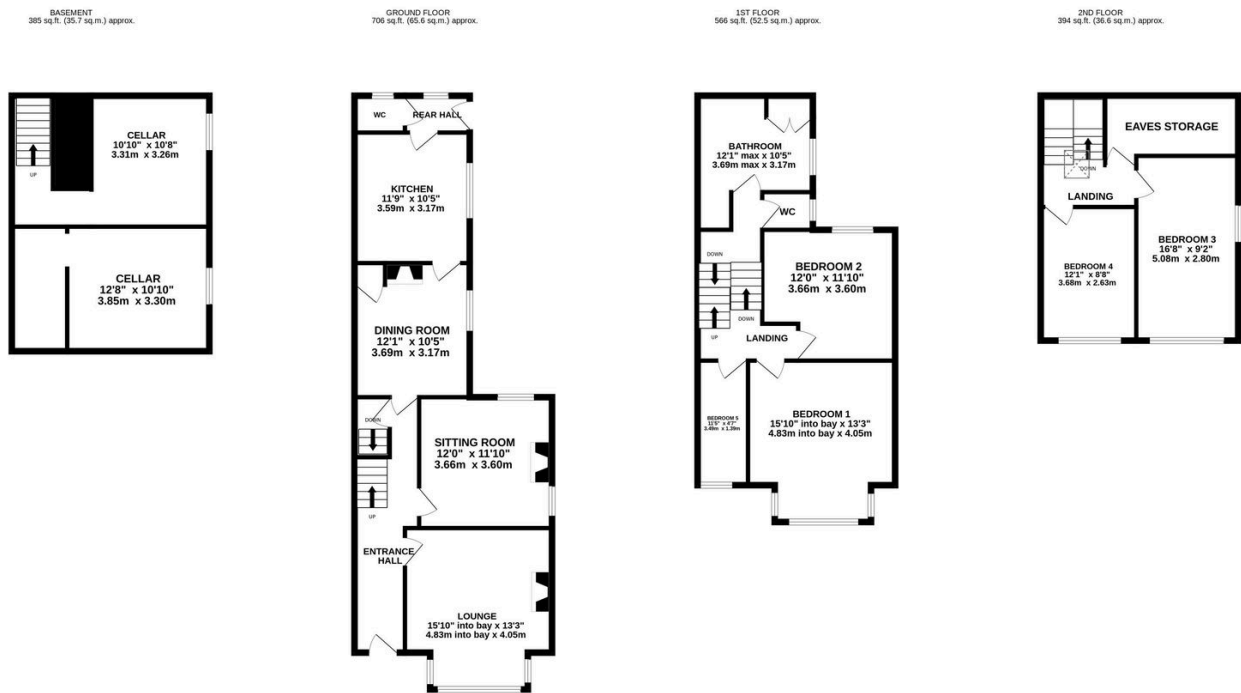

TOTAL FLOOR AREA : 2051 sq.ft. (190.5 sq.m.) approx.

Whilst every attempt has been made to ensure the accuracy of the floorplan contained here, measurements of doors, windows, rooms and any other items are approximate and no responsibility is taken for any error, omission or mis-statement. This plan is for illustrative purposes only and should be used as such by any prospective purchaser. The services, systems and appliances shown have not been tested and no guarantee as to their operability or efficiency can be given.

Made with Metropix ©2024