

17 Agden Brow Park, Lymm, WA13 0UB

£175,000

🛏️ 2 🚿 1 🚗 1



- Two bedroom park home on well established site
- Chain free
- Off road parking and visitor parking available
- Electricity and water metered and billed via site owner
- Established community of over 50's
- Pitch fee £130.75 per month (£1,569pa)
- Close to shop, country pubs, post office and bus route
- LPG gas central heating approx cost £65 each
- Fabulous, expansive views from rear over open countryside
- Internal viewing highly recommended



545 sq.ft. (50.6 sq.m.) approx.

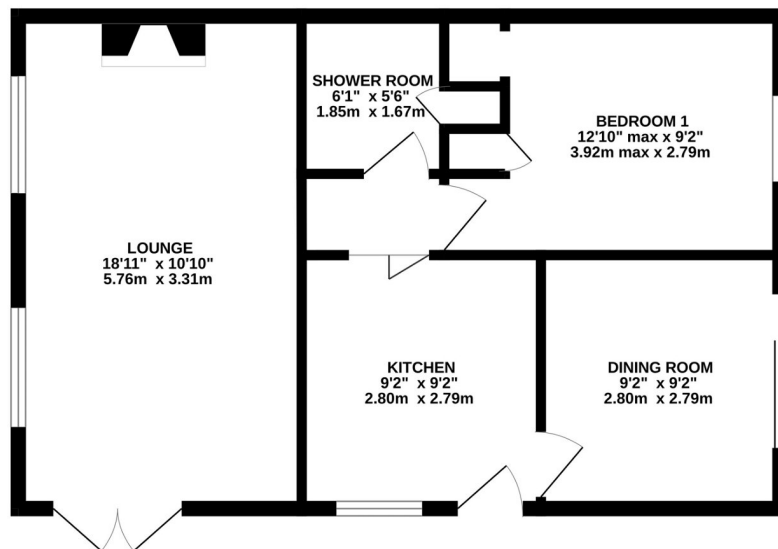

TOTAL FLOOR AREA: 545 sq.ft. (50.6 sq.m.) approx.

Whilst every attempt has been made to ensure the accuracy of the floorplan contained here, measurements of doors, windows, rooms and any other items are approximate and no responsibility is taken for any error, omission or mis-statement. This plan is for illustrative purposes only and should be used as such by any prospective purchaser. The services, systems and appliances shown have not been tested and no guarantee as to their operability or efficiency can be given.
Made with Metropix 1/2023

SPACIOUS TWO BEDROOM PARK HOME IN EXCELLENT CONDITION, WELL SITUATED ON AN ESTABLISHED SITE CLOSE TO LYMM/ALTRINCHAM AND LOCAL AMENITIES. CHAIN FREE