



Hanover Walk, Hertfordshire, AL10 9EL

Flat - Purpose Built | 2 Bedrooms

£1,395 PCM

**LARKHAM
PIKE** &

www.larkhamandpike.co.uk



Energy Efficiency Rating		
	Current	Potential
Very energy efficient - lower running costs		
(92 plus) A		
(81-91) B		
(69-80) C	69	76
(55-68) D		
(39-54) E		
(21-38) F		
(1-20) G		
Not energy efficient - higher running costs		
England & Wales	EU Directive 2002/91/EC	

Ground Floor

Approx. 52.3 sq. metres (562.7 sq. feet)

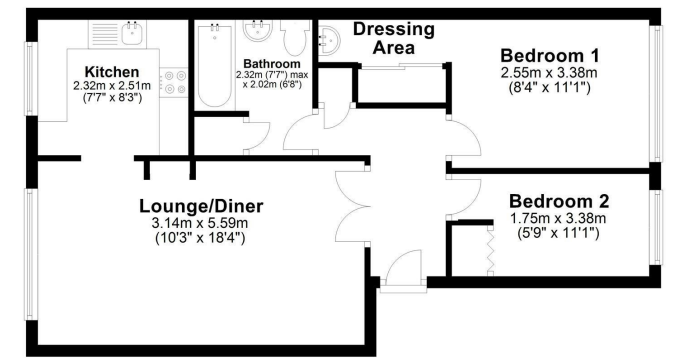

Total area: approx. 52.3 sq. metres (562.7 sq. feet)