



14 Regent Court, Welwyn Garden City, AL7 3BH

£1,200 Per calendar month

Sell with us from £995 + VAT



Carnegie

Web: www.carnegieuk.com

Tel: 01707 330373/4

Handside House, Handside Lane,
Welwyn Garden City, Herts AL8 6TA

14 Regent Court, Welwyn Garden City, AL7 3BH

Welcome to Regent Court, a charming property located in the heart of Welwyn Garden City. This delightful flat offers a cosy reception room, perfect for relaxing after a long day. With one bedroom and one bathroom, this purpose-built flat is ideal for individuals or couples looking for a comfortable living space. Built in 1992, this property boasts 505 sq ft of living space, providing ample room for all your needs. The bedroom offers a peaceful retreat, while the bathroom ensures convenience and privacy. Situated close to local shops, you'll have everything you need right at your doorstep. The green view to the rear of the property adds a touch of tranquillity, creating a peaceful oasis in the midst of city life. With an allocated parking space, you'll never have to worry about finding a place to park. The property has been recently redecorated, giving it a fresh and modern feel. Don't miss out on the opportunity to make this lovely flat your new home. Contact us today to arrange a viewing and experience the charm of Regent Court for yourself.

Living room 19'1" x 9'8" (5.82m x 2.97m)

Bedroom 13'5" x 8'11" (4.09m x 2.74m)

Kitchen 8'5" x 7'1" (2.57m x 2.18m)

Shower room



Handside House, Handside Lane, Welwyn Garden City, Herts AL8 6TA

Company incorporated in England No. 4713968
VAT No. 745 8368 91



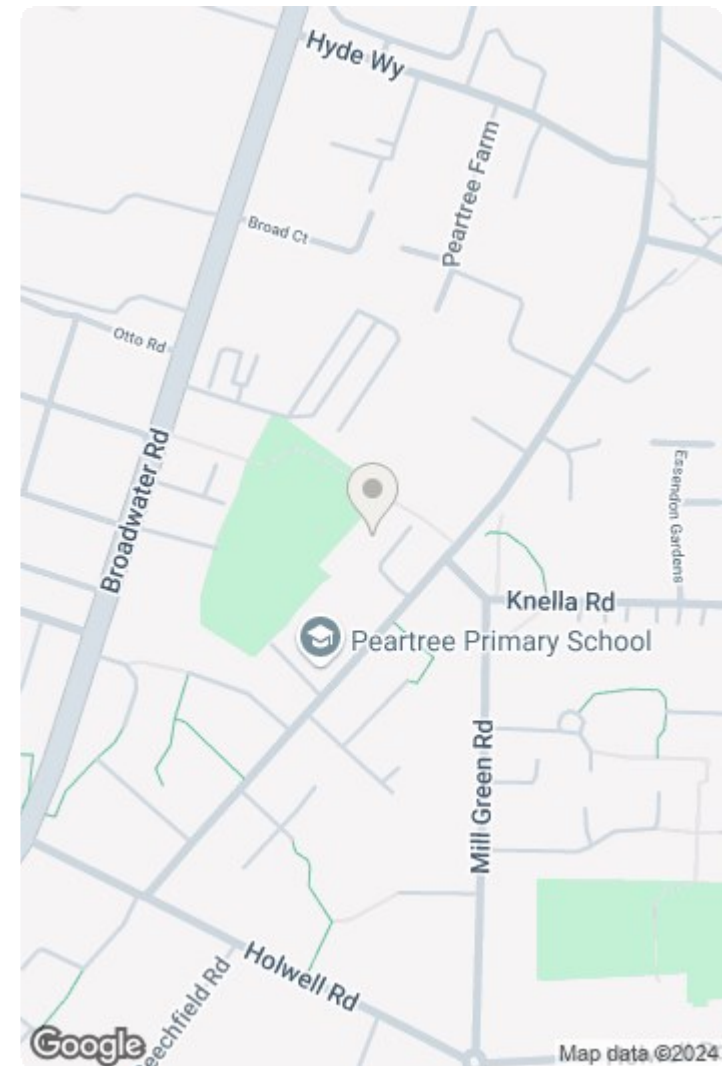
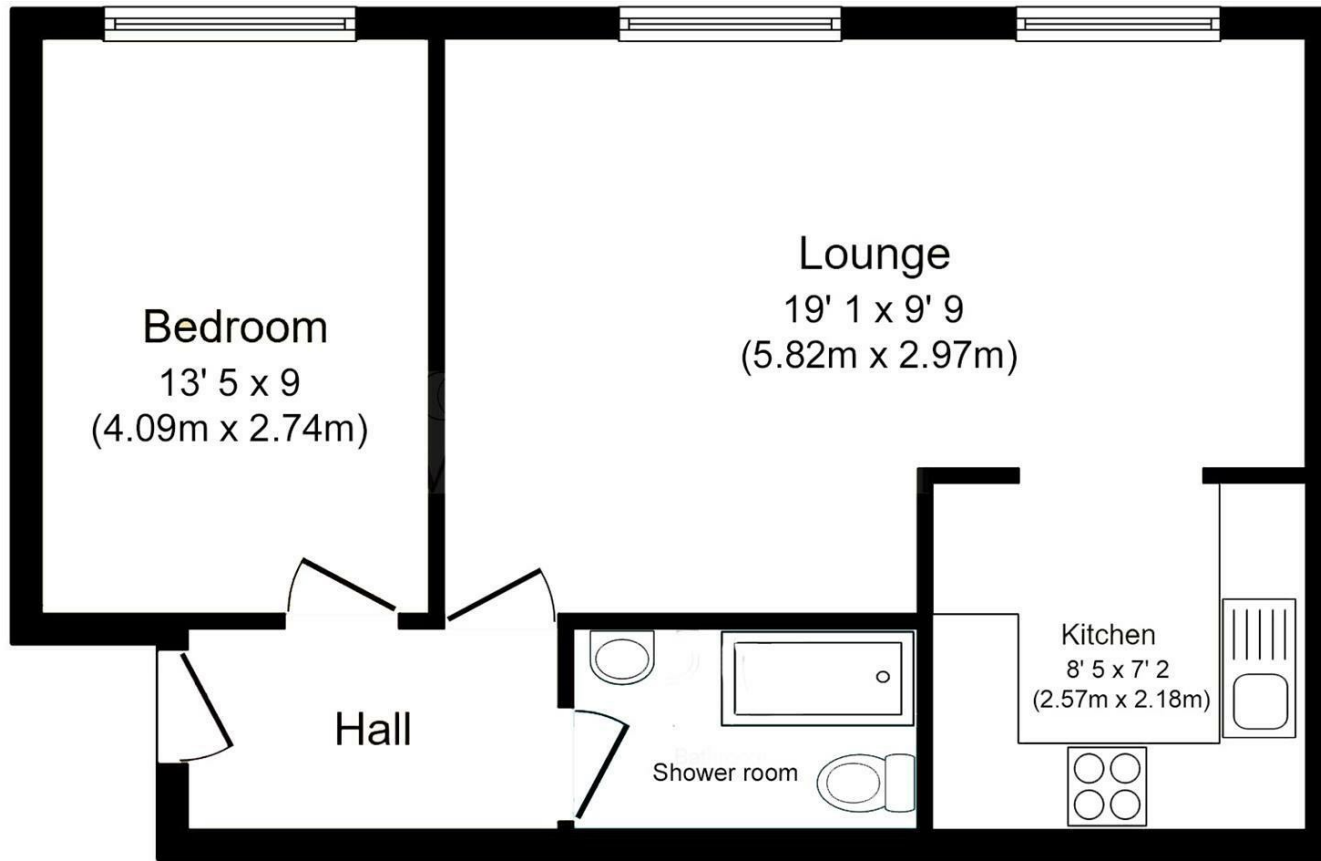

Energy Efficiency Rating		Current	Potential
Very energy efficient - lower running costs			
(92 plus) A			
(81-91) B			
(69-80) C			
(55-68) D			
(39-54) E			
(21-38) F			
(1-20) G			
Not energy efficient - higher running costs			
England & Wales		82	84
	EU Directive 2002/91/EC		

Environmental Impact (CO ₂) Rating		Current	Potential
Very environmentally friendly - lower CO ₂ emissions			
(92 plus) A			
(81-91) B			
(69-80) C			
(55-68) D			
(39-54) E			
(21-38) F			
(1-20) G			
Not environmentally friendly - higher CO ₂ emissions			
England & Wales			
	EU Directive 2002/91/EC		

Total floor area 46.9 sq.m. (505 sq.ft.) approx
 This floorplan is for illustrative purposes only and is not drawn to scale. Measurements, floor-areas, openings and orientations are approximate. They should not be relied upon for any purpose and do not form any part of an agreement. No liability is taken for any error or mis-statement. All parties must rely on their own inspections.

Handside House, Handside Lane, Welwyn Garden City, Herts AL8 6TA



Carnegie Estate Agents



Carnegie Estate Agents



Carnegie Estate Agents



Carnegie Estate Agents