



Clive Road, SE21 | Guide Price £575,000

02087028111

dulwichvillage@pedderproperty.com

pedder
We live local



In General

- A lovely first floor Edwardian apartment
- Spacious accommodation - 884 sq ft
- Three well proportioned bedrooms
- Large lounge/dining room
- Modern kitchen and bathroom
- Private garden to rear
- Very well presented throughout
- Popular location
- Offered with no onward chain

In Detail

Guide Price: £575,000 - £600,000

Offered with no onward chain and Located on this popular residential road in West Dulwich, an attractive first floor Edwardian three bedroom apartment with private rear garden for sale in Clive Road, SE21.

With a gross internal area of 884 sq ft the property offers particularly spacious and well presented accommodation comprising three well proportioned bedrooms, a large lounge/dining room to the front, a well-appointed kitchen with shaker style cupboards and modern bathroom. An internal staircase leads down to a private rear garden with a patio area and lawn.

This lovely home is located on a pretty tree-lined residential road in West Dulwich with easy access to a variety of local amenities and numerous shops, cafes and restaurants. Excellent transport links are close-by from West Dulwich station (direct services to London Victoria and London Blackfriars) and Gipsy Hill (direct services to London Bridge and London Victoria). Regular buses to Central London run along nearby South Croxted Road. Outstanding state schools including Elm Wood Primary and Kingsdale Foundation School are within close proximity.

EPC: C | Council Tax Band: C | Lease: 177 years remaining | SC: Nil | GR: Nil | BI: £307.66



Floorplan

Clive Road, SE21

Approximate Gross Internal Area
78.4 sq m / 844 sq ft



Ground Floor

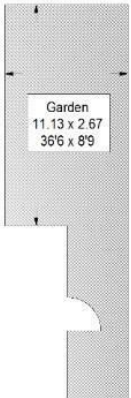

(Not Shown In Actual
Location / Orientation)

First Floor

Copyright www.pedderproperty.com © 2025
These plans are for representation purposes only as defined by
RICS - Code of Measuring Practice. Not drawn to Scale. Windows and
door openings are approximate. Please check all dimensions, shapes
and compass bearings before making any decisions reliant upon them.

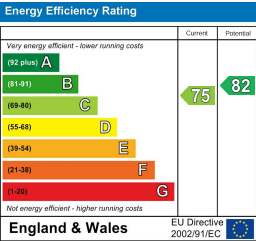

Pedder Property Ltd trading as Pedder for themselves and for the vendor/landlord of this property whose agents they are, give notice that (1) these particulars do not constitute any part of an offer or contract, (2) all statements contained within these particulars are made without responsibility on the part of Pedder or the vendor/landlord, (3) whilst made in good faith, none of the statements contained within these particulars are to be relied upon as a statement of representation or fact, (4) any intending purchaser/tenant must satisfy him/herself by inspection or otherwise as to the correctness of each of the statements contained within these particulars, (5) the vendor/landlord does not make or give either Pedder or any person in their employment any authority to make or give representation or warranty whatsoever in relation to this property.