

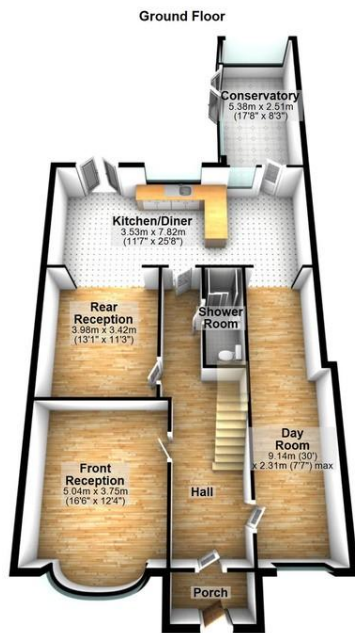

Gayfere Road  
Clayhall, Essex, IG5

Offers In Excess Of £750,000  
Freehold

**\*\* MAGNIFICENT EXTENDED FIVE BEDROOM SEMI DETACHED PROPERTY SET WITHIN PARKHILL & BEAL SCHOOL CATCHMENTS \*\*** With the sellers already having found a vacant property to purchase, we are pleased to offer for sale this extremely well presented and extended sizeable family home which offers five good size bedrooms, bathroom and separate ground floor shower room, two reception rooms plus a 30ft day room, together with a 25ft kitchen/diner leading onto the long rear garden plus a 17ft conservatory again with garden access. To the rear of the property is a large outhouse, whilst the front provides plenty of off street parking facilities. Anyone seeking a good size well presented family home offering plenty of accommodation internally will most certainly appreciate what this property has to offer. Council Tax Band F EPC Rating C



Total area: approx. 195.3 sq. metres (2102.4 sq. feet)

- Five Good Size Bedrooms
- Modern Family Bathroom/Wc
- Front & Rear Reception Rooms
- 30ft Day Room
- Ground Floor Shower Room
- 25ft Kitchen/Diner
- 17ft Conservatory
- Rear Outhouse
- Plenty Of Off Street Parking
- Parkhill & Beal School Catchments

Sovereign House  
176 Longwood

www.sovereign-house.com  
homes@sovereign-house.com  
02082201500

Agents Note: Whilst every care has been taken to prepare these sales particulars, they are for guidance purposes only. All measurements are approximate and are for general guidance purposes only and whilst every

