

Head Office:
Dixon Kelley Estate Agents
1 Penn Court
Station Road, West Moors
Dorset. BH22 0JJ

Telephone: 01202 877511

DORSET PARK HOMES

DRAFT

www.dorsetparkhomes.com

81 The Copse, Oaktree Park, Ringwood Road, St Leonards, Ringwood. BH24 2RH

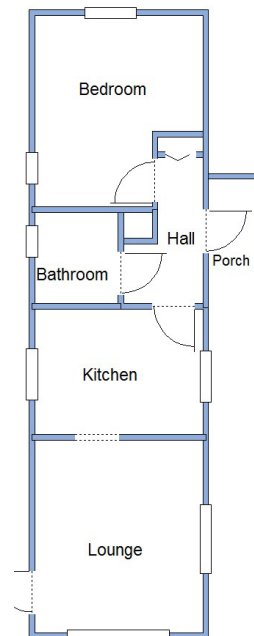

This drawing has been prepared for diagrammatic purpose only. Not to scale.

1-Bedroom Park Home - approx 36' x 10'

Accommodation & approximate room dimensions:

- Entrance Porch
- Hall: Cloak cupboard.
- Kitchen: approx 9'7" x 7'4". Newly installed with range of high gloss floor & wall cupboards. Built-in oven, hob. Integrated washing machine. Worcester gas combination boiler (untested). Breakfast table.
- Lounge: approx 11'3" x 9'7". Bay window with Forest View. Door to garden.
- Double Bedroom: approx 11'2" x 9'7" max. Fitted wardrobe.
- Shower Room: Modern Corner shower with thermo-static shower. Vanity wash basin & WC.
- Gas Central Heating (system untested)
- PVCu Double-Glazing
- Delightful Garden with 3 Metal Sheds
- Parking On Plot
- Age Restriction 50+ Pets Considered
- Residents Members club on park
- Well maintained Residential Park between Ringwood & Ferndown.

Park Home with Forest View

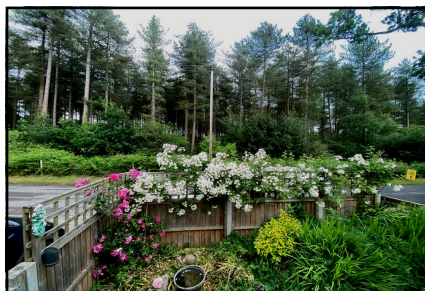

Pitch Fee: approx £197 per month
Subject to Annual Review
Council Tax Band: 'A'

Tenure: 1983 Mobile Homes Act Agreement

Price: £110,000

VIEWING STRICTLY BY APPOINTMENT WITH THE VENDOR'S AGENT Dorset Park Homes 01202 877511

IMPORTANT NOTE: These particulars are believed to be correct but their accuracy is not guaranteed. They do not form part of any contract. Nothing in these particulars shall be deemed to be a statement that the property is in good structural condition or otherwise, nor that any of the services, appliances, equipment or facilities are in good working order or have been tested. Purchasers should satisfy themselves on such matters prior to purchase Ref.W05059

The recommended specialist in Park Home sales
Partner: Simon Dixon

