

Head Office:
Dixon Kelley Estate Agents
1 Penn Court
Station Road, West Moors
Dorset. BH22 0JJ

Telephone: 01202 877511

DORSET PARK HOMES

DRAFT

www.dorsetparkhomes.com

47 Sunnyside Park, Ringwood Road, St Ives, Dorset. BH24 2NW



Residential Park Home with Forest Views

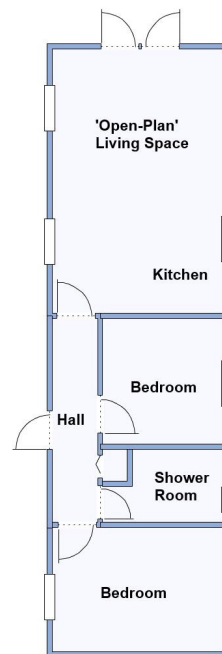

This drawing has been prepared for diagrammatic purpose only. Not to scale.

2-Bedroom Park Home - approx 40' x 12'

Accommodation & approximate room dimensions:

- Hall: Cloaks cupboard.
- 'Open-Plan' Living Space: approx 17'4" x 11'4". Double doors to raised deck and delightful forest views.
- Kitchen: Range of floor and wall cupboards. Built-in oven, hob & cooker hood. Space for washing machine & fridge/freezer. Cupboard housing combination gas boiler.
- Bedroom 1: approx 11'3" x 8'2". Built-in wardrobe.
- Bedroom 2: approx 8'3" x 8'1". Built-in wardrobe.
- Shower Room: Shower cubicle with thermostatic shower. Wash basin & WC.
- Gas Central Heating (system untested)
- PVCu Double-Glazing
- Delightful Position with Raised deck overlooking forest. Metal shed.
- Allocated Parking Bay
- Age Restriction 45+ 1 Small Dog Considered
- Small Residential Park near to Ringwood with access to protected forestry land.

'Open-Plan' Living Space



Pitch Fee: approx £216.23 per month
Subject to Annual Review
Council Tax Band: 'A'

Tenure; 1983 Mobile Homes Act Agreement

Price: £100,000

VIEWING STRICTLY BY APPOINTMENT WITH THE VENDOR'S AGENT Dorset Park Homes 01202 877511

IMPORTANT NOTE: These particulars are believed to be correct but their accuracy is not guaranteed. They do not form part of any contract. Nothing in these particulars shall be deemed to be a statement that the property is in good structural condition or otherwise, nor that any of the services, appliances, equipment or facilities are in good working order or have been tested. Purchasers should satisfy themselves on such matters prior to purchase Ref.W04969

The recommended specialist in Park Home sales
Partner: Simon Dixon

