

Head Office:
Dixon Kelley Estate Agents
1 Penn Court
Station Road, West Moors
Dorset. BH22 0JJ

DORSET PARK HOMES

DRAFT

www.dorsetparkhomes.com

Telephone: 01202 877511

28 Pilgrims Park, Southampton Road, Poulner, Ringwood. BH24 1TQ



Pristine Condition—2-Bedroom Park Home close to amenities

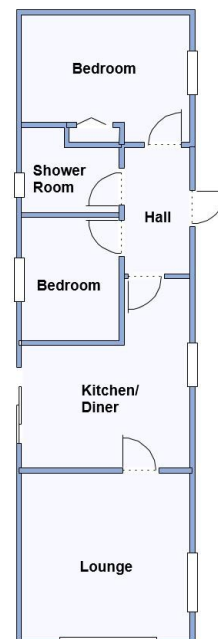

This drawing has been prepared for diagrammatic purpose only. Not to scale.

2-Bedroom Park Home - approx 44' x 12'

Accommodation & approximate room dimensions:

- Wonderland 'The Guardian' circa 1994
- Entrance Hall
- Kitchen/Diner: approx 12'7" x 11'5" max. Modern floor & wall cupboards. Built-in oven, hob & cooker hood. Larder cupboard. Space for tall fridge/freezer & washing machine. Breakfast bar. Patio doors to garden.
- Lounge: approx 11'5" x 11'5". Feature fireplace. Bay window
- Bedroom 1: approx 11'5" x 8'9". Built-in wardrobe
- Bedroom 2: approx 8'5" x 6'8". Hatch to roof space.
- Wet Room: wet room style shower with thermostatic shower over. Vanity wash basin & WC. Chrome heated towel rail.
- Gas Central Heating (system untested)
- PVCu Double-Glazing
- Beautiful Landscaped Garden. Garden Shed
- Parking on Plot—approach via Fairlie
- Age Restriction 45+ Pets considered
- Small Residential Park close to local amenities & near to Ringwood Town Centre & New Forest

'Pet Friendly' Park



Pitch Fee: approx £207 per month

Subject to Annual Review

Council tax Band: 'A'

Tenure: 1983 Mobile Homes Act Agreement

Price: £169,950

VIEWING STRICTLY BY APPOINTMENT WITH THE VENDOR'S AGENT Dorset Park Homes 01202 877511

IMPORTANT NOTE: These particulars are believed to be correct but their accuracy is not guaranteed. They do not form part of any contract. Nothing in these particulars shall be deemed to be a statement that the property is in good structural condition or otherwise, nor that any of the services, appliances, equipment or facilities are in good working order or have been tested. Purchasers should satisfy themselves on such matters prior to purchase Ref.W04849

The recommended specialist in Park Home sales
Partner: Simon Dixon

