

Head Office:
Dixon Kelley Estate Agents
1 Penn Court
Station Road, West Moors
Dorset. BH22 0JJ

DORSET PARK HOMES

DRAFT

www.dorsetparkhomes.com

Telephone: 01202 877511

150a Pinehurst Park, West Moors, Ferndown, Dorset. BH22 0BS



Spacious, Well Presented Park Home

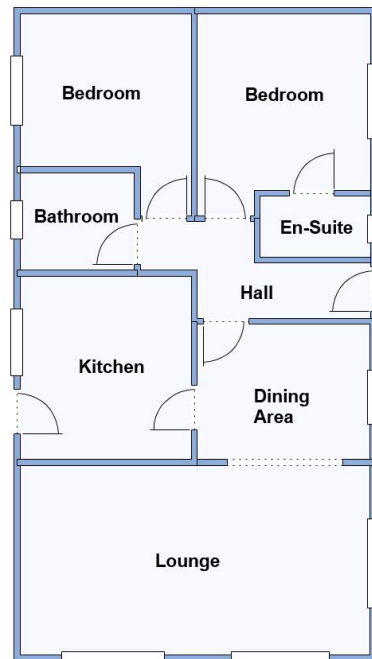

This drawing has been prepared for diagrammatic purpose only. Not to scale

2 Bedroom Park Home approx 36' x 20'

Accommodation & approximate room dimensions:

- Stately Albion 'Special' 2001
- Entrance Hall
- Kitchen: approx 10'2" x 9'6". Range of floor and wall cupboards. Built-in oven & hob with extractor fan over. Space for fridge/freezer & washing machine. Cupboard housing combination gas boiler. Door to rear steps.
- Dining Area: approx 9'7" x 7'6". Bay window. Archway to:
- Lounge: approx 19'4" x 10'7". Feature fireplace. 3-Bay windows.
- Bedroom 1: approx 9'9" x 9'4". Built-in wardrobes and drawer unit.
- En-Suite Shower Room
- Bedroom 2: approx 9'5" x 8'7". Built-in wardrobes .
- Bathroom: Accessible Walk-in bath with mixer tap & shower attachment. Pedestal wash basin & WC.
- Gas Central Heating (system untested)
- PVCu Double-Glazing
- Exterior Cladding System for ease of maintenance.
- Parking on Plot with alterations to ramp.
- Substantial ramp for wheelchair access.
- Age Restriction 45+ Pets Considered
- Popular Residential Park near to local amenities.

Popular 'Pet Friendly' Park



Pitch Fee: approx £235.81 per month including water

Subject to Annual Review

Council Tax Band: 'A'

Tenure: 1983 Mobile Homes Act Agreement

Price £145,000

VIEWING STRICTLY BY APPOINTMENT WITH THE VENDOR'S AGENT Dorset Park Homes 01202 877511

IMPORTANT NOTE: These particulars are believed to be correct but their accuracy is not guaranteed. They do not form part of any contract. Nothing in these particulars shall be deemed to be a statement that the property is in good structural condition or otherwise, nor that any of the services, appliances, equipment or facilities are in good working order or have been tested. Purchasers should satisfy themselves on such matters prior to purchase Ref.W04862

The recommended specialist in Park Home sales
Proprietor: Simon Dixon

