



Tamarisk Way, East Preston

Freehold

A detached three-bedroom coastal home • Private Willowhayne marine estate • Off-road, gated parking with garage for three cars • Beautiful large front and rear gardens • Principal suite with south facing balcony • For more photos visit the Cooper Adams website • Interested in this property? Call us on 01903 770055

Cooper Adams

Set on a generous plot along a peaceful, sea-facing road, this stunning, gated three-bedroom coastal home boasts a sun-drenched balcony with panoramic views of the English Channel, beautifully landscaped gardens, and a triple garage. Located within "The Willowhayne"—one of the South East's most prestigious private marine estates—this exclusive property offers the ultimate blend of coastal and countryside living. With over 3,000 square feet of versatile, contemporary accommodation, this home is the epitome of luxury and tranquillity on the sought-after West Sussex coast.



The sought-after Willowhayne marine estate in East Preston, established in the 1930s, provides privacy and security with gated access on summer weekends. A railway station is just over 1/2 mile away, connecting to Brighton, Gatwick, and London. Many amenities are close to hand with the sea, the downs, golf courses and many shops, bars and restaurants.



Tamarisk Way

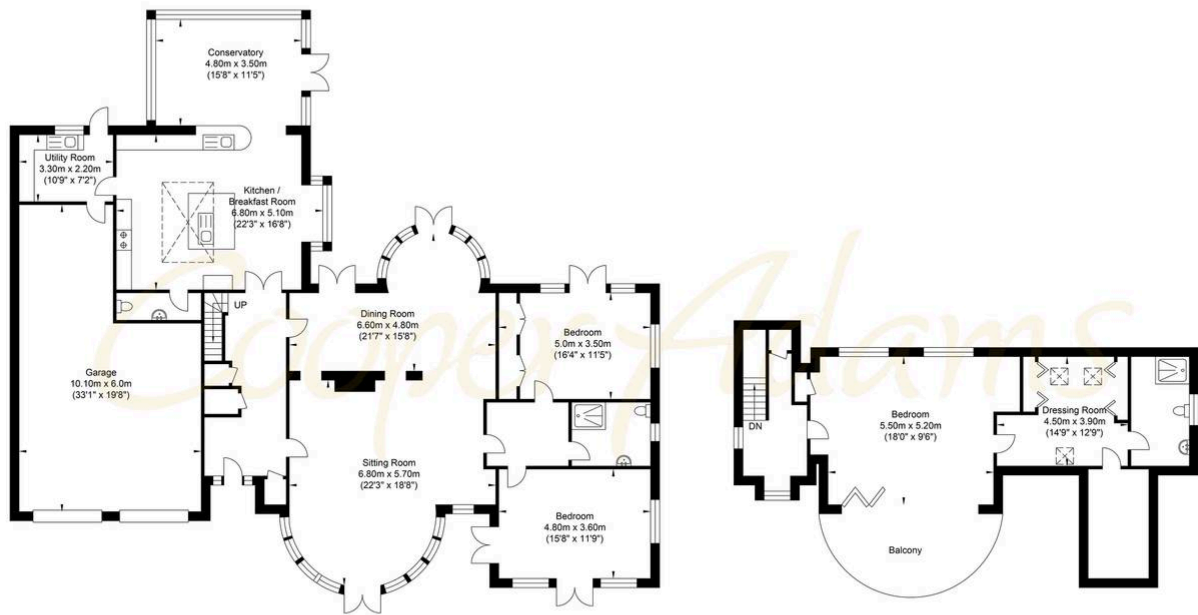

Ground Floor
Approximate Floor Area
2587.96 sq ft
(240.43 sq m)

First Floor
Approximate Floor Area
490.61 sq ft
(45.58 sq m)

Approximate Gross Internal Area = 286.01 sq m / 3078.58 sq ft

Illustration for identification purposes only, measurements are approximate, not to scale.