

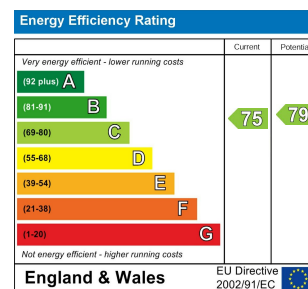

**WAKEFIELD** | **OSSETT** | **HORBURY**  
**01924 291 294** | **01924 266 555** | **01924 260 022**  
**NORMANTON** | **PONTEFRACT & CASTLEFORD**  
**01924 899 870** | **01977 798 844**

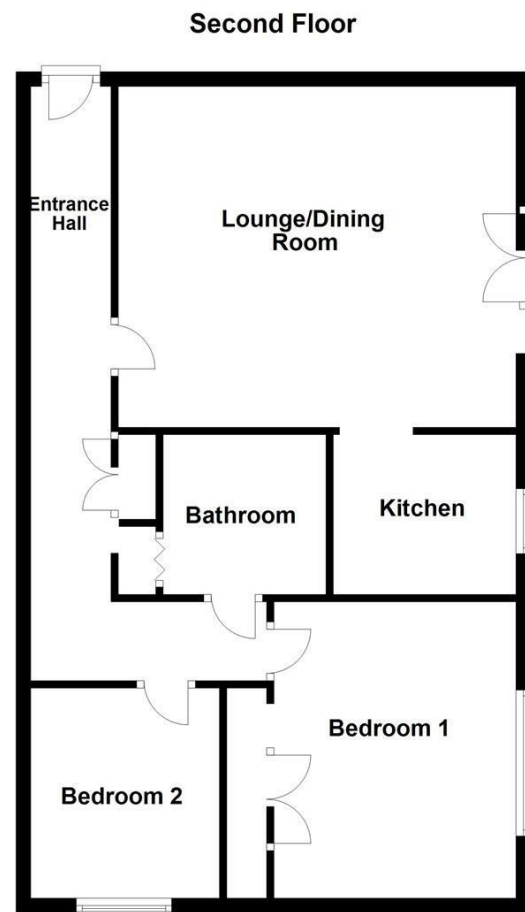

**IMPORTANT NOTE TO PURCHASERS**

We endeavour to make our sales particulars accurate and reliable, however, they do not constitute or form part of an offer or any contract and none is to be relied upon as statements of representation or fact. Any prospective purchasers should take their own measurements to enable them to obtain exact details for the purpose of fitted carpets. Please note that none of the appliances mentioned in our brochures i.e. gas boilers, heaters, cookers, refrigerators etc. have been checked or tested and cannot be guaranteed to be in working order. If you require clarification or further information on any points, please contact us, especially if you are travelling some distance to view. Fixtures and fittings other than those mentioned are to be agreed with the seller.

**MORTGAGES**

Did you know that we have our own specialist mortgage consultants who can provide you with free independent advice and information regarding your house purchase and everything it entails, from budget planning to finding the best mortgage available to you\*

Wakefield office 01924 291294,  
 Pontefract & Castleford office 01977 798844  
 Ossett & Horbury offices 01924 266555  
 and Normanton office 01924 899870.  
 Please ring us to arrange a mortgage advice appointment.

\*your home may be repossessed if you do not keep up repayments on your mortgage

**FREE MARKET APPRAISAL**

If you are thinking of making a move then take advantage of our FREE market appraisals, with the knowledge that we have been selling houses for the people of the WF postcodes for over 50 years.

**PROPERTY ALERTS**

Make sure you keep up to date with all new properties in your price range in the particular area you have in mind by registering your details with us.

**CONVEYANCING**

Richard Kendall Estate Agent is proud to have their own panel of solicitors offering a comprehensive service to our clients requiring Conveyancing services. This service enables Richard Kendall Estate Agent to work hand in hand with our solicitors and our mortgage brokers to ensure the legal process of buying or selling your homes is as seamless as possible.



**46 Constable Drive, Ossett, WF5 8DH**

**For Sale Leasehold Offers In The Region Of £119,950**

An ideal property for the first time buyer, couple or the investor is this two bedroom second floor (top floor) apartment benefiting from UPVC double glazing and electric panel heating.

The accommodation fully comprises communal entrance hall, property entrance hall, lounge/dining room with kitchen off, two bedrooms and the bathroom/w.c. Outside there are communal gardens and off road parking is available.

Situated in a popular part of Ossett, which has good access to the motorway network, local amenities, good school and Ossett town centre has a twice weekly market.

Early viewing comes highly recommended.



#### ACCOMMODATION

#### ENTRANCE HALL

Entrance door, doors to the living/dining room, two bedrooms and bathroom/w.c.

#### LIVING/DINING ROOM

Opening to the kitchen. Juliette balcony and window.



#### KITCHEN

A range of units with work surface over, 1 1/2 sink and drainer, built-under electric oven and hob having extractor hood over, integrated

fridge/freezer and plumbing for an automatic washing machine. Tiled splashback and window.

#### BEDROOM ONE

Window.



#### BEDROOM TWO

Window.



#### BATHROOM/W.C.

Bath, wash basin, w.c. and shower cubicle.



#### OUTSIDE

Allocated parking space.

#### LEASEHOLD

The service charge is £1,309.00 [pa] and ground rent £231.54 [pa]. The remaining term of the lease is 104 years [2024]. A copy of the lease is held on our file at the Ossett office.

#### COUNCIL TAX BAND

The council tax band for this property is A.

#### EPC RATING

To view the full Energy Performance Certificate please call into one of our local offices.

#### FLOOR PLAN

This floor plan is intended as a rough guide only and is not to be intended as an exact representation and should not be scaled. We cannot confirm the accuracy of the measurements or details of this floor plan.

#### VIEWINGS

To view please contact our Ossett office and they will be pleased to arrange a suitable appointment.