



25 Whitworth Avenue, Hinckley, LE10 0DD

£260,000



3



1



1



D



*** SHOW HOME STANDARD AND STYLING *** RH Homes and Property are excited to offer this modern three bedroom semi detached house situated in a popular periphery location of Hinckley Town Centre with good access to local amenities and commuter routes of the A5, M69 & M1/M6. Whilst being right next to the walks and facilities of the Canal and it's beauty spots and walkways. The home comprises an Entrance Hall, Downstairs WC, Lounge, Dining Kitchen, Landing, Three Bedrooms and Family Bathroom. It has been refurbished and redecorated to an impressive standard. A highlight of this property is the parking available for two vehicles to the frontage, and then further double width at the side. There is a good rear gardens. The property also benefits from gas fired central heating and UPVC double glazing throughout.

Council Tax - B

Entrance Hall

With a refitted composite and glazed door to the front elevation. Also with refitted carpets. There is a radiator, and stairs off to the first floor.

Downstairs WC

Having a well presented two piece white suite of low flush WC and a corner wash hand basin with splashbacks set in a vanity unit, radiator and UPVC double glazed window to the front aspect.

Lounge

13'3 x 12'6 overall (4.04m x 3.81m overall)
UPVC double glazed window to the front elevation. With two radiators and refitted carpet, recently repainted, and twin glazed doors through to the Dining Kitchen.

Dining Kitchen

15'8 x 9'0 (4.78m x 2.74m)
Having been aesthetically restyled and offering an excellent range of gloss fronted wall and base units with refitted working surfaces over and NY subway style tiles, there is also a cupboard housing the central heating boiler. There is a one and a half sink and drainer, electric oven and four ring hob with a SMEG hood over, plumbing for a washing machine and space for a tumble dryer, a useful under stairs storage cupboard, radiator, again with stylish flagstone sized tiled flooring, and a UPVC double glazed window and twin UPVC french doors to the rear gardens.





First Floor Landing

UPVC double glazed window to the side elevation, loft access hatch, and airing cupboard. With refitted carpets on the stairs and Landing, and recently redecorated.

Master Bedroom

12'6 x 9'6 to door recess (3.81m x 2.90m to door recess)
UPVC double glazed window to the rear elevation., radiator, refitted carpets, and recently redecorated.

Bedroom Two

9'11 x 6'5 + recess (3.02m x 1.96m + recess)
UPVC double glazed window to the front elevation., radiator, refitted carpets, and recently redecorated.

Bedroom Three

8'7 to rear of robes x 6'9 to door (2.62m to rear of robes x 2.06m to door)
UPVC double glazed window to the front elevation., a range of wardrobes set along one wall, and a recessed store cupboard, plus radiator, refitted carpets, and recently redecorated. (This room could also be used as a Home Office, or nicely designed as a Dressing Room if preferred).



Bathroom

6'9 x 5'6 (2.06m x 1.68m)
Having a refitted three piece white suite comprising a low level WC and wash hand basin set in a vanity unit, and a bath with both handheld and rainfall shower over and screening, with extractor fan, heated towel rail, and ceramic tiled flooring, UPVC double glazed window to the rear aspect.

Outside

The frontage is a mainly block paved parking area, with walkway to the front door and a further parking area/driveway just set to the rear of the plot.



All measurements are approximate and for display purposes only

There is a side timber rear gated access into the gardens. Which have again been recently relandscaped, having a paved patio adjacent to the house leading onto a lawned garden with slate and flower borders, the slate walk way heads to the foot of the garden where there is a further paved seating area and timber shed. The gardens are enclosed by fencing.

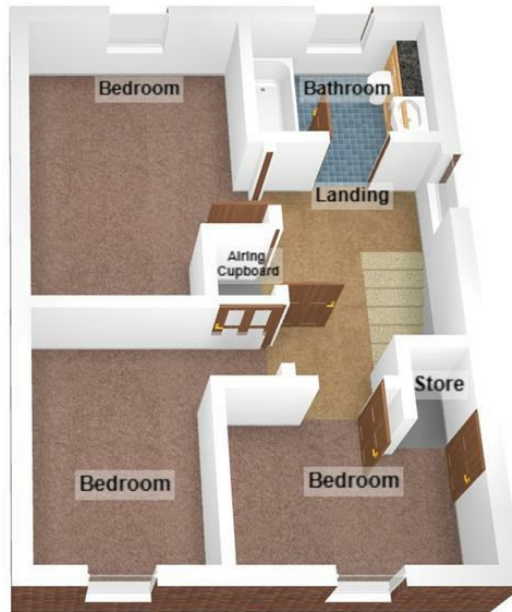

Whitworth Avenue, Hinckley, LE10 0DD

Total Area: 75.0 m² ... 807 ft²

All measurements are approximate and for display purposes only

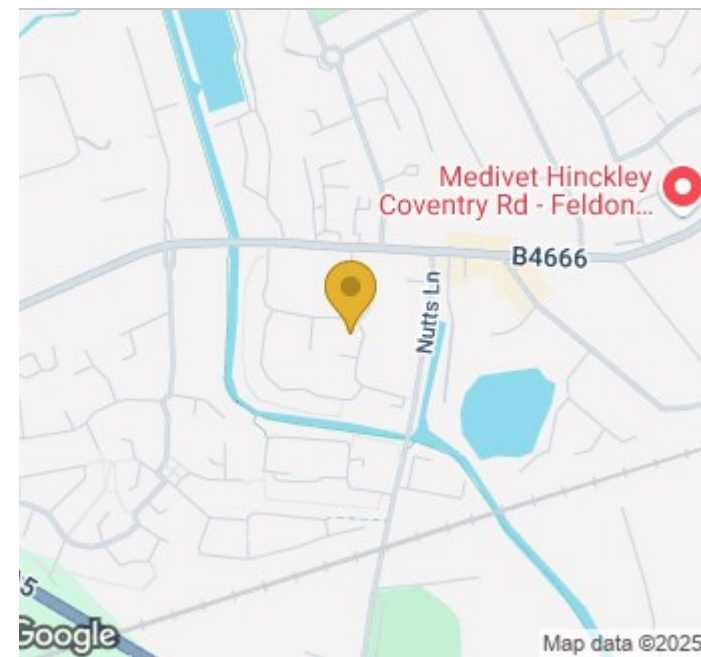

Leaving Hinckley town centre along Coventry Road (Towards the A5), continue along and then turn left into Whitworth Avenue virtually opposite Trinity Marina. Take the first left turning still onto Whitworth Avenue, follow the road around and the property is to the left just prior to the right angled turn in the Road. Easily identified by the RH Homes for sale board. For SATNAV users please enter LE10 0DD

Viewing

Please contact our RH Homes and Property Office on 01455 633244 if you wish to arrange a viewing appointment for this property or require further information.

These particulars, whilst believed to be accurate are set out as a general outline only for guidance and do not constitute any part of an offer or contract. Intending purchasers should not rely on them as statements of representation of fact, but must satisfy themselves by inspection or otherwise as to their accuracy. No person in this firms employment has the authority to make or give any representation or warranty in respect of the property.

Energy Efficiency Rating		
	Current	Potential
Very energy efficient - lower running costs		
(82 plus) A		87
(81-91) B		
(69-80) C		
(55-68) D		
(39-54) E		
(21-38) F		68
(1-20) G		
Not energy efficient - higher running costs		
England & Wales		EU Directive 2002/91/EC

108 Castle Street, Hinckley, Leicestershire, LE10 1DD
 Tel: 01455 633244 Email: rharris@rhhomesandproperty.com
 www.altosoftware.co.uk

