



59 Slate Drive, Hinckley, LE10 2QP
£1,170 Per Calendar Month

 3  2  1  B



RH Homes and property are offering the letting of this well presented modern three bedroom semi detached house on a no through Road, close to the centre of Hinckley and on the periphery of the ever sought after village of Burbage. Situated within close proximity of the excellent A5/M69/M1/M6 commuter routes. The property briefly comprises an Entrance, Downstairs WC, Open plan Lounge/Dining Kitchen, Landing, Three Bedrooms (master with Ensuite), and a Family Bathroom. Also, with a driveway offering off road parking for multiple vehicles, and attractive and easier maintenance front and rear gardens. UPVC double glazing, gas central heating.

Council Tax - C

Entrance Hall

Downstairs WC

Open Plane Lounge/Dining Kitchen

Landing

Bedroom One

Ensuite

Bedroom Two

Bedroom Three

Family Bathroom

Outside





Slate Drive, Burbage, LE10 2QP

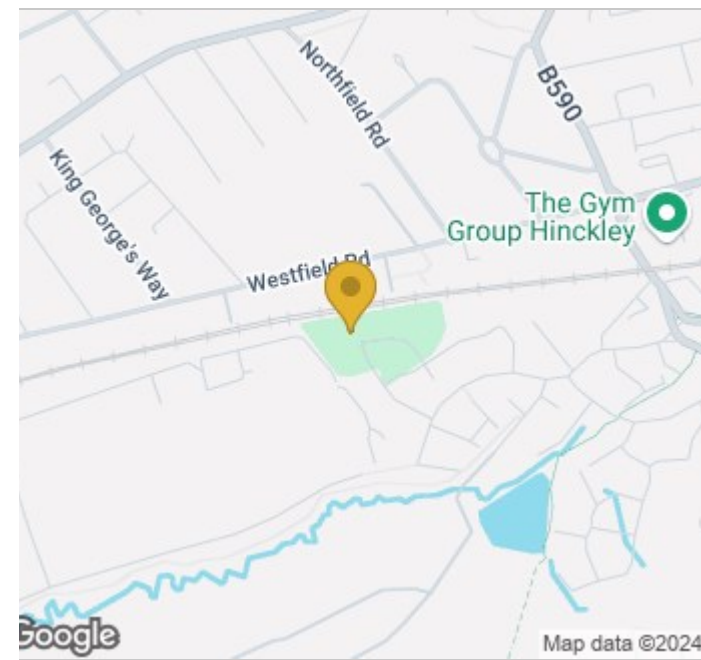
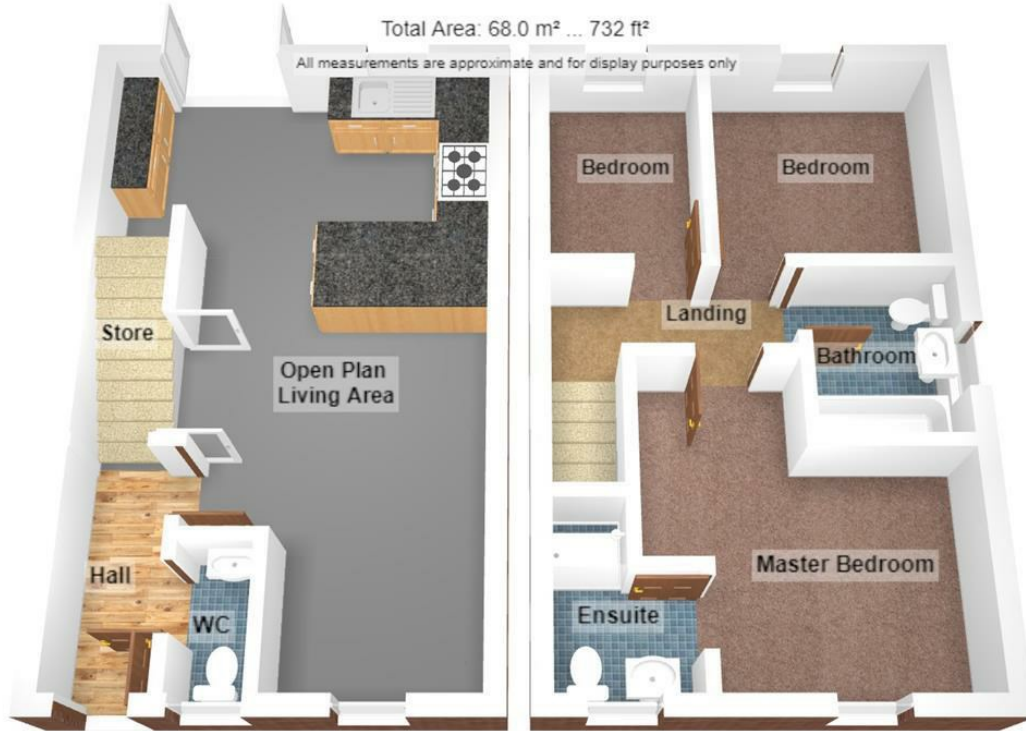

Viewing

Please contact our RH Homes and Property Office on 01455 633244 if you wish to arrange a viewing appointment for this property or require further information.

These particulars, whilst believed to be accurate are set out as a general outline only for guidance and do not constitute any part of an offer or contract. Intending purchasers should not rely on them as statements of representation of fact, but must satisfy themselves by inspection or otherwise as to their accuracy. No person in this firm's employment has the authority to make or give any representation or warranty in respect of the property.

Energy Efficiency Rating		Current	Potential
Very energy efficient - lower running costs			
(82 plus) A			95
(81-91) B		82	
(69-80) C			
(55-68) D			
(39-54) E			
(21-38) F			
(1-20) G			
Not energy efficient - higher running costs			
England & Wales		EU Directive 2002/91/EC	

108 Castle Street, Hinckley, Leicestershire, LE10 1DD
 Tel: 01455 633244 Email: rharris@rhhomesandproperty.com
 www.altosoftware.co.uk

