

29 Forest Road, Hinckley, LE10 1HA

Offers Over £65,000

 3
  1
  1
  D



29 Forest Road, Hinckley, LE10 1HA

*** The subject SINGLE BUILD PLOT is offered for sale by informal tender, and offers in writing must be received by 12 noon on Friday 18th October 2024 at the RH Homes And Property Ltd Offices at 108 Castle Street, Hinckley, LE10 1DD ***

SINGLE BUILD PLOT for a three bedroom detached house in Hinckley.

Planning consent has been granted by Hinckley and Bosworth Borough Council for the opportunity to build a dwelling in the siting of the current garage - 23/01128/FUL

For full details and documents please visit - https://publicdocuments.hinckley-bosworth.gov.uk/PublicAccess_Live//SearchResult/RunThirdPartySearch?FileSystemId=PL&FOLDER1_REF=23/01128/FUL

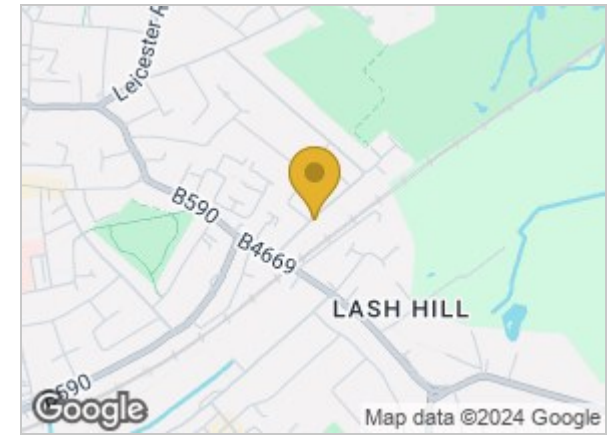

Full Planning Permission

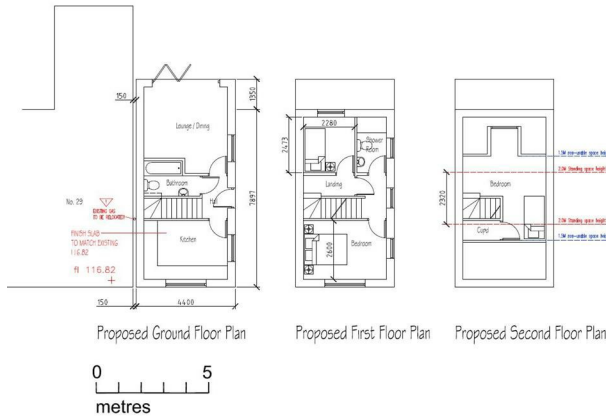

Energy Efficiency Rating		Environmental Impact (CO ₂) Rating				
	Current	Potential		Current	Potential	
Very energy efficient - lower running costs				Very environmentally friendly - lower CO ₂ emissions		
(92 plus) A			84	(81-91) A		
(81-91) B				(69-80) B		
(69-80) C				(55-68) C		
(55-68) D		64		(39-54) D		
(39-54) E				(21-38) E		
(21-38) F				(1-20) F		
(1-20) G				Not environmentally friendly - higher CO ₂ emissions		
Not energy efficient - higher running costs				England & Wales	EU Directive 2002/91/EC	EU Directive 2002/91/EC

These particulars, whilst believed to be accurate are set out as a general outline only for guidance and do not constitute any part of an offer or contract. Intending purchasers should not rely on them as statements of representation of fact, but must satisfy themselves by inspection or otherwise as to their accuracy. No person in this firm's employment has the authority to make or give any representation or warranty in respect of the property.

108 Castle Street, Hinckley, Leicestershire, LE10 1DD
 T. 01455 633244 | E. rharris@rhhomesandproperty.com
 www.rhhomesandproperty.com