



## 14 BELVEDERE COURT

ALWOODLEY, LS17 8NF

£699,950  
FREEHOLD

This outstanding family home offers an excellent opportunity for buyers looking for a spacious and stylish residence in the highly sought-after area of Alwoodley. With four generously sized bedrooms and two reception rooms. The property delivers the perfect blend of comfort and sophistication.

MONROE

SELLERS OF THE FINEST HOMES



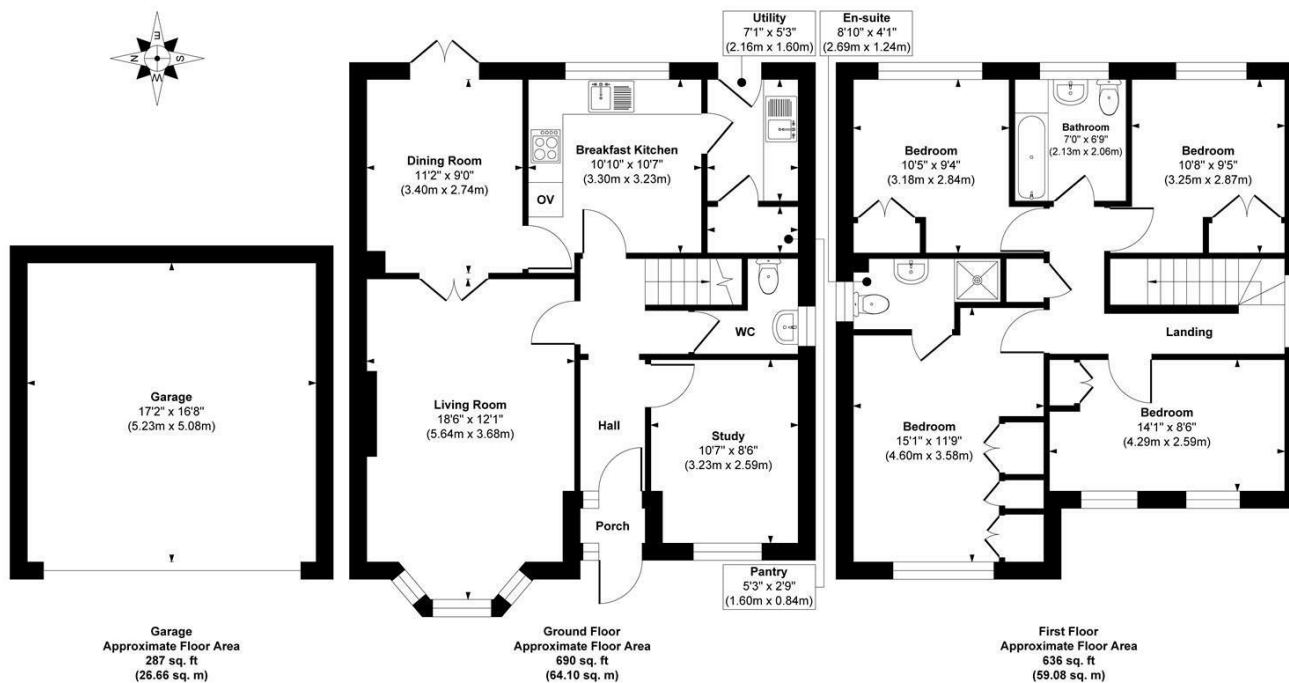

**Approx. Gross Internal Floor Area 1613 sq. ft / 149.84 sq. m (Including Garage)**

Illustration for identification purposes only, measurements are approximate, not to scale.

Copyright © Show Home.

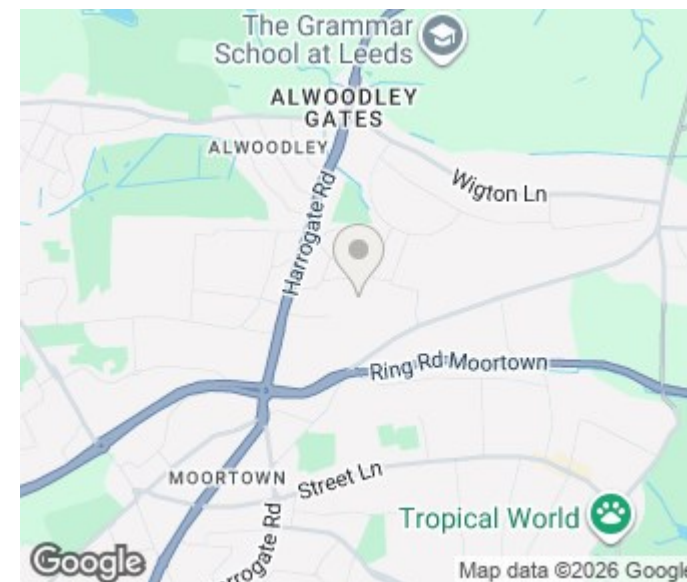

Energy Efficiency Rating		
	Current	Potential
Very energy efficient - lower running costs		
(92 plus) <b>A</b>		
(81-91) <b>B</b>		
(69-80) <b>C</b>		
(55-68) <b>D</b>		
(39-54) <b>E</b>		
(21-38) <b>F</b>		
(1-20) <b>G</b>		
Not energy efficient - higher running costs		
<b>England &amp; Wales</b>	EU Directive 2002/91/EC	

Agents Note: Whilst every care has been taken to prepare these particulars, they are for guidance purposes only. All measurements are approximate and are for general guidance purposes only and whilst every care has been taken to ensure their accuracy, they should not be relied upon and potential buyers/tenants are advised to recheck the measurements

Alwoodley Sales  
716 King Lane Alwoodley  
Leeds  
West Yorkshire  
LS17 7BA

0113 870 4443  
hello@monroeestateagents.com  
www.monroeestateagents.com

MONROE

SELLERS OF THE FINEST HOMES