



2 BARDON HALL MEWS

LEEDS, LS16 5TY

£275,000
LEASEHOLD

Welcome to 2 Bardon Hall Mews, a stunning Grade II listed mid-terrace home situated in the picturesque Bardon Hall Estate.

MONROE

SELLERS OF THE FINEST HOMES

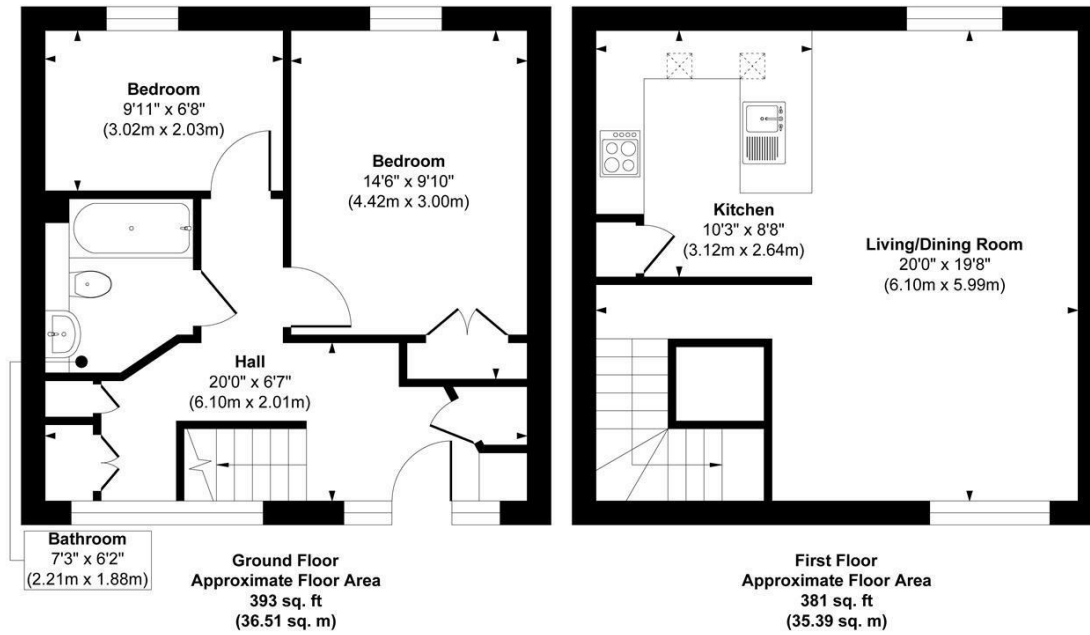

Approx. Gross Internal Floor Area 774 sq. ft / 71.90 sq. m

Illustration for identification purposes only, measurements are approximate, not to scale.
Copyright © Zenith Creations.

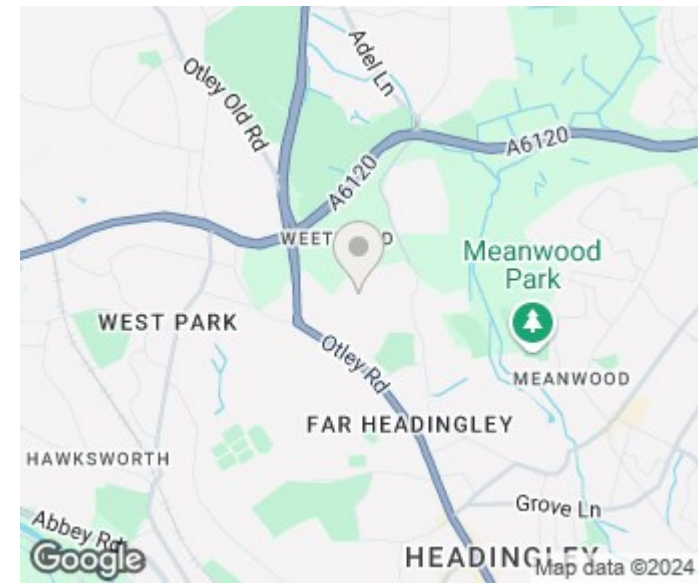

Energy Efficiency Rating		Current	Potential
<small>Very energy efficient - lower running costs</small>			
(92 plus) A			
(81-91) B			
(69-80) C			
(55-68) D			
(39-54) E			
(21-38) F			
(1-20) G			
<small>Not energy efficient - higher running costs</small>			
England & Wales			
		EU Directive 2002/91/EC	

Agents Note: Whilst every care has been taken to prepare these particulars, they are for guidance purposes only. All measurements are approximate and are for general guidance purposes only and whilst every care has been taken to ensure their accuracy, they should not be relied upon and potential buyers/tenants are advised to recheck the measurements

Alwoodley Sales
1-3 The Avenue
Alwoodley
Leeds
West Yorkshire
LS17 7BD

0113 870 4443
hello@monroestateagents.com
www.monroestateagents.com

MONROE

SELLERS OF THE FINEST HOMES